

CONTROL POINTS					
PT. #	N	E	ELEV.	OFFSET	NAME
CP-S1	516031.1133	1431474.8454	494.61	721+42.34/100.37'	MAGNETIC NAIL AND DISK
CP-S6	515266.6908	1431744.3829	488.05	713+19.10/-17.78'	60d SPIKE
CP-S48	515776.8261	1431440.4352	495.38	719+10.67/-21.10'	TDOT 86-13-48
CP-S49	516244.5174	1431295.3533	493.45	723+94.82/-29.29'	TDOT 86-13-49

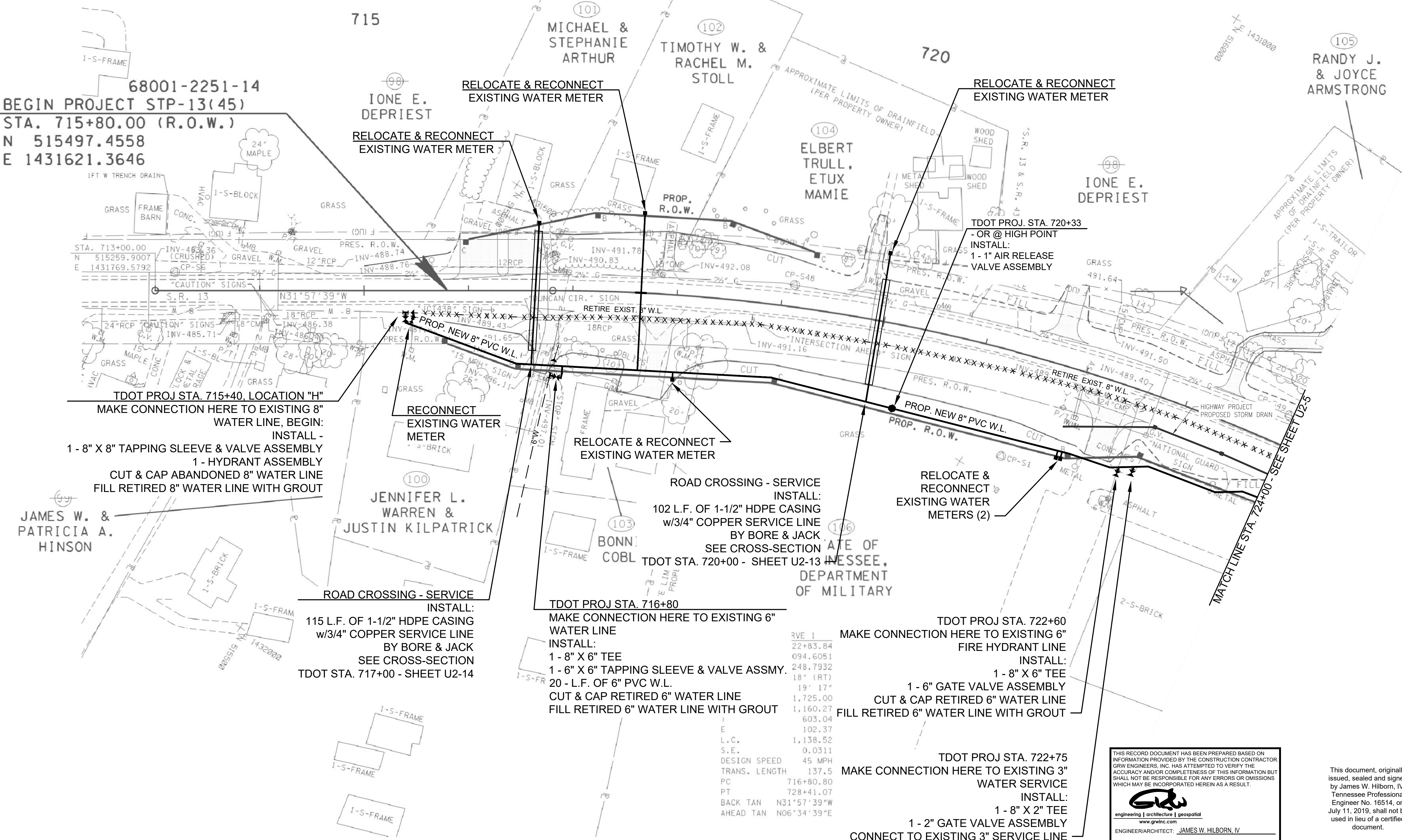

03-03-14: UPDATED PROP. R.O.W., ADDED PRES. & PROP. R.O.W. AND PROP. CONST. EASEMENT FROM STA. 722+05.00, OFFSET 85.00' RT. TO STA. 725+00.00, OFFSET 85.00' RT.

07-11-14: UPDATED TRACT NOS. 102, 105 AND 106 PROPERTY OWNER NAMES.

04-15-15: REMOVED PROP. CONST. EASEMENT AND PRES. & PROP. R.O.W. FROM TRACT NO. 106 AND ADDED PROP. R.O.W. FROM STA. 722+05.00, OFFSET 85.00' RT. TO STA. 725+00.00, OFFSET 85.00' RT. MOVED TRACT NO. 105 DRIVEWAY FROM S.R. 438 STA. 7023+58 RT. TO S.R. 13 STA. 723+40 LT.

08-24-16: UPDATED TRACT NO. 100 PROPERTY OWNER NAME. ADJUSTED SLOPE LINE OF DRIVEWAY STA. 717+85 RT. ADDED NATIONAL GUARD SIGN AT STA. 723+67.09, OFFSET 55.24' RT.

12-12-16: MOVED TRACT NO. 105 DRIVEWAY FROM STA. 723+40 TO STA. 723+35 LT.

TYPE	YEAR	PROJECT NO.	SHEET NO.
CONST.	2020	68001-3251-14	U2-4

S.R. 13 PERRY CO.

DRAWING SCALE CHECK: THIS MARK SHOULD MEASURE EXACTLY 1" WHEN PLOTTED	
ALL RIGHTS RESERVED: THIS DOCUMENT IS THE PROPERTY OF GRW ENGINEERS, INC. AND SHALL NOT BE REPRODUCED IN WHOLE OR IN PART OR USED FOR CONSTRUCTION OF OTHER THAN THIS SPECIFIC PROJECT WITHOUT WRITTEN PERMISSION OF GRW ENGINEERS, INC.	
DESIGNED: JWH	DATE: JULY 2019
DRAWN: DM	REVISION DATE:
REVIEWED: JWH	SCALE: 1" = 50'
APPROVED: JWH	PROJECT NO. 3827-09

engineering | architecture | geospatial

www.grwinc.com



CITY OF LOBELVILLE
S.R. 13 WATER RELOCATIONS

WATER RELOCATIONS
STA. 715+40 TO 724+00

SCALE: 1" = 50'