

9. All erosion control measures utilized within State of Tennessee ROW's shall meet or exceed the TDOT requirements.

4. INSTALL 20 L.F. OF 10" STEEL CASING
PIPE (MIN. WALL THK. 0.25") W / 4"
PVC CARRIER.
BY BORE & JACK METHOD.

2. ALL WATERLINES SHALL BE PVC SDR 21 WITH DUCTILE IRON FITTINGS.

29 TONY THOMPSON
30 EVELYN BUTTETT
31 KENNETH LENTZ
32 JOHN FLAUGER
33 MIKE HARRISON
34 ROY BIDDY
35 LEAMAN CHANDLER
36 ANNIE HOWARD
37 JOANNA GOAD
47 PAMELA RICHARDSON
49 DWIGHT GROVES
50 JETETTA HORD
51 DAVID BRADY
52 PATRICIA HARDISON
53 MICHAEL HENRY
54 STEVEN McDONAUGH
55 MONTEZ CARTER
56 HILDA PRESCOTT
57 CAROL FUSION
58 ROBERT PEMBERTON
59 MARVIN BRADY
60 WILLIAM STEWART
61 WILLIAM STEWART
62 WILLIAM STEWART
63 MILTON PETTY
64 JEAN WARREN
65 MIKE PASCHALL
66 ROBERT BULLION
67 CRAIG FUSION
68 CHARLES ROLEN
69 ELDON BROWN
70 JOE OWENS
71 PAUL DUGGER
72 SUSAN DEEVERS
73 MISHA LASHLEE
75 JAMES MCGEE
76 WAYNE DAVIS
77 WESLEY GRAY
78 KAREN HUGHES
79 JEFF GOTTSCHALL
80 SUSAN PEARCE
81 JOEL BRADY
82 JERRY BRADY

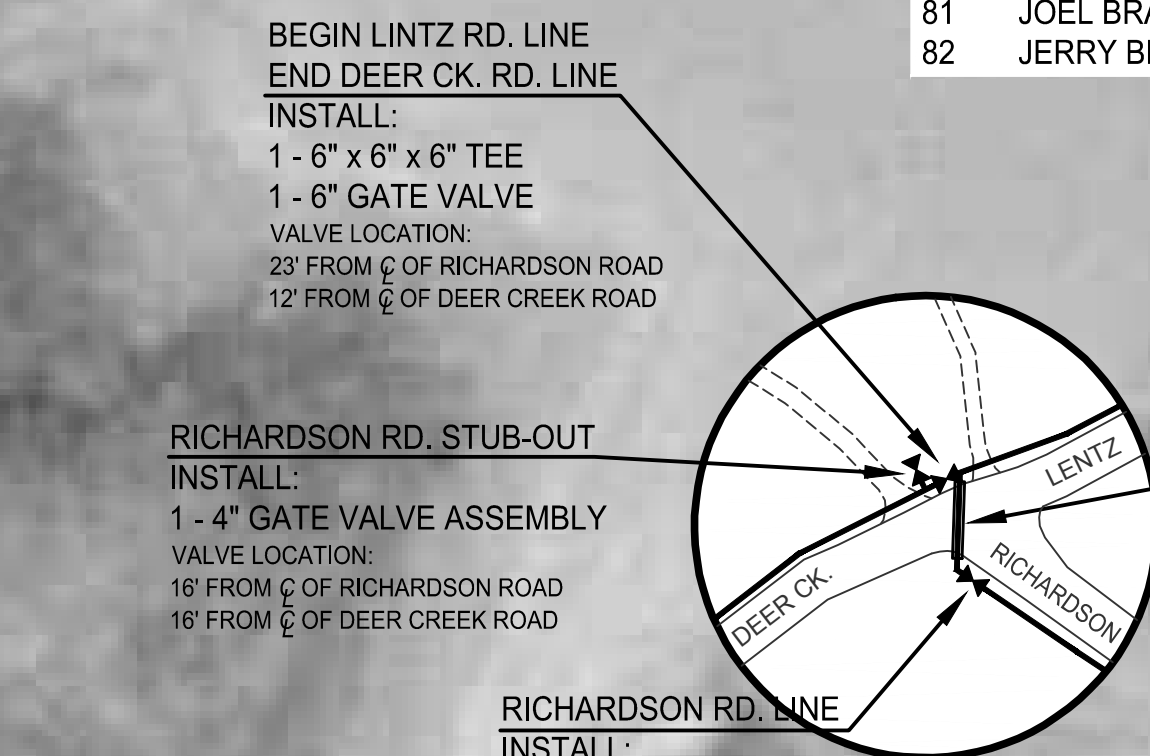

**RICHARDSON RD. STUB-OUT
INSTALL:
1 - 4" GATE VALVE ASSEMBLY
VALVE LOCATION:
16' FROM C OF RICHARDSON ROAD
16' FROM C OF DEER CREEK ROAD**

RICHARDSON RD. LINE
INSTALL:
1 - 6" GATE VALVE ASSEMBLY
VALVE LOCATION:
10' FROM C OF RICHARDSON ROAD
25' FROM C OF DEER CREEK ROAD

LAY W.L. IN CHIP & SEAL
SURFACE AT EDGE OF
CONC. DR. (25 L.F.)

END
COTTAGE CIR. LINE
TIE IN TO NEW 6" D.C.
BOAT DOCK RD. LINE

ROAD CROSSING
SEE NOTE 1

END
DEER CK. BOAT DOCK RD. LINE
INSTALL:
1 - 4" BLOW OFF ASSEMBLY
B.O. - 17' FROM C OF DEER CK. BOAT DOCK RD
84' FROM C OF COTTAGE CIR.

DEER CK. BOAT DOCK RD. LINE
INSTALL:
 1 - 6" x 6" x 6" TEE
 1 - 6" GATE VALVE ASSEMBLY
 VALVE LOCATION:
 26' FROM C OF DEER CK. BOAT DOCK RD
 13' FROM C OF COTTAGE CIR.

D.C. BOAT DOCK RD. STUB-OUT
INSTALL:
 1 - 6" x 6" TEE
 1 - 6" GATE VALVE-CLOSED
 (FOR FUTURE USE)
 VALVE BURIED WITHOUT LID FOR
 VALVE LOCATION:
 13' FROM C OF DEER CREEK ROAD
 14' FROM C OF DEER CREEK BOAT
 DOCK ROAD

LINTZ RD. LINE
INSTALL:
1 - 6" GATE VALVE ASSEMBLY
VALVE LOCATION:
12' FROM C OF LINTZ ROAD
32' FROM C OF TOM RD. #3

BEGIN
TOM RD. #3 LINE
INSTALL:
1 - 6" x 6" x 4" TEE
1 - 4" GATE VALVE
VALVE LOCATION:
12' FROM C OF LENTZ ROAD
11' FROM C OF TOM ROAD

ROAD CROSSING
SEE NOTE 2
END
FROM RD. #3 LINE
TIE IN TO LINTZ RD LINE
INSTALL:
- 6" x 6" x 4" TEE

CROSSING
SITE 2

ING

BEGIN
COTTAGE CIR. LINE
INSTALL:
1 - 6" x 6" x 4" TEE
1 - 4" GATE VALVE
VALVE LOCATION:
17' FROM C OF DEER CREEK RD
14' FROM C OF COTTAGE CIR.

INSTALL:
1 6" x 6" x 4" TEE
1 - 4" GATE VALVE ASSEMBLY
VALVE LOCATION:
15' FROM C OF RICHARDSON RD.
8' FROM C OF UNNAMED ROAD

ROAD CROSSING
SEE NOTE 3

RICHARDSON DR. LINE
STALL:
6" GATE VALVE
SEMBLY
VALVE LOCATION:
FROM INTERSECTION
FROM C OF RICHARDSON DR.

HIGH POINT
INSTALL:
- AIR RELEASE VALVE ASSEMBLY

THIS RECORD DOCUMENT HAS BEEN PREPARED BASED ON INFORMATION PROVIDED BY THE CONSTRUCTION CONTRACTOR, GRU ENGINEERS, INC. HAS ATTEMPTED TO VERIFY THE ACCURACY AND/OR COMPLETENESS OF THIS INFORMATION BUT SHALL NOT BE RESPONSIBLE FOR ANY ERRORS OR OMISSIONS WHICH MAY BE INCORPORATED HEREIN AS A RESULT.

engineering | architecture | geospatial
www.gruinc.com

ENGINEER/ARCHITECT: JAMES W. HILBORN

CONSTRUCTION COMPANY: WARD CONSTRUCTION

DATE: MAY 5, 2014

IT IS THE CONTRACTORS RESPONSIBILITY TO CONTACT UTILITY COMPANIES PRIOR TO ANY CONSTRUCTION. THE LOCATION OF UTILITIES SHOWN ON THESE PLANS ARE APPROXIMATE AND POSSIBLY INCOMPLETE, THEREFORE CERTIFICATION TO THE LOCATION OF ALL UNDERGROUND UTILITIES IS WITHHELD.



TENNESSEE ONE CALL SYSTEM
 IN
 TENNESSEE
 CALL
 1 - 800 - 351-1111
 FREE WORKING DAYS BEFORE YOU DIG

This document, originally issued, sealed, and signed by James W. Hilborn, Kentucky Professional Engineer, No. 16514, on March 14, 2011, shall not be used in lieu of a certified document.

GRW PROJECT NO. 3827-02

ALL RIGHTS RESERVED;
THIS DOCUMENT IS THE PROPERTY OF
HARVEY ENGINEERS, INC. AND SHALL NOT
BE REPRODUCED IN WHOLE OR IN PART
FOR USE FOR CONSTRUCTION OF
OTHER THAN THIS SPECIFIC PROJECT

ENGINEERS - ARCHITECTS - PLANNERS

WATER LINE EXTENSION

REVISIONS			REVIEWED:	LER
NO	DESCRIPTION	DATE	BY	
				DRAWN:
				SG
				REVIEWED:
				LER
				APPROVED:

THIS DRAWING IS THE PROPERTY OF THE COMPANY AND IS NOT TO BE REPRODUCED OR COPIED IN ANY MANNER WITHOUT THE WRITTEN PERMISSION OF THE COMPANY.

THIS MARK SHEET IS MEASURED FACTORY (X) MEASURED OTHER ()

DATE:

JULY 2010

SCALE:

AS NOTED

SHEET NO.

1

C-06

PRINTED: 5/15/2014 @ 4:59PM

FILE NAME: I:\3827-Lobelville\02-Deer Creek\Working Drawings\Deer Creek\RECORD Dwg\3827-C-03thruC-09.dwg

MATCH SEE SHEET C-07