

- 1 ELECTRICAL POWER, SERVICE AND CONTROL PANELS SHALL BE WALL MOUNTED ON SUPPORT CHANNEL AND TO MEET NEC 110-26 REQUIREMENTS EACH PANEL SHALL HAVE A COMPLETELY UNOBSTRUCTED 36" ACCESS AREA IN FRONT OF THE PANEL; SUCH AREA TO EXTEND FLOOR TO CEILING.
- 2 OPENING LOCATIONS ARE TYPICAL. CONTRACTOR IS TO CONFIRM ACTUAL SIZE AND LOCATION WITH BOOSTER STATION MANUFACTURER.

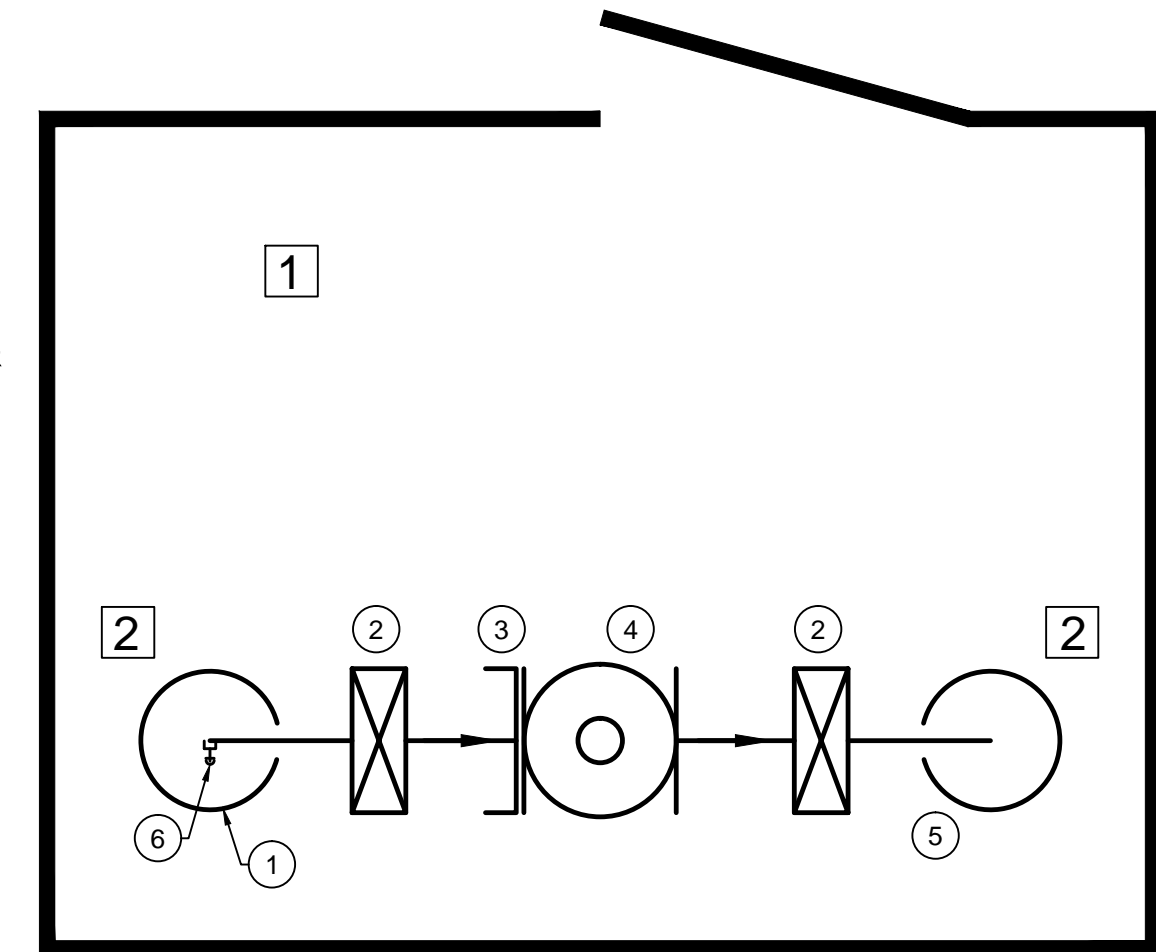

LEGEND	
1)	6" MAIN INLET
2)	6" BUTTERFLY VALVE
3)	6" FLANGED COUPLING ADAPTER
4)	6" CONTROL VALVE
5)	6" MAIN OUTLET
6)	HOSE BIBB

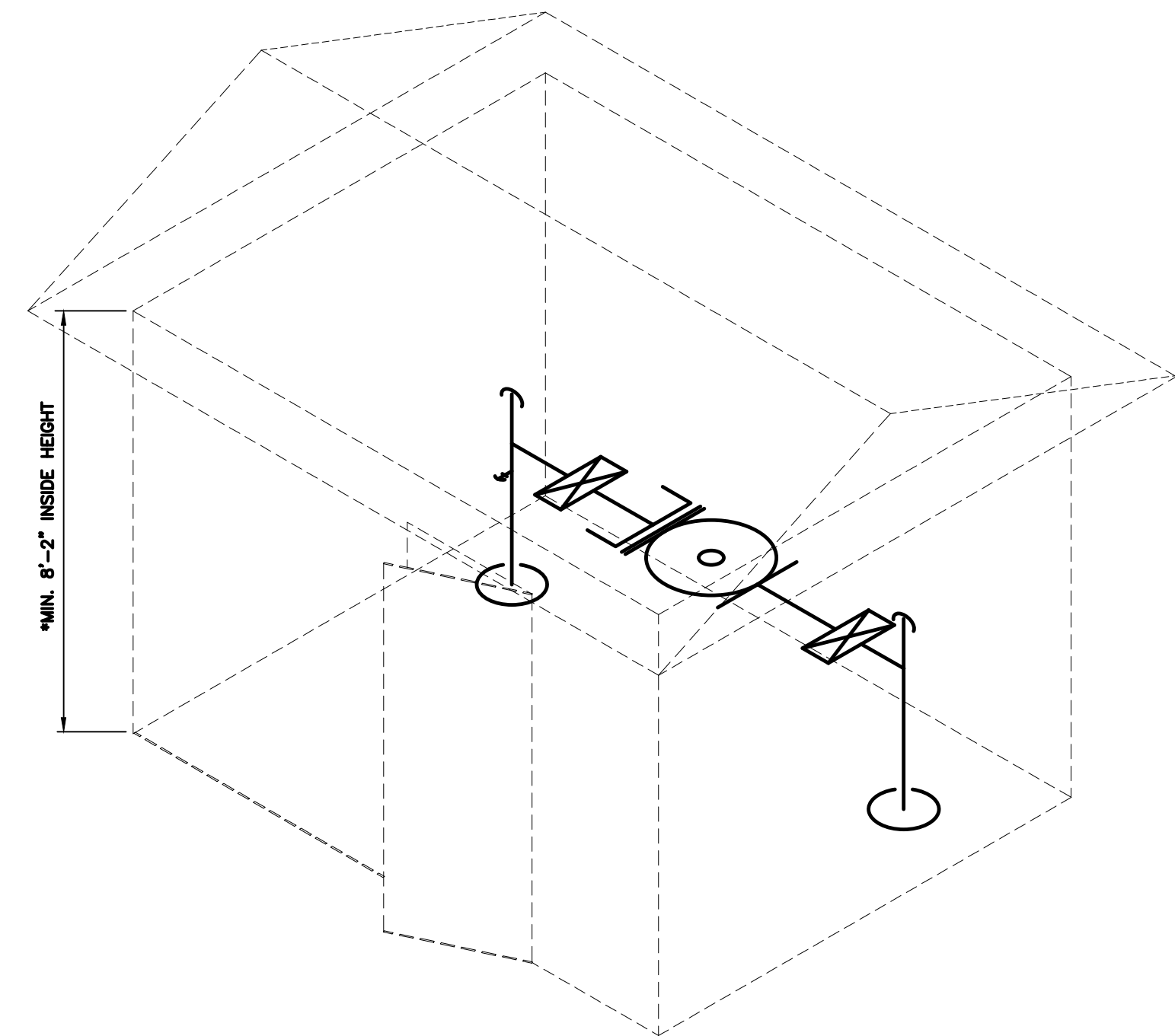

THIS RECORD DOCUMENT HAS BEEN PREPARED BASED ON INFORMATION PROVIDED BY THE CONSTRUCTION CONTRACTOR. GRW ENGINEERS, INC. HAS ATTEMPTED TO VERIFY THE ACCURACY AND/OR COMPLETENESS OF THIS INFORMATION BUT SHALL NOT BE RESPONSIBLE FOR ANY ERRORS OR OMISSIONS WHICH MAY BE INCORPORATED HEREIN AS A RESULT.

GRW
ENGINEERS - ARCHITECTS - PLANNERS
www.grwinc.com
ENGINEER/ARCHITECT: CRAIG FARRELL
CONSTRUCTION COMPANY: ENGINEERED FLUID, INC.
DATE: 9/2014

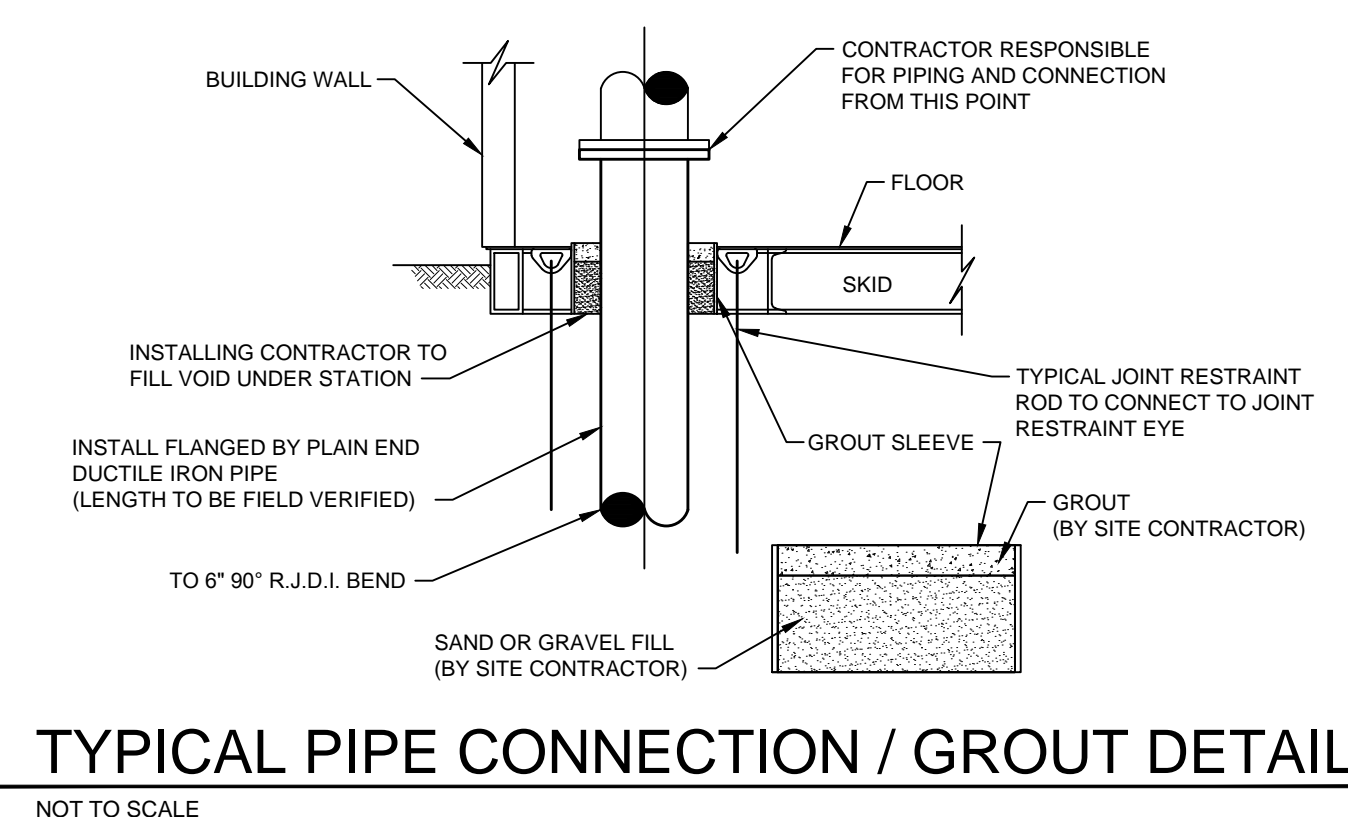
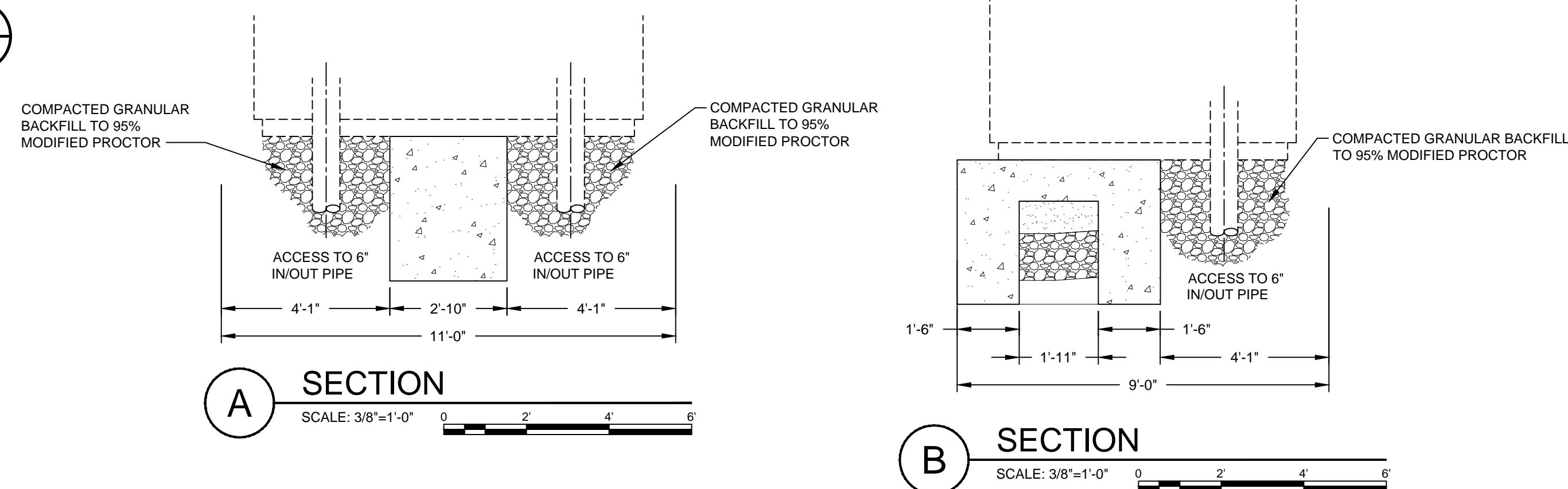
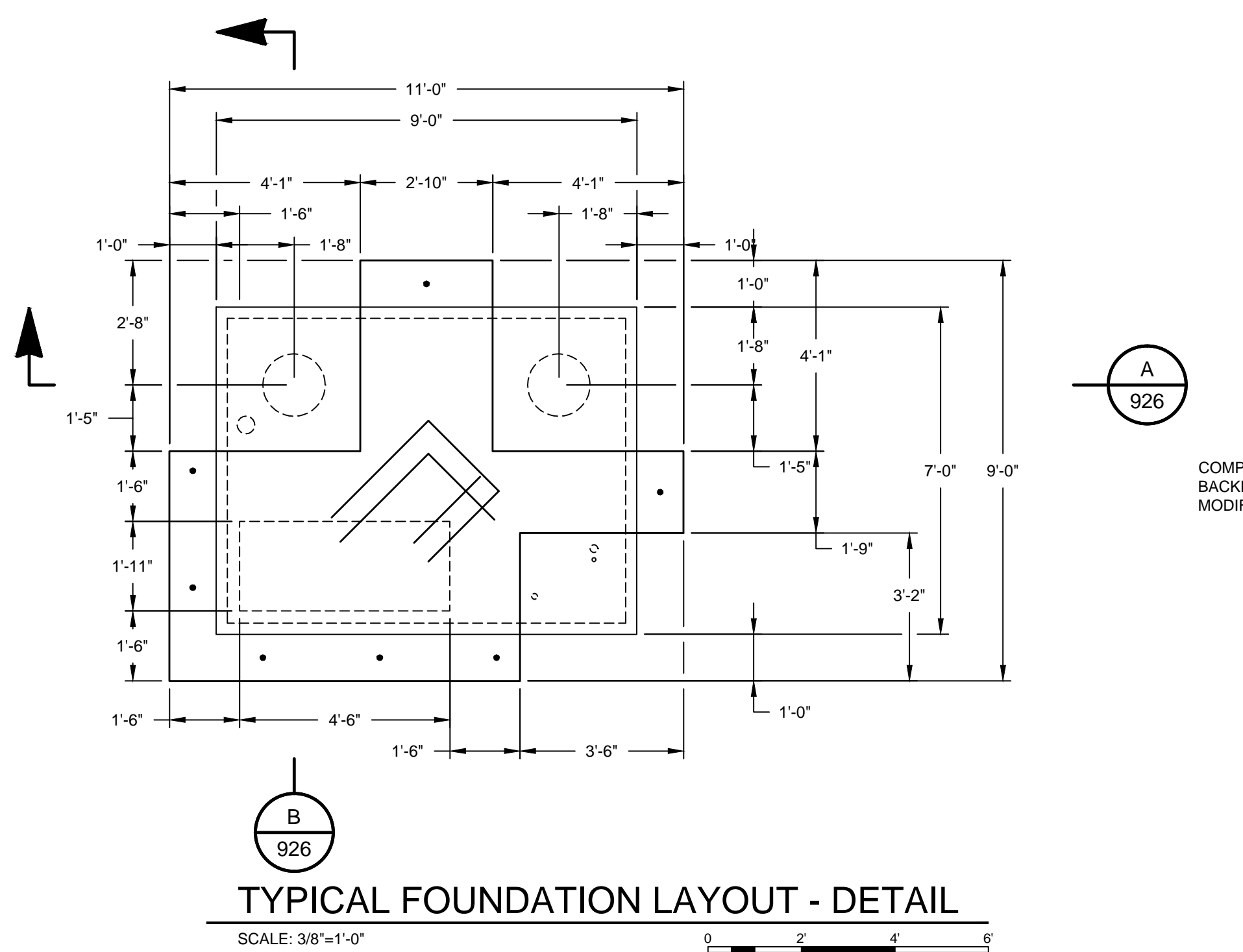

- NOTES
1. THE ENTIRE FOUNDATION SHALL BE POURED IN ONE CONTINUOUS POUR (TURN DOWN SLAB, FOUNDATION PAD AND BEAMS.) CONCRETE STRENGTH SHALL BE HIGH-EARLY 4000 PSI.
 2. FOUNDATION DRAINS AND ELECTRICAL CONDUITS SHALL BE INSTALLED PRIOR TO POURING CONCRETE FOUNDATION. BACKFILL PER NOTE 3.
 3. ALL DISTURBED AREA & EXCAVATIONS FROM SITE DEMOLITION SHALL BE BACKFILLED WITH COMPACTED GRANULAR BACKFILL 0DOT #304 STONE IN 8" LIFTS TO 95% MODIFIED PROCTOR.

This document, originally issued, sealed, and signed by Daniel R. Cutshaw, Indiana Professional Engineer, No. 11200431, on April 19, 2013, shall not be used in lieu of a certified document.

GRW PROJECT NO. 3916-08

CLIENT CONTRACT NO H-1

ALL RIGHTS RESERVED. NO PART OF THIS DOCUMENT SHALL BE REPRODUCED IN WHOLE OR IN PART WITHOUT THE WRITTEN PERMISSION OF GRW ENGINEERS, INC. AND SHALL NOT BE USED FOR ANY OTHER PROJECT OTHER THAN THIS SPECIFIC PROJECT WITHOUT THE WRITTEN PERMISSION OF GRW ENGINEERS, INC.



ENGINEERS - ARCHITECTS - PLANNERS
www.grwinc.com

HOLTON TANK SITE PLAN - ADD ALT. #2 ALTITUDE VALVE
CONTRACT H-1 - U.S. 421 P.S. & TELEMTRY
DIVISION H - WATERWORKS SYSTEM IMPROVEMENTS
HOOSIER HILLS REGIONAL WATER DISTRICT
RIPLEY COUNTY, INDIANA

DESIGNED: ALW
DRAWN: JEC
REVIEWED: C/JF
APPROVED: DRC

REVISIONS		DATE	BY	DESCRIPTION
NO.	DATE	BY	DESCRIPTION	
1.	9/2014	JEC	AS-BUILT REVISION	

DATE: APRIL 2013

SCALE: AS NOTED

SHEET NO.