

I:\2745\dwg\SIMS - IDEM Elec Submittal\FINAL SET NO.3 July 3, 2002 Set of Dwg and Specs\FINAL F1 ELEC DWGS\F1AS-BUILT DRAWINGS\F1-E3_REVISED.dwg, 11/15/2004 2:03:02 PM

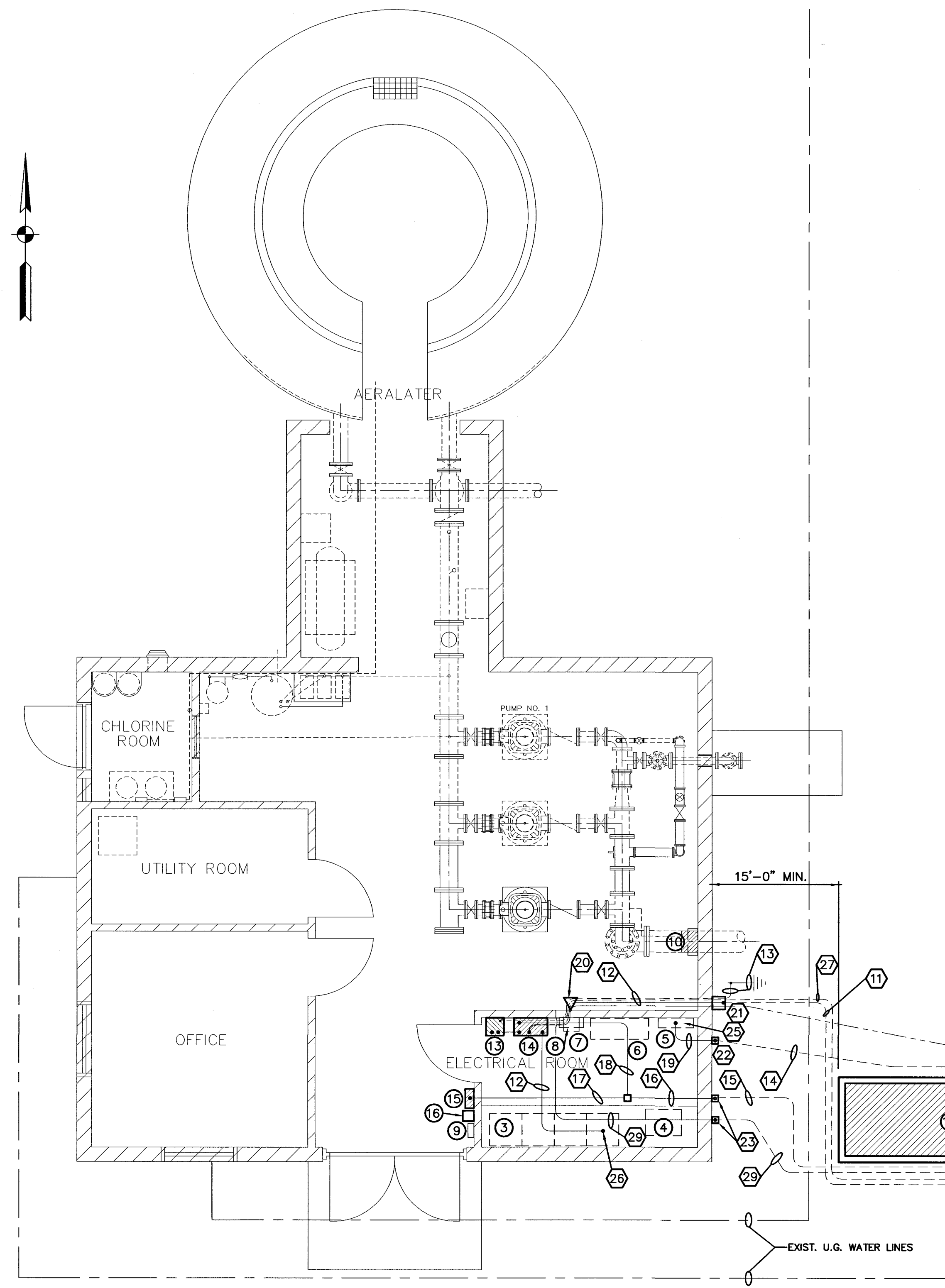

WATER TREATMENT PLANT
ELECTRICAL NEW WORK PLAN
SCALE: 1/4" = 1'-0"

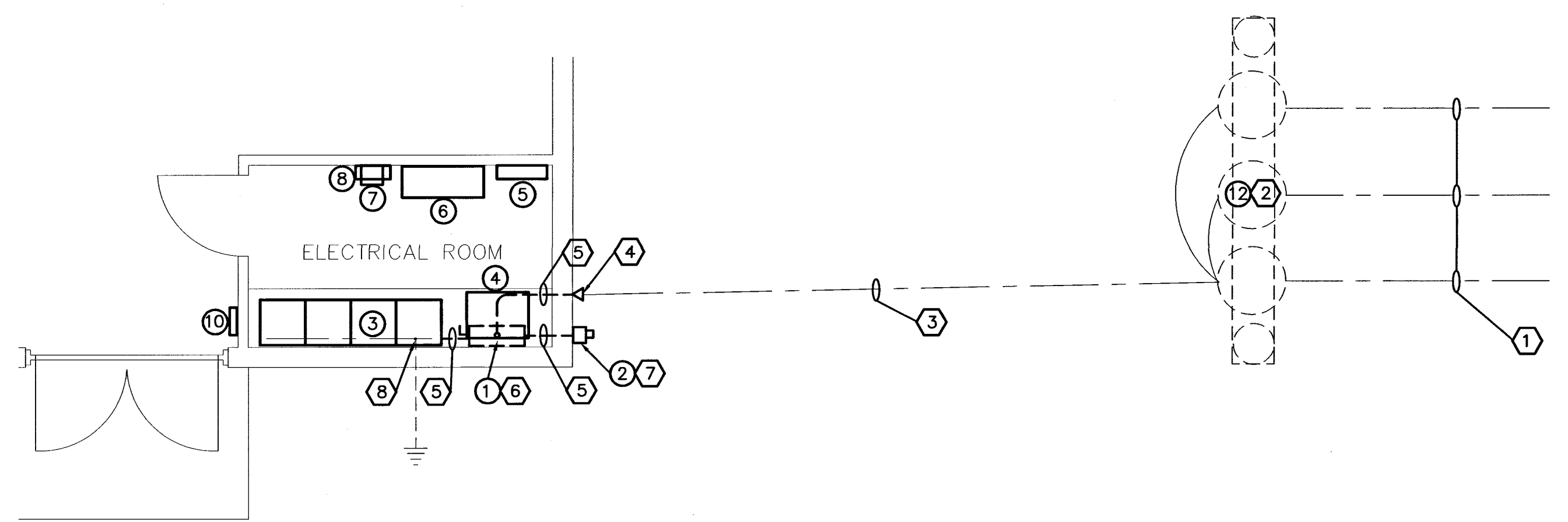

WATER TREATMENT PLANT
ELECTRICAL DEMOLITION PLAN
SCALE: 1/4" = 1'-0"

EQUIPMENT KEYNOTES:

- ① EXIST. MANUAL TRANSFER SWITCH
- ② EXIST. GENERATOR RECEPTACLE
- ③ EXIST. MOTOR CONTROL CENTER
- ④ EXIST. DRY TYPE TRANSFORMER
- ⑤ EXIST. PANEL "LP"
- ⑥ I&C PANEL
- ⑦ EXIST. EXTERIOR LIGHTING TIME CLOCK
- ⑧ EXIST. F.A. CONTROL PANEL
- ⑨ EXIST. DOOR SECURITY KEY PAD
- ⑩ EXIST. CHLORINE ANALYZER
- ⑪ EXIST. UTILITY (3) TRANSFORMER BANK AND SUPPORT STRUCTURE
- ⑫ NEW EMERGENCY ENGINE/GENERATOR, 250KW, 480V., 3PH., 3W. WITH EXTERIOR HOUSING, 500 GALLON SKID MOUNTED FUEL TANK, AND CRITICAL SILENCER
- ⑬ NEW 3P-400A. ENCLOSED MAIN CIRCUIT BREAKER, GROUND BAR, U.L. LISTED FOR SERVICE ENTRANCE
- ⑭ NEW 400A., 480V., 3PH., 3W. AUTOMATIC TRANSFER SWITCH, NEMA 1 SURFACE ENCLOSURE, SOLID STATE CONTROL PANEL
- ⑮ NEW GENERATOR REMOTE ANNUNCIATOR PANEL
- ⑯ NEW GENERATOR REMOTE EMERGENCY STOP PUSH-BUTTON STATION

ELECTRICAL KEYNOTES:

- ① EXIST. UTILITY AERIAL 12.47KV LINES TO REMAIN
- ② EXIST. UTILITY TRANSFORMER BANK AND SUPPORT STRUCTURE TO REMAIN; UTILITY SHALL DISCONNECT EXIST. AERIAL SECONDARY CABLES
- ③ EXIST. UTILITY 480V., 3PH. AERIAL SECONDARY CABLES TO BE REMOVED BY THE UTILITY TO THE WEATHERHEAD
- ④ EXIST. WEATHERHEAD, CONDUIT AND CABLES TO BE REMOVED BY THE CONTRACTOR.
- ⑤ EXIST. 4 #500MCM, 3 1/2" C. TO BE REMOVED BY THE CONTRACTOR
- ⑥ EXIST. MANUAL TRANSFER SWITCH, 400A., 480V., 3PH., 3W. WITH GROUND, TO BE REMOVED BY THE CONTRACTOR
- ⑦ EXIST. GENERATOR RECEPTACLE AND BOX, 400A., 480V., 4POLE, 4W., TO BE REMOVED BY THE CONTRACTOR
- ⑧ THE CONTRACTOR SHALL DISCONNECT THE EXIST. GROUNDING ELECTRODE CONDUCTOR FROM THE MOTOR CONTROL CENTER
- ⑨ THE UTILITY SHALL CONNECT NEW SECONDARY SERVICE ENTRANCE CABLES TO TRANSFORMERS
- ⑩ NEW 3 #500MCM, 1 #1/0 GND. AERIAL SERVICE ENTRANCE CABLES TO NEW WEATHERHEAD BY THE UTILITY
- ⑪ NEW U.G. 3 #500MCM, 1 #1/0 GND., 3 1/2" C.
- ⑫ NEW 3 #500MCM, 1 #1/0 GND., 3 1/2" C.
- ⑬ NEW #1/0 GROUND ELECTRODE CONDUCTOR AND 3/4" DIA. X 10' LONG COPPER CLAD GROUND ROD
- ⑭ NEW U.G. 3 #10, 1 #10G., AND 2 #12, 1 #12G., 1" C.
- ⑮ NEW U.G. 4 #12, 1 #12G. AND 16 #14, 3/4" C.
- ⑯ NEW 4 #12, 1 #12G. AND 16 #14, 3/4" C.
- ⑰ NEW 16 #14, 3/4" C.
- ⑱ NEW 4 #12, 1 #12G., 3/4" C.
- ⑲ NEW 3 #10, 1 #10G., AND 2 #12, 1 #12G., 1" C.
- ⑳ NEW WEATHERHEAD, 3 #500MCM, 1 #1/0 GND., 3 1/2" C.
- ㉑ NEW NEMA 4X PULLBOX WITH REMOVABLE COVER; 12"X12"X30". MOUNT TOP AS HIGH AS POSSIBLE
- ㉒ NEW 6"X6"X4" NEMA 4X PULLBOX; MOUNT AS HIGH AS POSSIBLE
- ㉓ NEW 6"X6"X6" NEMA 4X PULLBOX; MOUNT AS HIGH AS POSSIBLE
- ㉔ CONNECT NEW CIRCUITS TO JACKET WATER HEATER AND BATTERY CHARGER
- ㉕ INSTALL (1) NEW 2P-25A. CIRCUIT BREAKER (GEN. JACKET WATER HTR.) AND (1) 1P-20A. CIRCUIT BREAKER (BATTERY CHARGER) IN EXIST. PANEL "LP"
- ㉖ CONNECT NEW CIRCUITING TO EXIST. MOTOR CONTROL CENTER MAIN LUGS AND GROUND BUS
- ㉗ NEW U.G. 1 #1/0 GND., 3/4" C.; CONNECT TO GROUND BAR IN MAIN CIRCUIT BREAKER ENCLOSURE.
- ㉘ NEW REINFORCED CONCRETE PAD WITH TURNED DOWN SIDES; MIN. 30" BELOW GRADE
- ㉙ NEW 2 #14, 1 #14G., 3/4" C.; EMERGENCY SHUT-DOWN WIRING.

NOTES:

J. W. SIMS & ASSOCIATES ENGINEERING CO.
1545 COUNTRY CLUB ROAD
INDIANAPOLIS, INDIANA 46234
317-209-4035 FAX 209-4036
EMAIL JWSIMS@JWSIMS.COM

NO.	DESCRIPTION	DATE	BY
2	RENUMBERED	5/2004	GCR
1	AS-BUILT REVISION	5/2004	GCR

HOOSIER HILLS REGIONAL WATER DISTRICT
DIVISION "F" WATERWORKS SYSTEM IMPROVEMENTS
CONTRACT F-1

WATER TREATMENT PLANT
ELECTRICAL FLOOR PLANS

GRW PROJECT NO. 2745 JWSA PROJECT NO. 2001-05

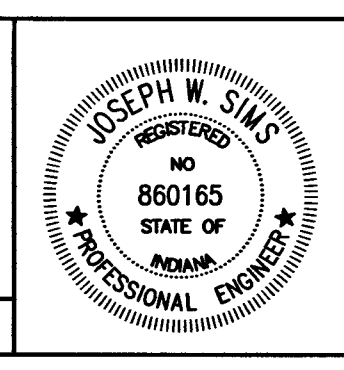

GRW Engineers, Inc.
Engineers, Architects, Planners
INDIANAPOLIS, INDIANA
LOUISVILLE & LEXINGTON, KENTUCKY
CINCINNATI, OHIO
NASHVILLE, TENNESSEE
ARLINGTON, TEXAS

DRAWN: JBK	DATE: JULY, 2002
FILE NAME: F1-E3_REVISED.DWG	SCALE: AS NOTED
CHECKED: JWS	SHEET NO. E3/565
APPROVED: JWS	