

Fall Creek Regional Waste District

#6904

9378 S 650 W, P.O. Box 59, Pendleton, IN 46064

765-778-7544

Agreement for Sanitary Sewer Service

This Agreement made and entered into this 4 day of September, 2019, between Fall Creek Regional Waste District ("District") and Jerry Stevens Construction ("Applicant") regarding the provision of sanitary sewer service, and the assignment of capacity in and connection to, the District's facilities for the premises located at lot # 766 & 762.

Street Address: n Swain St (437?)

Now therefore, the parties, in consideration of the mutual promises set out in this Agreement, the receipt and sufficiency of which is hereby acknowledged, agree as follows:

1. The Applicant agrees that all workmanship and materials shall conform to all District ordinances and the District's construction standards. District must accept and approve all work and materials before backfilling and final connection is made to the sewer mains. Any violation of this provision will cause all lines and appurtenances in violation to be removed and replaced at the Applicant's expense.
2. The District shall have the right to enter upon the Applicant's premises at all reasonable times to inspect, repair, or replace any equipment used in connection with the District's service or which has an impact on said service.
3. The Applicant shall be responsible for all monthly user rates, capacity charges, and tap fees. The failure to pay any rate charge or fee may result in a lien against the property and/or the termination of service to the property, the cost of which will be borne by Applicant, including, but not limited to, all attorney's fees and collection costs.
4. The District shall not be responsible for any damages as a result of any failure to supply service unless said damages are due to default, neglect or culpability on the part of the District.
5. If there is an available sanitary sewer within three hundred (300) feet of the property line, the property owner shall be required to connect to the District's sanitary sewer system.
6. The Applicant and District agree that the provision of sanitary sewer service touches and concerns the property and the terms of this Agreement bind the District and Applicant and their heirs, executors, administrators, personal representatives, successors, agents, attorneys, assigns, designees, and transferees.

The parties hereto have read and fully understand the above provisions and agree to comply with said provisions.

FALL CREEK REGIONAL WASTE DISTRICT

Signature

APPLICANT

Signature

STATE OF INDIANA)

) SS:

COUNTY OF MADISON)

SUBSCRIBED and sworn to before me this 4 day of Sept., 2019

Signature

Printed

Notary Public

Resident of Madison County

Inspector SM Date Inspected 9-20-19 Approved X Rejected _____

Reason for Rejection _____

Date Reinspected _____ Approved _____ Rejected _____

Notes:

Size Pipe 6 Type Pipe 35Basement Yes NoSump Pump Yes NoDownspout to Ground Yes X No _____Septic Tank Pumped & Filled Yes NoContractor Jerry Stevens Co

Special Conditions _____

Existing Home _____

New Construction X

2 pictures attached

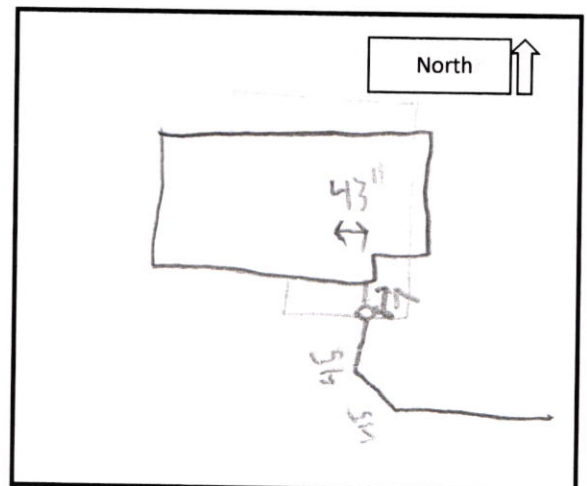

Lots 762&761 (Combined for one home)

Swain ST, Ingalls

437?

Sean Mitchel



Lots 762&761 (Combined for one home)

Swain ST, Ingalls

Sean Mitchel



TO REORDER VISIT WWW.CAROUSELCHECKS.COM

Jerry A Stevens Construction Inc
35-1773016
5554 W 300 N
Rushville, IN 46173-8612

7329
71-7110/2749

Date 9/4/2019

Pay to the Order of FCHWD \$ 6740⁰⁰

Six Thousand seven hundred forty and 00/100 Dollars  Security details on back.

USLA
Connersville, IN 47331

For Sewer Permits

[Signature] MP

Lex # 11014