

31-06145.00 Ryan Reef

4732

FALL CREEK REGIONAL WASTE DISTRICT

9378 S 650 WEST, P.O. BOX 59, PENDLETON, IN 46064

765-778-7544

AGREEMENT FOR SANITARY SEWER SERVICE

This Agreement made and entered into this 6th day of January, 2003, between FALL CREEK REGIONAL WASTE DISTRICT ("District") and C.P. Morgan ("Applicant") regarding the provision of sanitary sewer service, and the assignment of capacity in, and connection to, the District's facilities for the premises located at Lot #30 9242 W. Reflection Ct. Summerlake

NOW THEREFORE, the parties, in consideration of the mutual promises set out in this Agreement, the receipt and sufficiency of which is hereby acknowledged, agree as follows:

1. The Applicant agrees that all workmanship and materials shall conform to all District ordinances and the District's construction standards. District must accept and approve all work and materials before backfilling and final connection is made to the sewer mains. Any violation of this provision will cause all lines and appurtenances in violation to be removed and replaced at the Applicant's expense.
2. The District shall have the right to enter upon the Applicant's premises at all reasonable times to inspect, repair, or replace any equipment used in connection with the District's service and to have an impact on said service.
3. The Applicant shall be responsible for all monthly use charges. The failure to pay any rate charge or fee may result in a lien against the property, the cost of which will be borne by Applicant, including, but not limited to, the cost of service to the property and collection costs.
4. The District shall not be responsible for any damages to the property or service unless said damages are due to default, neglect or culpability on the part of the District.
5. If there is an available sanitary sewer within three hundred (300) feet of the property line, the property owner shall be required to connect to the District's sanitary sewer system.
6. The Applicant and District agree that the provision of sanitary sewer service touches and concerns the property and the terms of this Agreement bind the District and Applicant and their heirs, executors, administrators, personal representatives, successors, agents, attorneys, assigns, designees, and transferees.

The parties hereto have read and fully understand the above provisions and agree to comply with said provisions.

FALL CREEK REGIONAL WASTE DISTRICT

Signature

STATE OF INDIANA)

) SS:

COUNTY OF MADISON)

APPLICANT

Signature

My Commission Expires:

4-29-09

Signature

Printed

Notary Public

Resident of Madison County

INSPECTOR BEN DATE INSPECTED 1-15-03 APPROVED ✓ REJECTED _____

REASON FOR REJECTION 6" - 9" ch. 11 Factor

DATE REINSPECTED _____ APPROVED _____ REJECTED _____

NOTES:

SIZE PIPE 6 TYPE PIPE PVC

BASEMENT YES _____ NO X

SUMP PUMP YES _____ NO X

DOWNSPOUT TO GROUND YES X NO _____

SEPTIC TANK PUMPED & FILLED YES _____ NO X

CONTRACTOR Buttz

SPECIAL CONDITIONS _____

EXISTING HOME _____

NEW CONSTRUCTION X

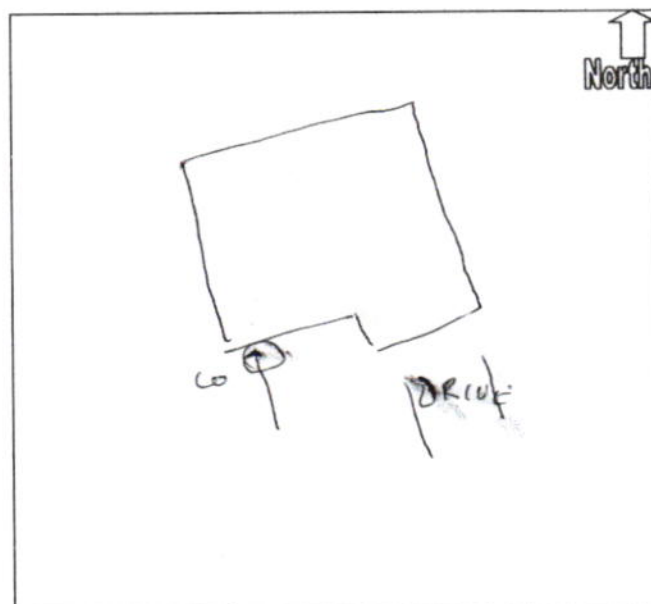

25694

C.P. MORGAN COMMUNITIES, LP
CONSTRUCTION ACCOUNT

BANK ONE, NA
INDIANAPOLIS, INDIANA 46277
20-1-740

1/6/2003

PAY TO THE ORDER OF Fall Creek Regional Waste Dist

*****475.00

Four Hundred Seventy-Five and no/100*****

DOLLARS

Fall Creek Regional Waste Dist

210030102 su 30

MEMO

⑈025694⑈ ⑈074000010⑈



MP