

21-32024.00

Fall Creek Regional Waste District
9378 S 650 W, P.O. Box 59, Pendleton, IN 46064
765-778-7544

#8315

Agreement for Sanitary Sewer Service

This Agreement made and entered into this 3 day of May, 2023, between Fall Creek Regional Waste District ("District") and Lennar Homes ("Applicant") regarding the provision of sanitary sewer service, and the assignment of capacity in and connection to, the District's facilities for the premises located at Springbrook Lot 353.

Street Address: 8845 Lester Pl, Pendleton

Now therefore, the parties, in consideration of the mutual promises set out in this Agreement, the receipt and sufficiency of which is hereby acknowledged, agree as follows:

1. The Applicant agrees that all workmanship and materials shall conform to all District ordinances and the District's construction standards. District must accept and approve all work and materials before backfilling and final connection is made to the sewer mains. Any violation of this provision will cause all lines and appurtenances in violation to be removed and replaced at the Applicant's expense.
2. The District shall have the right to enter upon the Applicant's premises at all reasonable times to inspect, repair, or replace any equipment used in connection with the District's service or which has an impact on said service.
3. The Applicant shall be responsible for all monthly user rates, capacity charges, and tap fees. The failure to pay any rate charge or fee may result in a lien against the property and/or the termination of service to the property, the cost of which will be borne by Applicant, including, but not limited to, all attorney's fees and collection costs.
4. The District shall not be responsible for any damages as a result of any failure to supply service unless said damages are due to default, neglect or culpability on the part of the District.
5. If there is an available sanitary sewer within three hundred (300) feet of the property line, the property owner shall be required to connect to the District's sanitary sewer system.
6. The Applicant and District agree that the provision of sanitary sewer service touches and concerns the property and the terms of this Agreement bind the District and Applicant and their heirs, executors, administrators, personal representatives, successors, agents, attorneys, assigns, designees, and transferees.

The parties hereto have read and fully understand the above provisions and agree to comply with said provisions.

FALL CREEK REGIONAL WASTE DISTRICT
Rebecca Hunter
Signature

APPLICANT
[Signature]
Signature

STATE OF INDIANA)
) SS:
COUNTY OF MADISON)

SUBSCRIBED and sworn to before me this _____ day of _____, 20____

My Commission Expires: _____ Signature _____

Printed _____
Notary Public
Resident of _____ County

Inspector SN Date Inspected 6/30/23 Approved ✓ Rejected _____
Reason for Rejection _____
Date Reinspected _____ Approved _____ Rejected _____

Notes:
Size Pipe 6" Type Pipe 35
Basement Yes _____ No _____
Sump Pump Yes _____ No _____
Downspout to Ground Yes _____ No _____
Septic Tank Pumped & Filled Yes _____ No _____
Contractor Baldwin
Special Conditions _____
Existing Home _____
New Construction ✓

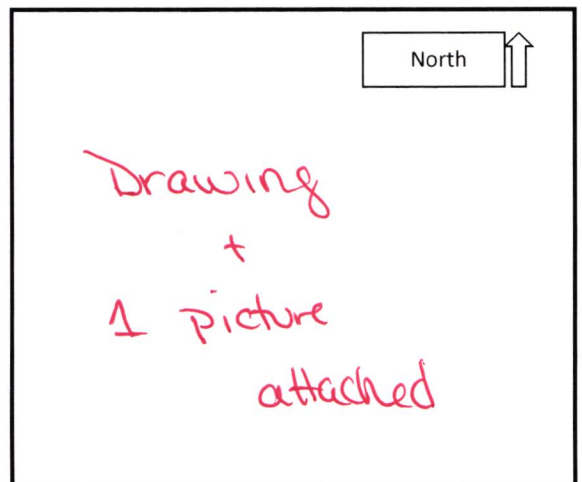



STOEPPELWERTH

ALWAYS ON

7965 East 106th Street, Fishers, IN 46038-2505
phone: 317.849.5935 fax: 317.849.5942

JOB ID SPRINGBK7.353

CONTROL# 106875 LEN

PARCEL#48-15-28-403-001.353-014

8845 LESTER PLACE
PENDLETON, IN 46064



1" = 30'

LOT AREA: 9,504 Sq. Ft.

DESIGN PAD=863.25

M.F.F.E.=863.4

M.F.P.G.=863.1

LEGEND:

XX.X

PROPOSED GRADE PER PLAN

XX.XAB

AS BUILT GRADE

S.S.D.

SUB-SURFACE DRAIN

AS

SANITARY SEWER

PSL

6" AS BUILT SANITARY LATERAL

W

6" PROPOSED SANITARY LATERAL

W

STORM SEWER

W

3/4" WATER CONNECTION

W

WATER MAIN

SWALE

SWALE



SANITARY MANHOLE



STORM MANHOLE



CURB INLET



FIRE HYDRANT



STREET TREE



WATER METER



D.U.&S.S.E. DRAINAGE, UTILITY & SANITARY SEWER EASEMENT

D.U.E.

DRAINAGE & UTILITY EASEMENT

B.L.

BUILDING LINE

M.F.F.E.

MINIMUM FINISHED FLOOR ELEVATION

M.F.P.G.

MINIMUM FLOOD PROTECTION GRADE

(P)

PLATTED

(M)

MEASURED

(P)

PLATTED

(M)

MEASURED

(P)

PLATTED

(M)

MEASURED

(P)

PLATTED

(M)

MEASURED

(P)

PLATTED

(M)

MEASURED

(P)

PLATTED

(M)

MEASURED

(P)

PLATTED

(M)

MEASURED

(P)

PLATTED

(M)

MEASURED

(P)

PLATTED

(M)

MEASURED

(P)

PLATTED

(M)

MEASURED

(P)

PLATTED

(M)

MEASURED

(P)

PLATTED

(M)

MEASURED

(P)

PLATTED

(M)

MEASURED

(P)

PLATTED

(M)

MEASURED

(P)

PLATTED

(M)

MEASURED

(P)

PLATTED

(M)

MEASURED

(P)

PLATTED

(M)

MEASURED

(P)

PLATTED

(M)

MEASURED

(P)

PLATTED

(M)

MEASURED

(P)

PLATTED

(M)

MEASURED

(P)

PLATTED

(M)

MEASURED

(P)

PLATTED

(M)

MEASURED

(P)

PLATTED

(M)

MEASURED

(P)

PLATTED

(M)

MEASURED

(P)

PLATTED

(M)

MEASURED

(P)

PLATTED

(M)

MEASURED

(P)

PLATTED

(M)

MEASURED

(P)

PLATTED

(M)

MEASURED

(P)

PLATTED

(M)

MEASURED

(P)

PLATTED

(M)

MEASURED

(P)

PLATTED

(M)

MEASURED

(P)

PLATTED

(M)

MEASURED

(P)

PLATTED

(M)

MEASURED

(P)

PLATTED

(M)

MEASURED

(P)

PLATTED

(M)

MEASURED

(P)

PLATTED

(M)

MEASURED

(P)

PLATTED

(M)

MEASURED

(P)

PLATTED

(M)

MEASURED

(P)

PLATTED

(M)

MEASURED

(P)

PLATTED

(M)

MEASURED

(P)

PLATTED

(M)

MEASURED

(P)

PLATTED

(M)

MEASURED

(P)

PLATTED

(M)

MEASURED

(P)

PLATTED

(M)

MEASURED

(P)

PLATTED

(M)

MEASURED

(P)

PLATTED

(M)

MEASURED

(P)

PLATTED

(M)

MEASURED

(P)

PLATTED

(M)

MEASURED

(P)

PLATTED

(M)

MEASURED

(P)

PLATTED

(M)

MEASURED

(P)

PLATTED

(M)

MEASURED

(P)

PLATTED

(M)

MEASURED

(P)

PLATTED

(M)

MEASURED

(P)

PLATTED

(M)

MEASURED

(P)

PLATTED

(M)

MEASURED

(P)

PLATTED

(M)

MEASURED

(P)

PLATTED

(M)

MEASURED

(P)

PLATTED

(M)

MEASURED

(P)

PLATTED

(M)

MEASURED

(P)

PLATTED

(M)

MEASURED

(P)

PLATTED

(M)

MEASURED

(P)

PLATTED

(M)

MEASURED

(P)

PLATTED

(M)

MEASURED

(P)

PLATTED

(M)

MEASURED

(P)

PLATTED

(M)

MEASURED

(P)

PLATTED

(M)

MEASURED

(P)

PLATTED

(M)

MEASURED

(P)

PLATTED

(M)

MEASURED

(P)

PLATTED

(M)

MEASURED

(P)



Springbrook

Lot 353 8845 Lester Pl
6/30/23 Baldwin 14

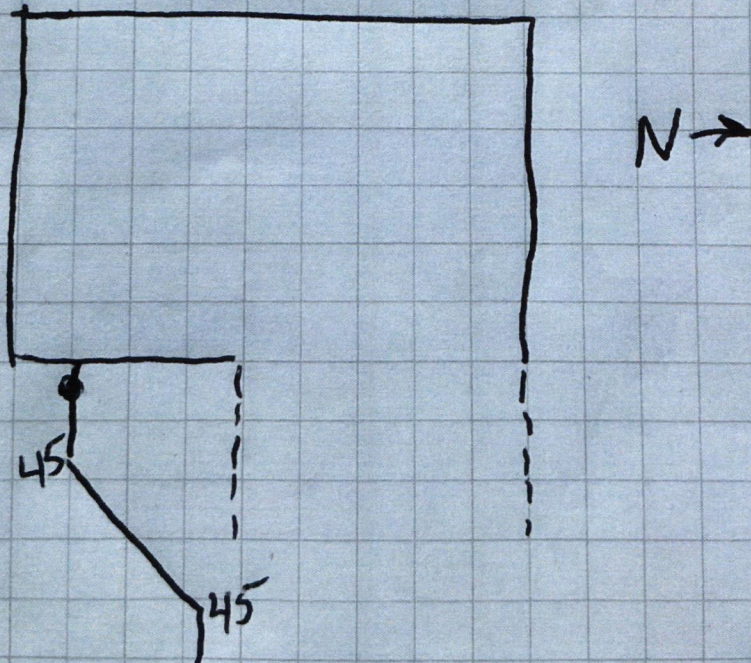



C620157202015720

PAGE: 1 of 1

DATE: May 1, 2023
CHECK NUMBER: 2015720
AMOUNT PAID: \$760.00

Lennar Corporation
Lennar Homes of Indiana, LLC
Indianapolis Division
11555 N Meridian St Ste 400
Carmel, IN 46032

00006 13651 CKS SD 23121 - 0002015720 NNNNNNNNNNN 1215100004203 XIP3CL C
FALL CREEK REGIONAL WASTE DISTRICT
PO BOX 59
PENDLETON IN 46064



Vendor No: 12975753

Date	CO. #	Invoice Number	Payment Advice	Gross Amount	Discount	Net Amount
04/21/23	69372	69372710353 WS	MV-69372710353 WS	\$760.00	\$0.00	\$760.00
TOTALS				\$760.00	\$0.00	\$760.00

Rec # 012409

PLEASE DETACH BEFORE DEPOSITING CHECK

Lennar Corporation
Lennar Homes of Indiana, LLC
Indianapolis Division
11555 N Meridian St Ste 400
Carmel, IN 46032

CHECK
NUMBER 2015720
May 1, 2023

70-2322
719

*** VOID AFTER 180 DAYS ***

PAY FALL CREEK REGIONAL WASTE DISTRICT
TO THE PO BOX 59
ORDER OF: PENDLETON, IN 46064

CHECK AMOUNT
\$760.00

EXACTLY *****760 DOLLARS AND 00 CENTS

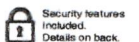

JPMorgan Chase Bank, N.A.
Chicago, IL

Dene Bueh

Authorized Signature