

Fall Creek Regional Waste District
9378 S 650 W, P.O. Box 59, Pendleton, IN 46064
765-778-7544

#8320

Agreement for Sanitary Sewer Service

This Agreement made and entered into this 21 day of September, 2022, between Fall Creek Regional Waste District ("District") and Lennar Homes ("Applicant") regarding the provision of sanitary sewer service, and the assignment of capacity in and connection to, the District's facilities for the premises located at Springbrook Lot 358.

Street Address: 8787 Lester Pl, Pendleton

Now therefore, the parties, in consideration of the mutual promises set out in this Agreement, the receipt and sufficiency of which is hereby acknowledged, agree as follows:

1. The Applicant agrees that all workmanship and materials shall conform to all District ordinances and the District's construction standards. District must accept and approve all work and materials before backfilling and final connection is made to the sewer mains. Any violation of this provision will cause all lines and appurtenances in violation to be removed and replaced at the Applicant's expense.
2. The District shall have the right to enter upon the Applicant's premises at all reasonable times to inspect, repair, or replace any equipment used in connection with the District's service or which has an impact on said service.
3. The Applicant shall be responsible for all monthly user rates, capacity charges, and tap fees. The failure to pay any rate charge or fee may result in a lien against the property and/or the termination of service to the property, the cost of which will be borne by Applicant, including, but not limited to, all attorney's fees and collection costs.
4. The District shall not be responsible for any damages as a result of any failure to supply service unless said damages are due to default, neglect or culpability on the part of the District.
5. If there is an available sanitary sewer within three hundred (300) feet of the property line, the property owner shall be required to connect to the District's sanitary sewer system.
6. The Applicant and District agree that the provision of sanitary sewer service touches and concerns the property and the terms of this Agreement bind the District and Applicant and their heirs, executors, administrators, personal representatives, successors, agents, attorneys, assigns, designees, and transferees.

The parties hereto have read and fully understand the above provisions and agree to comply with said provisions.

FALL CREEK REGIONAL WASTE DISTRICT
Rebecca Hunt
Signature

APPLICANT
[Signature]
Signature

STATE OF INDIANA)
) SS:
COUNTY OF MADISON)

SUBSCRIBED and sworn to before me this ____ day of _____, 20__

My Commission Expires: _____ Signature _____

Printed _____
Notary Public
Resident of _____ County

Inspector Lyle Date Inspected 11/11/22 Approved ✓ Rejected _____
Reason for Rejection _____

Date Reinspected _____ Approved _____ Rejected _____

Notes:
Size Pipe 6" Type Pipe SDR 35
Basement Yes No
Sump Pump Yes No
Downspout to Ground Yes No
Septic Tank Pumped & Filled Yes No
Contractor Baldwin Exv.
Special Conditions _____
Existing Home _____
New Construction ✓

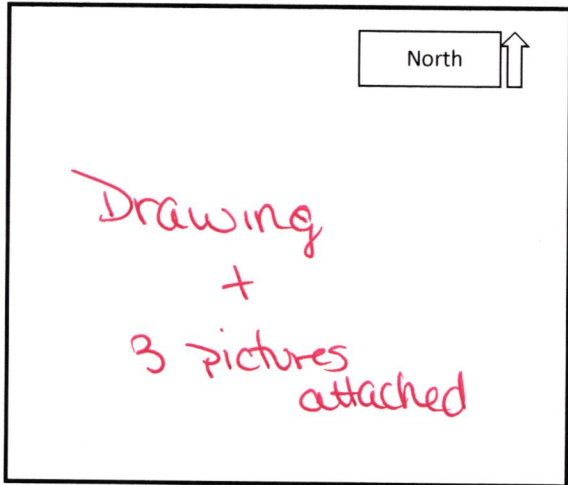



STOEPPELWERTH

ALWAYS ON

7965 East 106th Street, Fishers, IN 46038-2505
phone: 317.849.5935 fax: 317.849.5942

JOB ID SPRINGBK7.358

CONTROL# 105025 LEN

PARCEL#48-15-28-403-001.359-014

8787 LESTER PLACE
PENDLETON, IN, 46064
1" = 30'

LOT AREA: 13,075 Sq. Ft.

M.F.F.E.=863.1
M.F.P.G.=863.1

SOD: 1,328 ± Sq. Yd.
SEED: N/A ± Sq. Ft.
CONC. DRIVEWAY: 824 ± Sq. Ft.
PRIVATE WALK: 29 ± Sq. Ft.
PUBLIC WALK: 1,147 ± Sq. Ft.
APRON: 305 ± Sq. Ft.
ADDITIONAL SOD: N/A ± Sq. Yd.
HANDICAP RAMPS: 2

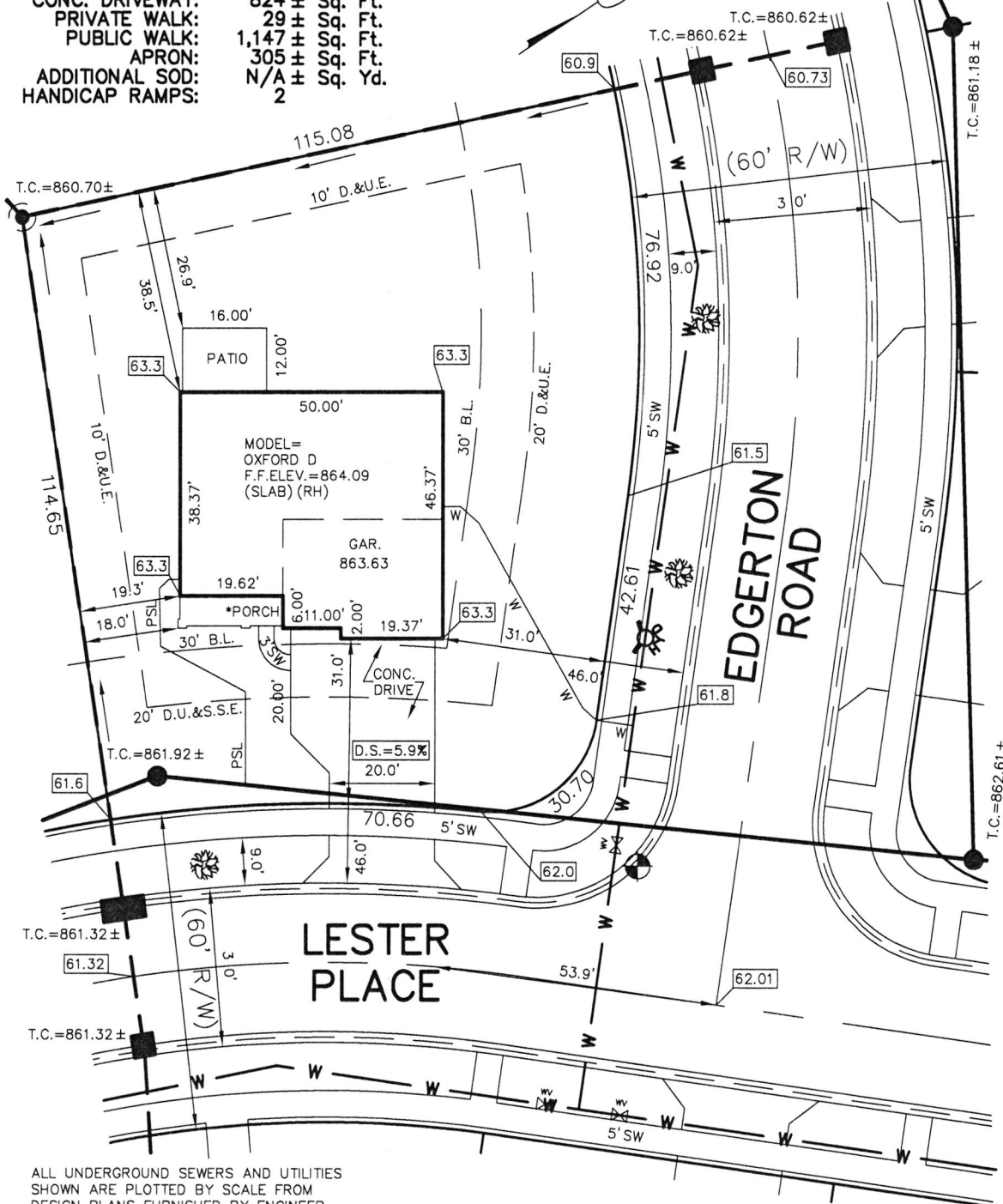

ALL UNDERGROUND SEWERS AND UTILITIES SHOWN ARE PLOTTED BY SCALE FROM DESIGN PLANS FURNISHED BY ENGINEER. THE ACTUAL FIELD LOCATION MAY VARY.

LEGEND:

XX.X PROPOSED GRADE PER PLAN
XX.XAB AS BUILT GRADE

S.S.D. SUB-SURFACE DRAIN
ASL SANITARY SEWER
PSL 6" AS BUILT SANITARY LATERAL
6" PROPOSED SANITARY LATERAL
W STORM SEWER
3/4" WATER CONNECTION
W WATER MAIN
SW SWALE

● SANITARY MANHOLE

○ STORM MANHOLE

■ CURB INLET

☼ FIRE HYDRANT

🌳 STREET TREE

⊕ WATER VALVE

D.U.&S.S.E. DRAINAGE, UTILITY & SANITARY SEWER EASEMENT
D.&U.E. DRAINAGE & UTILITY EASEMENT
B.L. BUILDING LINE
M.F.F.E. MINIMUM FINISHED FLOOR ELEVATION
M.F.P.G. MINIMUM FLOOD PROTECTION GRADE

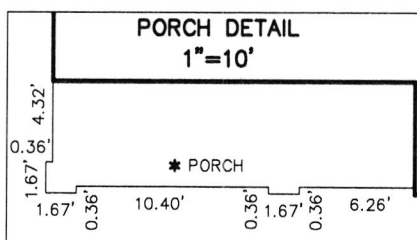

BENCHMARK

TOP OF CURB = 862.01

LOT 358
SPRINGBROOK
SECTION 7

INST. #2022R013984

ZONING: R3

5' MINIMUM SIDE YARD
30' MINIMUM FRONT YARD
15' MINIMUM REAR YARD

SIGNATURE: _____ DATE: _____
SIGNATURE REPRESENTS CONFIRMATION OF RECEIPT OF PLOT PLAN BY CUSTOMER

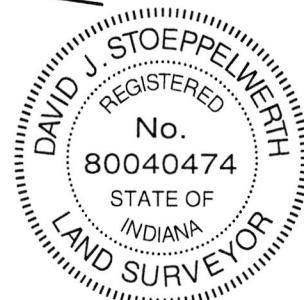

David J. Stoeppelwerth

NOTE: THIS DRAWING IS FOR PERMITTING PURPOSES ONLY AND NOT INTENDED TO BE REPRESENTED AS A RETRACEMENT SURVEY, ORIGINAL SURVEY, ROUTE SURVEY, LOT SURVEY OR A SURVEYOR LOCATION REPORT OR ANY OTHER TYPE OF PROPERTY BOUNDARY ASSESSMENT. NO BOUNDARY CORNERS HAVE BEEN SET AND THEREFORE NO LIABILITY WILL BE ASSUMED FOR ANY USE OF THIS DATA FOR CONSTRUCTION OF NEW IMPROVEMENTS INCLUDING FENCES.

09/14/22 JRS



Springbrook Lot # 358
Baldwin Exh.

11/11/22

→ N

8787 Lester Pl.

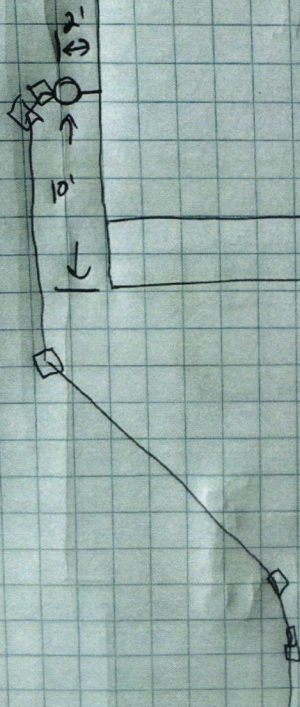







Lennar Corporation
Lennar Homes of Indiana, LLC
Indianapolis Division
11555 N Meridian St Ste 400
Carmle, IN 46032

C618834051883405

PAGE: 1 of 1

DATE: September 19, 2022
CHECK NUMBER: 1883405
AMOUNT PAID: \$760.00

00005 4623 CKS SF 22262 - 0001883405 NNNNNNNNNN 2625100004205 XIP3C6 C
FALL CREEK REGIONAL WASTE DISTRICT
PO BOX 59
PENDLETON IN 46064



Vendor No: 12975753

Date	CO. #	Invoice Number	Payment Advice	Gross Amount	Discount	Net Amount
09/14/22	69372	69372710358 WS	MV-69372710358 WS	\$760.00	\$0.00	\$760.00
TOTALS				\$760.00	\$0.00	\$760.00

PLEASE DETACH BEFORE DEPOSITING CHECK

Lennar Corporation
Lennar Homes of Indiana, LLC
Indianapolis Division
11555 N Meridian St Ste 400
Carmle, IN 46032

CHECK
NUMBER 1883405
September 19, 2022

70-2322
719

*** VOID AFTER 180 DAYS ***

PAY TO THE ORDER OF: FALL CREEK REGIONAL WASTE DISTRICT
PO BOX 59
PENDLETON, IN 46064

CHECK AMOUNT
\$760.00

EXACTLY *****760 DOLLARS AND 00 CENTS

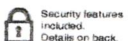

JPMorgan Chase Bank, N.A.
Chicago, IL

Dane B...

Authorized Signature