

FALL CREEK REGIONAL WASTE DISTRICT
9378 S 650 WEST, P.O. BOX 59, PENDLETON, IN 46064
765-778-7544

AGREEMENT FOR SANITARY SEWER SERVICE

This Agreement made and entered into this 22nd day of May, 2006, between FALL CREEK REGIONAL WASTE DISTRICT ("District") and Richard Van Zee ("Applicant") regarding the provision of sanitary sewer service, and the assignment of capacity in, and connection to, the District's facilities for the premises located at 7912 W 900 South, Pendleton.

NOW THEREFORE, the parties, in consideration of the mutual promises set out in this Agreement, the receipt and sufficiency of which is hereby acknowledged, agree as follows:

1. The Applicant agrees that all workmanship and materials shall conform to all District ordinances and the District's construction standards. District must accept and approve all work and materials before backfilling and final connection is made to the sewer mains. Any violation of this provision will cause all lines and appurtenances in violation to be removed and replaced at the Applicant's expense.
2. The District shall have the right to enter upon the Applicant's premises at all reasonable times to inspect, repair, or replace any equipment used in connection with the District's service or which has an impact on said service.
3. The Applicant shall be responsible for all monthly user rates, capacity charges, and tap fees. The failure to pay any rate charge or fee may result in a lien against the property and/or the termination of service to the property, the cost of which will be borne by Applicant, including, but not limited to, all attorney's fees and collection costs.
4. The District shall not be responsible for any damages as a result of any failure to supply service unless said damages are due to default, neglect or culpability on the part of the District.
5. If there is an available sanitary sewer within three hundred (300) feet of the property line, the property owner shall be required to connect to the District's sanitary sewer system.
6. The Applicant and District agree that the provision of sanitary sewer service touches and concerns the property and the terms of this Agreement bind the District and Applicant and their heirs, executors, administrators, personal representatives, successors, agents, attorneys, assigns, designees, and transferees.

The parties hereto have read and fully understand the above provisions and agree to comply with said provisions.

FALL CREEK REGIONAL WASTE DISTRICT

APPLICANT

Signature

Signature

STATE OF INDIANA)
) SS:
COUNTY OF MADISON)

SUBSCRIBED and sworn to before me this _____ day of _____, 200 ____.

My Commission Expires:

Signature

Printed

Notary Public
Resident of Madison County

INSPECTOR SN DATE INSPECTED 3/31/06 APPROVED ✓ REJECTED _____

REASON FOR REJECTION _____

DATE REINSPECTED _____ APPROVED _____ REJECTED _____

NOTES:
SIZE PIPE 4" 1/2 TYPE PIPE 35 / 160 PSI

BASEMENT YES _____ NO _____

SUMP PUMP YES _____ NO _____

DOWNSPOUT TO GROUND YES _____ NO _____

SEPTIC TANK PUMPED & FILLED YES _____ NO _____

CONTRACTOR D & R EY

SPECIAL CONDITIONS _____

EXISTING HOME ✓

NEW CONSTRUCTION _____

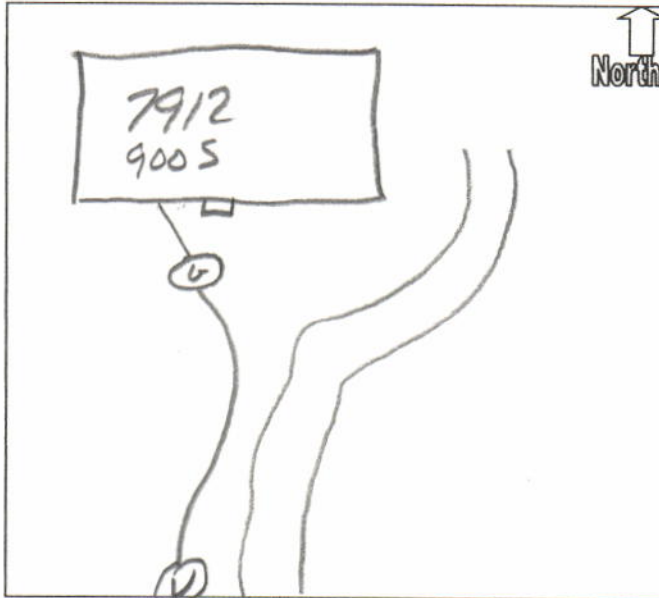



FALL CREEK REGIONAL WASTE DISTRICT

P.O. Box 59 • 9378 S. 650 West • Pendleton, Indiana 46064-0059 • (765) 778-7544

May 17, 2006

Richard L. Van Zee
7912 West 900 South
Pendleton, IN 46064

485-4030

Dear Mr. Van Zee:

In a letter dated August 10, 2006 and received by you on August 20, 2006, Fall Creek Regional Waste District notified you that wastewater collection service was available at the above address. Indiana Code 13 required connection to the wastewater collection system within 90 days of the receipt of the notice. Our records indicate that as of this date you have failed to connect.

Connection to the wastewater collection system is your responsibility and must comply with District Construction Standards as indicated on the attached sheet. Disposition of your existing septic tank is also your responsibility. The tank shall be disconnected from further use, emptied of its contents and filled with granular material.

A residential wastewater grinder unit is required to connect your facilities to the wastewater collection system. This unit is available at no cost to you from the District and arrangements can be made to pick up your unit from the District by contacting the Administration Office, 9378 S. 650 W., Pendleton, Indiana. The cost of the grinder unit is covered by an Indiana Department of Commerce, Community Focus Fund Grant for the new sanitary sewers in your neighborhood.

Application forms for service can also be obtained at the Administration Office. There are no connection fees. The Indiana Department of Commerce, Community Focus Fund Grant requires the District to waive all of your connection fees. A Permit will be issued to you when the Application for Service has been completed.

Your only expense will be paying your plumber or contractor to install your sanitary sewer service lateral and to install your residential wastewater grinder unit.

Please notify us when your sewer lateral and grinder unit have been installed and ready for inspection and connection to the sanitary sewer main. This service is for wastewater only. Connection of roof downspouts, exterior footing drains, surface run-off groundwater connections or sump pumps are prohibited. This installation shall be completed within 30 days of receipt of this letter. Failure to comply may necessitate legal action by Fall Creek Regional Waste District.

If you have any questions, please contact our office at (765) 778-7544 or 1-866-778-7544.

Respectfully,

J.F. Rowlett
General Manager

Encl. Construction Standards Sheet