



# FALL CREEK REGIONAL WASTE DISTRICT

Box 44, Pendleton, Indiana 46064

2-0022900.00

No 001698

## APPLICATION FOR SEWER PERMIT

Permit No. \_\_\_\_\_ Date 10-20-89

Permit Void 90 days from Date of Issuance

Owner Name Bruce Gray

Property Address 7082 S. 50th

Lot # \_\_\_\_\_ P.O. Box \_\_\_\_\_

Town Pendleton, IN Zip Code 46064

Phone \_\_\_\_\_ Water Meter \_\_\_\_\_

\$ 2,880.00 Tap on Fee Paid

\$ 25.00 Inspection fee paid

Application is hereby made for connection to the Fall Creek Regional Waste District Sewer System for the above listed property - Permit Type: Residential ☒, Commercial \_\_\_\_\_, Industrial \_\_\_\_\_, or Governmental/Institutional \_\_\_\_\_. User Information \_\_\_\_\_

All workmanship and materials shall conform to the standards of the District Ordinance as described in Ordinance 84-2 and 84-3 as amended. Acceptance and approval must be made by the District inspector or his duly authorized representative before backfilling and final connection is made to the main sewer lines. Any violation of applicable regulations will cause all lines and appurtenances in violation to be removed and replaced at the owners expense.

The Fall Creek Regional Waste District is responsible for the inspection, approval of materials, and installation techniques only. All costs for materials and installation and any liabilities resulting from same is the sole responsibility of the property owner.

I have read and fully understand the above provisions and agree to comply by said provisions.

X Donitt Gray

APPLICANT(S) SIGNATURE

\*\*\*\*\*

INSPECTOR LM

Date inspected 10/30/89 Approved ☒ Rejected \_\_\_\_\_

Reason for rejection \_\_\_\_\_

Date reinspected \_\_\_\_\_ Approved \_\_\_\_\_ Rejected \_\_\_\_\_

Notes:

Size Pipe 4"

Type Pipe PVC

Basement Yes \_\_\_\_\_ No ☒

Sump Pump Yes \_\_\_\_\_ No ☒

Downspout to Ground Yes ☒ No \_\_\_\_\_

Septic Tank Pumped & filled Yes ☒ No \_\_\_\_\_

Contractor \_\_\_\_\_

Special Conditions 3/4" PVC

ELEC. Conduit

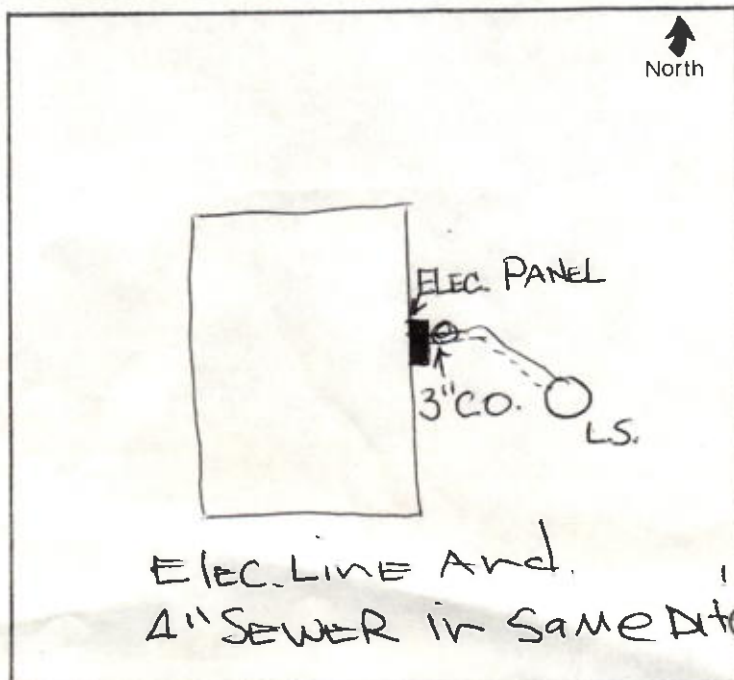



FALL CREEK REGIONAL WASTE DISTRICT

Box 44, Pendleton, Indiana 46064

APPLICATION FOR SEWER PERMIT

No 001698

10-20-89

Permit No. \_\_\_\_\_

Permit valid 90 days from date of issuance

Owner Name \_\_\_\_\_

Property Address \_\_\_\_\_

Box # \_\_\_\_\_

Town \_\_\_\_\_

Phone \_\_\_\_\_

Tap on fee paid \$ 2890.00

Inspection fee paid \$ 85.00

Application is hereby made for connection to the Fall Creek Regional Waste District sewer system for the above listed property - Permit Type: Residential ☒ Commercial \_\_\_\_\_ Industrial \_\_\_\_\_ Institutional \_\_\_\_\_

All workmanship and materials shall conform to the standards of the District Ordinance as described in Ordinance 84-2 and 84-3 as amended. Acceptance and approval must be made by the District Inspector or his duly authorized representative before backfilling and final connection is made to the town sewer lines. Any violation of applicable regulations will cause all lines and appurtenances in violation to be removed and replaced at the owner's expense.

The Fall Creek Regional Waste District is responsible for the inspection, approval of materials, and that District technicians only. All costs for materials and installation and any liabilities resulting from same are the sole responsibility of the property owner.

I have read and fully understand the above provisions and agree to comply by said provisions.

APPLICANT(S) SIGNATURE \_\_\_\_\_

INSTRUCTOR 11/11

Date Inspected 10/30/89 Approved ☒ Rejected \_\_\_\_\_

Reason for rejection \_\_\_\_\_

Date reinspected \_\_\_\_\_ Approved \_\_\_\_\_ Rejected \_\_\_\_\_

Notes:

Size Pipe 4"

Type Pipe PVC

Basement Yes ☒ No \_\_\_\_\_

Sum Pump Yes ☒ No \_\_\_\_\_

Downspout to Ground Yes ☒ No \_\_\_\_\_

Septic Tank Pumped & Filled Yes ☒ No \_\_\_\_\_

Contractor \_\_\_\_\_

Special Conditions 3 1/2" PVC

E/C Conduit

