



FALL CREEK REGIONAL WASTE DISTRICT

9378 S. 650 West PO Box 59
Pendleton, IN 46064-0059 778-7544

add order
on file

26-00092.00

APPLICATION FOR SEWER PERMIT

Nº 2731

Date 2/8/00

Permit Void 90 days from Date of Issuance

Owner Name Shirley Helber

Property Address 7033 S 600 W

Lot # _____ P.O. Box _____

Town Pendleton, IN Zip Code 46064

Phone _____ City Water _____ Well ☒

\$ 2556.00 Tap on Fee Paid 3-30-00

\$ _____ Inspection fee paid

Application is hereby made for connection to the Fall Creek Regional Waste District Sewer System for the above listed property - Permit Type: Residential ☒, Commercial _____, Industrial _____, or Governmental/Institutional _____. User Information _____.

All workmanship and materials shall conform to the standards of the District Ordinance as described in Ordinance 84-2 and 84-3 as amended. Acceptance and approval must be made by the District inspector or his duly authorized representative before backfilling and final connection is made to the main sewer lines. Any violation of applicable regulations will cause all lines and appurtenances in violation to be removed and replaced at the owners expense.

The Fall Creek Regional Waste District is responsible for the inspection, approval of materials, and installation techniques only. All costs for materials and installation and any liabilities resulting from same is the sole responsibility of the property owner.

I have read and fully understand the above provisions and agree to comply by said provisions.

APPLICANT(S) SIGNATURE _____

INSPECTOR [Signature]

Date inspected 2-8-00 Approved ☒ Rejected _____

Reason for rejection _____

Date reinspected _____ Approved _____ Rejected _____

Notes:

Size Pipe 4 "

Type Pipe PVC

Basement Yes _____ No ☒

Sump Pump Yes _____ No ☒

Downspout to Ground Yes ☒ No _____

Septic Tank Pumped & filled Yes _____ No ☒

Contractor M+M

Special Conditions _____

Existing Home _____

New Construction ☒

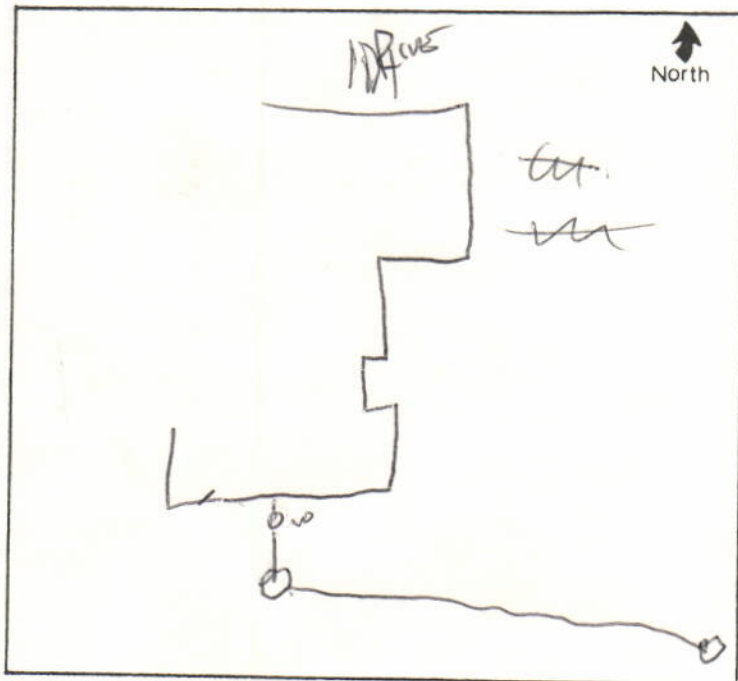

ROYAL HOMES, INC.
4801 E. 65TH STREET
INDIANAPOLIS, IN 46220

BANK ONE, INDIANA, N.A.
INDIANAPOLIS, IN 46277
20-1740

3245

3-30-00

PAY TO THE
ORDER OF

Full Creek Regional Waste
Two thousand five hundred fifty six

\$ 2556.00

No/100

DOLLARS

Security feature
included.
Details on back.

MEMO

Trap Fee

William H Bushfield II

⑈003245⑈ ⑆074000010⑆



