



FALL CREEK REGIONAL WASTE DISTRICT
9378 S. 650 West PO Box 59
Pendleton, IN 46064-0059 778-7544

APPLICATION FOR SEWER PERMIT

Nº 2606

Date 9-1-98

Permit Void 90 days from Date of Issuance

Owner Name Stephanie Owens (Ruth Neely)

Property Address 6712 SR 67

Lot # _____ P.O. Box _____

Town Pendleton, In, IN Zip Code 46064

Phone _____ City Water _____ Well _____

\$ N/A Tap on Fee Paid

\$ N/A Inspection fee paid

Application is hereby made for connection to the Fall Creek Regional Waste District Sewer System for the above listed property - Permit Type: Residential ☒, Commercial _____, Industrial _____, or Governmental/Institutional _____. User Information _____.

All workmanship and materials shall conform to the standards of the District Ordinance as described in Ordinance 84-2 and 84-3 as amended. Acceptance and approval must be made by the District inspector or his duly authorized representative before backfilling and final connection is made to the main sewer lines. Any violation of applicable regulations will cause all lines and appurtenances in violation to be removed and replaced at the owners expense.

The Fall Creek Regional Waste District is responsible for the inspection, approval of materials, and installation techniques only. All costs for materials and installation and any liabilities resulting from same is the sole responsibility of the property owner.

I have read and fully understand the above provisions and agree to comply by said provisions.

APPLICANT(S) SIGNATURE

INSPECTOR Tim

Date inspected 9-11-98 Approved ☒ Rejected _____

Reason for rejection _____

Date reinspected _____ Approved _____ Rejected _____

- Notes:
- Size Pipe 6"
 - Type Pipe SPR26 Class 160
 - Basement Yes _____ No ☒
 - Sump Pump Yes _____ No ☒
 - Downspout to Ground Yes ☒ No _____
 - Septic Tank Pumped & filled Yes ☒ No _____
 - Contractor Jerry Fredricks
 - Special Conditions Rental
 - Existing Home ☒
 - New Construction _____

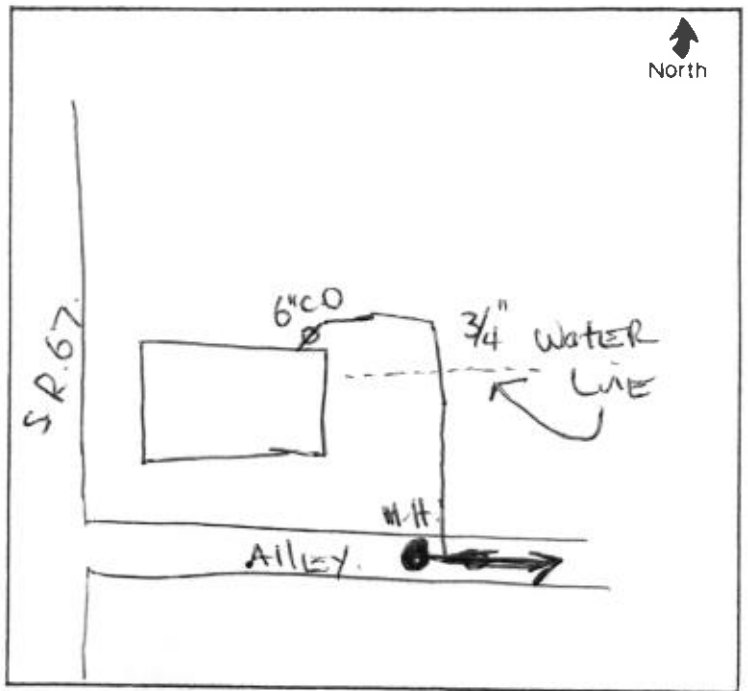

32-100000

U.S. DISTRICT COURT

U.S. DISTRICT COURT

No 5808

4-1-78

(great white) ...

...

...

...

A/H

A/H

...

...

...

...

...

...

...

...

...

...

...

...

...

...

...

...

...

...

...

