



FALL CREEK REGIONAL WASTE DISTRICT

Box 44, Pendleton, Indiana 46064

22-27100.00

Nº 001975

APPLICATION FOR SEWER PERMIT

Permit No. _____ Date 12/13/93

Permit Void 90 days from Date of Issuance

Owner Name Michael R. ScheckelhoffProperty Address 6242 Red Fox RoadLot # 43 P.O. Box _____Town Pendleton, IN Zip Code 46064Phone 778-8315 Water Meter _____\$ 350.00 Tap on Fee Paid availability fee 2,000.00 3/10/94\$ 25.00 Inspection fee paid inter. line fee 1243.50 3/10/94

Application is hereby made for connection to the Fall Creek Regional Waste District Sewer System for the above listed property - Permit Type: Residential ☒, Commercial _____, Industrial _____, or Governmental/Institutional _____. User Information _____.

All workmanship and materials shall conform to the standards of the District Ordinance as described in Ordinance 84-2 and 84-3 as amended. Acceptance and approval must be made by the District inspector or his duly authorized representative before backfilling and final connection is made to the main sewer lines. Any violation of applicable regulations will cause all lines and appurtenances in violation to be removed and replaced at the owners expense.

The Fall Creek Regional Waste District is responsible for the inspection, approval of materials, and installation techniques only. All costs for materials and installation and any liabilities resulting from same is the sole responsibility of the property owner.

I have read and fully understand the above provisions and agree to comply by said provisions.

X Michael Scheckelhoff
APPLICANT(S) SIGNATURE

INSPECTOR BDate inspected 1-10-94 Approved ☒ Rejected _____

Reason for rejection _____

Date reinspected _____ Approved _____ Rejected _____

Notes:

Size Pipe 6 "Type Pipe MC

Basement Yes _____ No _____

Sump Pump Yes _____ No _____

Downspout to Ground Yes _____ No _____

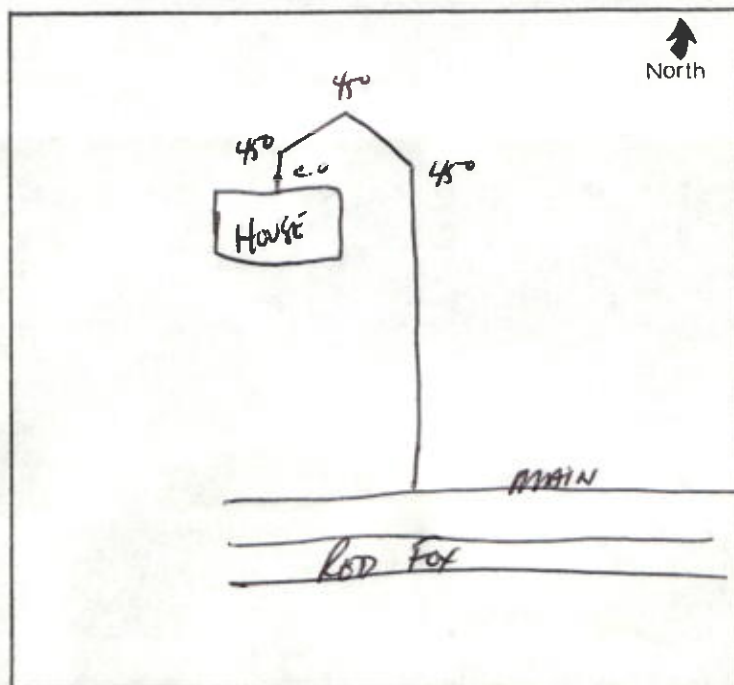
Septic Tank Pumped & filled Yes ☒ No _____Contractor Baker Const.Special Conditions New Const



FALL CREEK REGIONAL WASTE DISTRICT

Box 22, Fredonia, Indiana 46084

22-2715-0

No 001875

10/12/83

Michael A. Scheraga
1045 Fall Creek Road

32.00
32.00
Total due to the District \$64.00

Residential
Industrial
Commercial
Municipal

All connections to the district sewer system must be made within the time specified in the permit. The district is not responsible for the cost of the connection. The district is not responsible for the cost of the connection. The district is not responsible for the cost of the connection.

The Fall Creek Regional Waste District is responsible for the collection, treatment, and disposal of wastewater. The district is not responsible for the cost of the connection. The district is not responsible for the cost of the connection. The district is not responsible for the cost of the connection.

I have read and I agree with the terms of the permit and I agree to pay the amount due to the district.

Michael A. Scheraga

Signature

Date of payment \$64.00

Amount due to the district \$64.00

Amount due to the district \$64.00

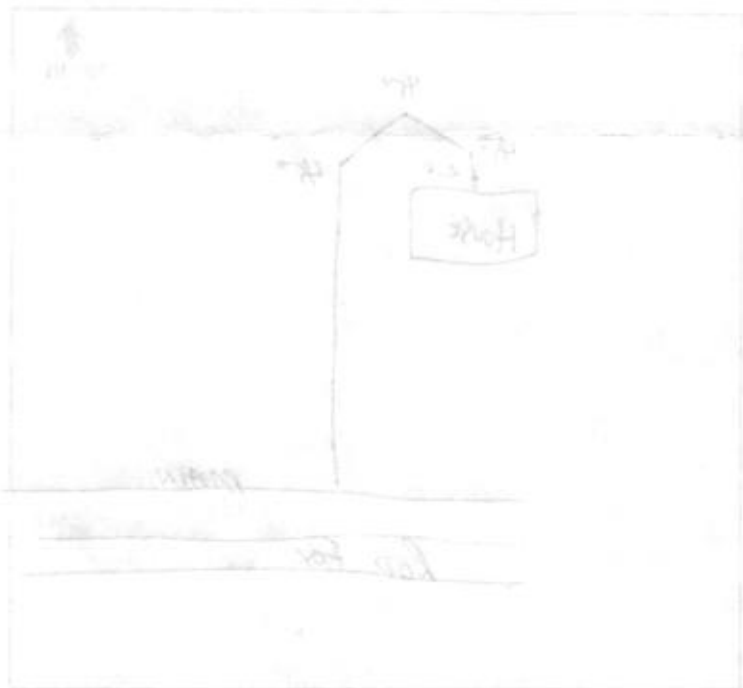

Septic Tank
Sewer Line
House