

FALL CREEK REGIONAL WASTE DISTRICT

9378 S 650 WEST, P.O. BOX 59, PENDLETON, IN 46064

765-778-7544

AGREEMENT FOR SANITARY SEWER SERVICE

This Agreement made and entered into this 14th day of May, 2003, between FALL CREEK REGIONAL WASTE DISTRICT ("District") and Riffey Builders ("Applicant") regarding the provision of sanitary sewer service, and the assignment of capacity in, and connection to, the District's facilities for the premises located at Lot #133 HHE.

NOW THEREFORE, the parties, in consideration of the mutual promises set out in this Agreement, the receipt and sufficiency of which is hereby acknowledged, agree as follows:

1. The Applicant agrees that all workmanship and materials shall conform to all District ordinances and the District's construction standards. District must accept and approve all work and materials before backfilling and final connection is made to the sewer mains. Any violation of this provision will cause all lines and appurtenances in violation to be removed and replaced at the Applicant's expense.
2. The District shall have the right to enter upon the Applicant's premises at all reasonable times to inspect, repair, or replace any equipment used in connection with the District's service or which has an impact on said service.
3. The Applicant shall be responsible for all monthly user rates, capacity charges, and tap fees. The failure to pay any rate charge or fee may result in a lien against the property and/or the termination of service to the property, the cost of which will be borne by Applicant, including, but not limited to, all attorney's fees and collection costs.
4. The District shall not be responsible for any damages as a result of any failure to supply service unless said damages are due to default, neglect or culpability on the part of the District.
5. If there is an available sanitary sewer within three hundred (300) feet of the property line, the property owner shall be required to connect to the District's sanitary sewer system.
6. The Applicant and District agree that the provision of sanitary sewer service touches and concerns the property and the terms of this Agreement bind the District and Applicant and their heirs, executors, administrators, personal representatives, successors, agents, attorneys, assigns, designees, and transferees.

The parties hereto have read and fully understand the above provisions and agree to comply with said provisions.

FALL CREEK REGIONAL WASTE DISTRICT

Signature

APPLICANT

Signature

STATE OF INDIANA)

) SS:

COUNTY OF MADISON)

SUBSCRIBED and sworn to before me this 14th day of May, 2003.

My Commission Expires:

4-29-09

Signature

Printed

Notary Public
Resident of Madison County

INSPECTOR Jan DATE INSPECTED 5-15-03 APPROVED ✓ REJECTED _____

REASON FOR REJECTION _____

DATE REINSPECTED _____

APPROVED _____

REJECTED _____

NOTES:

SIZE PIPE 6"

TYPE PIPE 35

BASEMENT YES

NO ✓

SUMP PUMP YES

NO ✓

DOWNSPOUT TO GROUND YES

NO ✓

SEPTIC TANK PUMPED & FILLED YES

NO ✓

CONTRACTOR Long/Kotter

SPECIAL CONDITIONS _____

EXISTING HOME _____

NEW CONSTRUCTION ✓

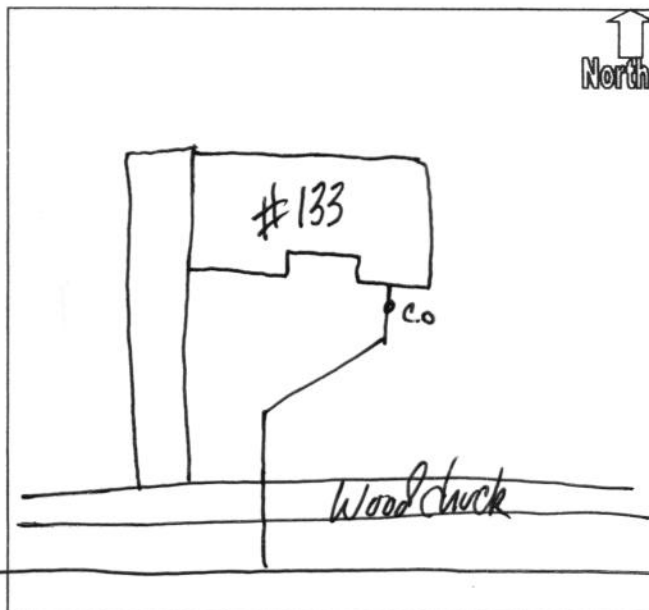

The first part of the paper is devoted to a discussion of the general principles of the theory of the structure of the atom. It is shown that the structure of the atom is determined by the laws of quantum mechanics, and that the laws of quantum mechanics are in agreement with the experimental facts.

In the second part of the paper, the author discusses the application of the theory of the structure of the atom to the study of the properties of matter. It is shown that the theory of the structure of the atom can be used to explain the properties of matter, and that the theory of the structure of the atom is in agreement with the experimental facts.

The third part of the paper is devoted to a discussion of the application of the theory of the structure of the atom to the study of the properties of matter. It is shown that the theory of the structure of the atom can be used to explain the properties of matter, and that the theory of the structure of the atom is in agreement with the experimental facts.

The fourth part of the paper is devoted to a discussion of the application of the theory of the structure of the atom to the study of the properties of matter. It is shown that the theory of the structure of the atom can be used to explain the properties of matter, and that the theory of the structure of the atom is in agreement with the experimental facts.

The fifth part of the paper is devoted to a discussion of the application of the theory of the structure of the atom to the study of the properties of matter. It is shown that the theory of the structure of the atom can be used to explain the properties of matter, and that the theory of the structure of the atom is in agreement with the experimental facts.



RIFFEY BUILDERS INC.

5205 S. 525W

PENDLETON, IN 46064-9174

71-553/749
7903383

933

DATE 5-14-03

PAY TO THE
ORDER OF

Trail Creek Regional Waste

\$ 475.⁰⁰

Four Hundred Seventy Five ⁰⁰/₁₀₀

DOLLARS  Security features
on back.



Madison
Community Bank

MEMO

Tap Fee (Behn)

William H Riffe MP

⑆074905539⑆ 790 338 3⑈ 0933

SAFETY PAPER

