

9378 S 650 WEST, P.O. BOX 59, PENDLETON, IN 46064

765-778-7544

AGREEMENT FOR SANITARY SEWER SERVICE

This Agreement made and entered into this 20th day of July, 2004, between FALL CREEK REGIONAL WASTE DISTRICT ("District") and Earl Wallace ("Applicant") regarding the provision of sanitary sewer service, and the assignment of capacity in, and connection to, the District's facilities for the premises located at 6190 S 425 West, Pendergast.

NOW THEREFORE, the parties, in consideration of the mutual promises set out in this Agreement, the receipt and sufficiency of which is hereby acknowledged, agree as follows:

1. The Applicant agrees that all workmanship and materials shall conform to all District ordinances and the District's construction standards. District must accept and approve all work and materials before backfilling and final connection is made to the sewer mains. Any violation of this provision will cause all lines and appurtenances in violation to be removed and replaced at the Applicant's expense.
2. The District shall have the right to enter upon the Applicant's premises at all reasonable times to inspect, repair, or replace any equipment used in connection with the District's service or which has an impact on said service.
3. The Applicant shall be responsible for all monthly user rates, capacity charges, and tap fees. The failure to pay any rate charge or fee may result in a lien against the property and/or the termination of service to the property, the cost of which will be borne by Applicant, including, but not limited to, all attorney's fees and collection costs.
4. The District shall not be responsible for any damages as a result of any failure to supply service unless said damages are due to default, neglect or culpability on the part of the District.
5. If there is an available sanitary sewer within three hundred (300) feet of the property line, the property owner shall be required to connect to the District's sanitary sewer system.
6. The Applicant and District agree that the provision of sanitary sewer service touches and concerns the property and the terms of this Agreement bind the District and Applicant and their heirs, executors, administrators, personal representatives, successors, agents, attorneys, assigns, designees, and transferees.

The parties hereto have read and fully understand the above provisions and agree to comply with said provisions.

FALL CREEK REGIONAL WASTE DISTRICT

Signature

APPLICANT

Signature

[illegible]

SUBSCRIBED and sworn to before me this 20th day of July, 2004

My Commission Expires: 2-20-2008

Signature

Printed

Notary Public

Resident of Madison County

INSPECTOR TK DATE INSPECTED 7/21/04 APPROVED ✓ REJECTED

REASON FOR REJECTION

DATE REINSPECTED _____ APPROVED _____ REJECTED _____

NOTES:

SIZE PIPE 1 1/2 TYPE PIPE 160 PSF

BASEMENT YES ☒ NO

SUMP PUMP YES **60**

DOWNSPOUT TO GROUND YES **NO**

SEPTIC TANK PUMPED & FILLED ☒ YES ☐ NO

CONTRACTOR LONG & KOFFER

SPECIAL CONDITIONS

EXISTING HOME

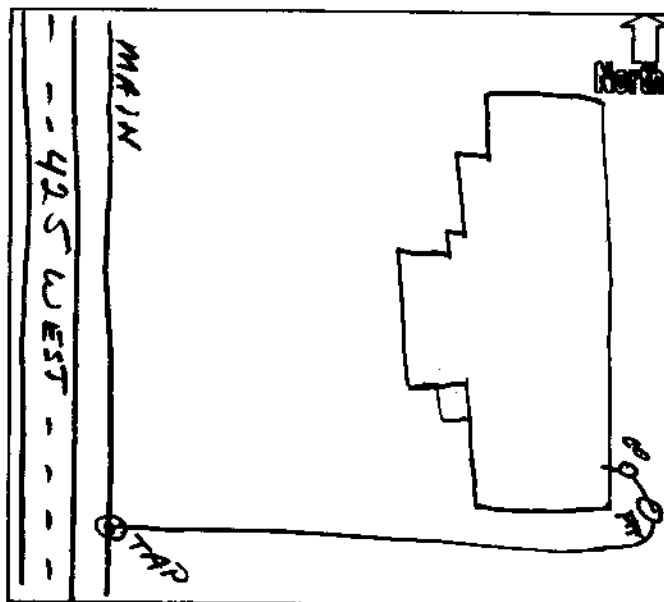
NEW CONSTRUCTION ☒



BRENDA M. WALLACE
EARL D. WALLACE
6190 SOUTH 425 WEST
PENDLETON, IN 46064

439

Date

6/9/04

25-80/440

Pay To The
Order Of

FCRWD

\$ 1549.72

Fifteen hundred forty nine and $\frac{72}{100}$

Dollars



Security features
included.
Check on back

PRO-CASH PLUS® ACCOUNT

BANK ONE. BANK ONE, NA COLUMBUS, OHIO 43271



Memo

Earl Wallace

⑆044000804⑆

1:0440008041: