



FALL CREEK REGIONAL WASTE DISTRICT

Box 44, Pendleton, Indiana 46064 (317) 638-3355

Williatte, Ken. Cont. Inc.
Wayne Jones
Project Manager
2515 Bloyd Ave
Pendleton, IN 46218

10-23830.00

No 001772

APPLICATION FOR SEWER PERMIT

Permit No. _____ Date Nov 26, 1990

Permit Void 90 days from Date of Issuance

Owner Name Pendleton Library

Property Address 595 E Water

Lot # _____ P.O. Box _____

Town Pendleton, IN Zip Code 46064

Phone _____ Water Meter _____

\$ 500.00 Tap on Fee Paid (#500.00)

\$ 25.00 Inspection fee paid (#25.00)

To be paid
\$525.00

Application is hereby made for connection to the Fall Creek Regional Waste District Sewer System for the above listed property - Permit Type: Residential _____, Commercial _____, Industrial _____, or Governmental/Institutional X. User Information _____.

All workmanship and materials shall conform to the standards of the District Ordinance as described in Ordinance 84-2 and 84-3 as amended. Acceptance and approval must be made by the District inspector or his duly authorized representative before backfilling and final connection is made to the main sewer lines. Any violation of applicable regulations will cause all lines and appurtenances in violation to be removed and replaced at the owners expense.

The Fall Creek Regional Waste District is responsible for the inspection, approval of materials, and installation techniques only. All costs for materials and installation and any liabilities resulting from same is the sole responsibility of the property owner.

I have read and fully understand the above provisions and agree to comply by said provisions.

X Wayne Jones (for Williatte)
APPLICANT(S) SIGNATURE

INSPECTOR B

Date inspected ? Approved ✓ Rejected _____

Reason for rejection _____

Date reinspected _____ Approved _____ Rejected _____

Notes:

Size Pipe 6 "

Type Pipe PVC

Basement Yes _____ No X

Sump Pump Yes _____ No X

Downspout to Ground Yes X No _____

Septic Tank Pumped & filled Yes _____ No X

Contractor Unknown

Special Conditions _____

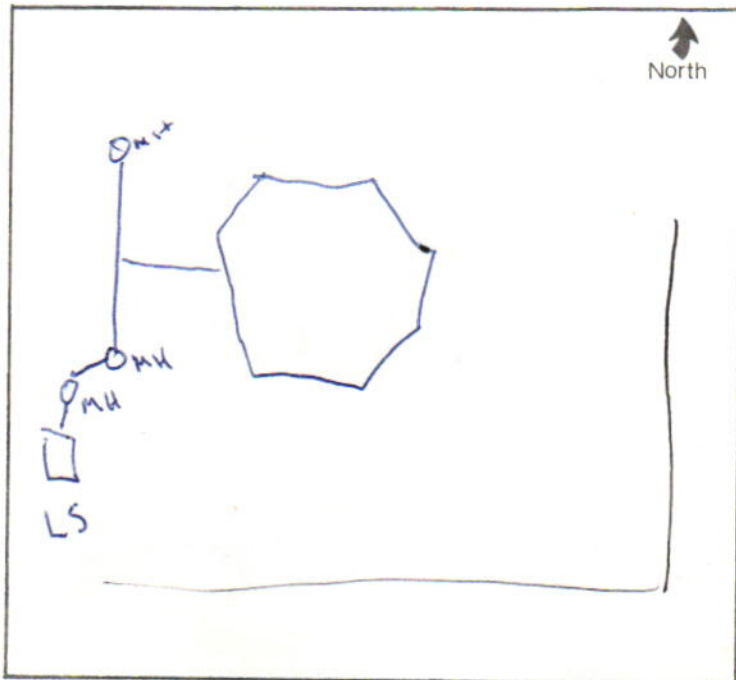

6" Brick Screen Wall

C4

Pendleton Library

Structure No. 8

Structure No. 7

58 LF of 6" PVC @ 1% Slope

Structure No. 6

100C

Comp. Box
w/Steel Lid

Sanitary MH

Water Meter (typ)

Sanitary MH

Sanitary MH

Gas Meter

Inv. Out 850.35
12 LF of 4" PVC @ .5% Slope

120 LF of 8" RCP @ .5% Slope

A39 VIA LC-1
3/4" C₁(2) #12 + GND.

15 LF of 4" PVC @ .5% Slope

Sanitary MH
Inv. In 849.75

Sanitary MH

Power Pole

Electric Supply

5' Conc. Walk (by others)

Water Street

HE/OHT

Water Meter (typ)

Water Meter

Structure No. 5

