

FALL CREEK REGIONAL WASTE DISTRICT

9378 S 650 WEST, P.O. BOX 59, PENDLETON, IN 46064
765-778-7544

AGREEMENT FOR SANITARY SEWER SERVICE

This Agreement made and entered into this 23rd day of April, 2001, between FALL CREEK REGIONAL WASTE DISTRICT ("District") and Gerry Beuloy ("Applicant") regarding the provision of sanitary sewer service, and the assignment of capacity in, and connection to, the District's facilities for the premises located at 5917 Douglas Way

NOW THEREFORE, the parties, in consideration of the mutual promises set out in this Agreement, the receipt and sufficiency of which is hereby acknowledged, agree as follows:

1. The Applicant agrees that all workmanship and materials shall conform to all District ordinances and the District's construction standards. District must accept and approve all work and materials before backfilling and final connection is made to the sewer mains. Any violation of this provision will cause all lines and appurtenances in violation to be removed and replaced at the Applicant's expense.
2. The District shall have the right to enter upon the Applicant's premises at all reasonable times to inspect, repair, or replace any equipment used in connection with the District's service or which has an impact on said service.
3. The Applicant shall be responsible for all monthly user rates, capacity charges, and tap fees. The failure to pay any rate charge or fee may result in a lien against the property and/or the termination of service to the property, the cost of which will be borne by Applicant, including, but not limited to, all attorney's fees and collection costs.
4. The District shall not be responsible for any damages as a result of any failure to supply service unless said damages are due to default, neglect or culpability on the part of the District.
5. If there is an available sanitary sewer within three hundred (300) feet of the property line, the property owner shall be required to connect to the District's sanitary sewer system.
6. The Applicant and District agree that the provision of sanitary sewer service touches and concerns the property and the terms of this Agreement bind the District and Applicant and their heirs, executors, administrators, personal representatives, successors, agents, attorneys, assigns, designees, and transferees.

The parties hereto have read and fully understand the above provisions and agree to comply with said provisions.

FALL CREEK REGIONAL WASTE DISTRICT

Signature [Signature]

APPLICANT

Signature [Signature]

STATE OF INDIANA)

) SS:

COUNTY OF MADISON)

SUBSCRIBED and sworn to before me this 23rd day of April, 2001.

My Commission Expires:

4-19-2008

Signature [Signature]

Printed Teresa K Hutton

Notary Public

Resident of Madison County

INSPECTOR B DATE INSPECTED 7-3-1 APPROVED ✓ REJECTED _____

REASON FOR REJECTION _____

DATE REINSPECTED _____ APPROVED _____ REJECTED _____

NOTES:

SIZE PIPE 6 TYPE PIPE 35'

BASEMENT YES _____ NO ✓

SUMP PUMP YES _____ NO ✓

DOWNSPOUT TO GROUND YES X NO _____

SEPTIC TANK PUMPED & FILLED YES X NO _____

CONTRACTOR GERRY'S

SPECIAL CONDITIONS _____

EXISTING HOME X

NEW CONSTRUCTION _____

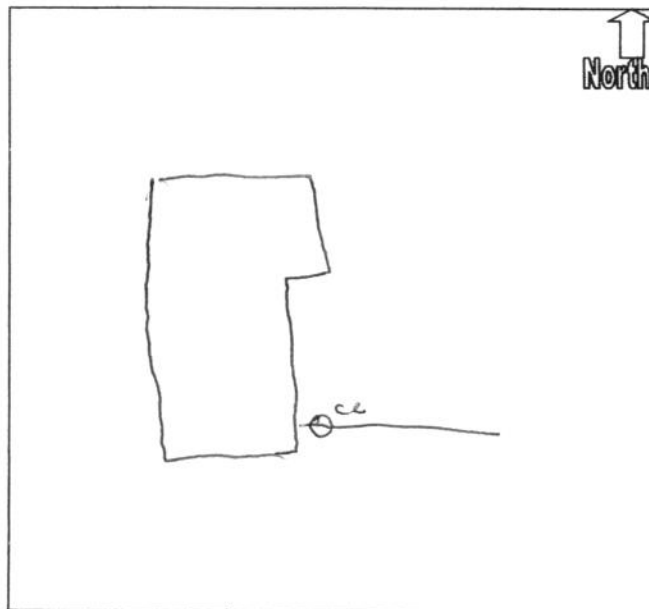

MARY G BEUOY
JERRY L BEUOY
5917 DOUGLAS WAY
ANDERSON, IN 46013

DATE



9-23-01

141

71-167/749
BRANCH 10006

PAY TO THE
ORDER OF

FCRWD

\$ 400.00

Four hundred and 00/100

DOLLARS ☐ Security feat:
included
Details on b



STAR
Financial Bank

GENERATIONS GOLD MEMBER

FOR

Tap Fee

JRK

MP

⑆074901672⑆1414

⑈123 24129⑈