



FALL CREEK REGIONAL WASTE DISTRICT

Box 44, Pendleton, Indiana 46064

2-0007300

Nº 001080

APPLICATION FOR SEWER PERMIT

Permit No. \_\_\_\_\_ Date 12-26-85  
Permit Void 90 days from Date of Issuance  
Owner Name DONALD L. Hummel  
Property Address 432 Imy LANE  
Lot # \_\_\_\_\_ P.O. Box \_\_\_\_\_  
Town ANDERSON, IN Zip Code 46013  
Phone 317-463-5269 Water Meter \_\_\_\_\_  
\$ 150<sup>00</sup> Tap on Fee Paid  
\$ 25<sup>00</sup> Inspection fee paid

3343 Peppermill L  
West Lafayette, IN  
47906

Application is hereby made for connection to the Fall Creek Regional Waste District Sewer System for the above listed property - Permit Type: Residential ☒, Commercial \_\_\_\_\_, Industrial \_\_\_\_\_, or Governmental/Institutional \_\_\_\_\_. User Information \_\_\_\_\_.

All workmanship and materials shall conform to the standards of the District Ordinance as described in Ordinance 84-2 and 84-3 as amended. Acceptance and approval must be made by the District inspector or his duly authorized representative before backfilling and final connection is made to the main sewer lines. Any violation of applicable regulations will cause all lines and appurtenances in violation to be removed and replaced at the owners expense.

The Fall Creek Regional Waste District is responsible for the inspection, approval of materials, and installation techniques only. All costs for materials and installation and any liabilities resulting from same is the sole responsibility of the property owner.

I have read and fully understand the above provisions and agree to comply by said provisions.

✓

APPLICANT(S) SIGNATURE

\*\*\*\*\*

INSPECTOR

Date inspected 1-14 Approved [Signature] Rejected \_\_\_\_\_  
Reason for rejection \_\_\_\_\_

Date reinspected \_\_\_\_\_ Approved \_\_\_\_\_ Rejected \_\_\_\_\_

Notes:

Size Pipe 6 "

Type Pipe PVC

Basement Yes \_\_\_\_\_ No ☒

Sump Pump Yes \_\_\_\_\_ No ☒

Downspout to Ground Yes ☒ No \_\_\_\_\_

Septic Tank Pumped & filled Yes \_\_\_\_\_ No ☒

Contractor DRP

Special Conditions

PIECE OF 12" CONCRETE  
DRAIN TILE FOUND IN  
TRENCH AT CONNECTION  
NOT FIXED

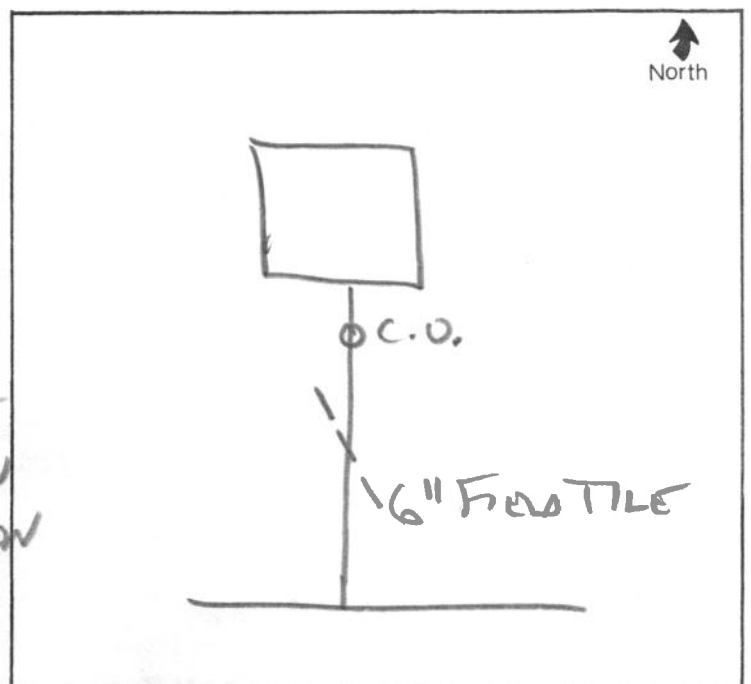

600