



# FALL CREEK REGIONAL WASTE DISTRICT

9378 S. 650 West PO Box 59  
Pendleton, IN 46064-0059 778-7544

13-86017.00

WO#9938

## APPLICATION FOR SEWER PERMIT

No 2698

Date 8/24/99

Permit Void 90 days from Date of Issuance

Owner Name Tractor Supply

Property Address 320 Enterprise Dr.

Lot # \_\_\_\_\_ P.O. Box \_\_\_\_\_

Town Pendleton, IN Zip Code 46064

Phone \_\_\_\_\_ City Water ☒ Well \_\_\_\_\_

\$ 400.00 Tap on Fee Paid

\$ 46510.00 capacity ~~inspection~~ fee paid

Application is hereby made for connection to the Fall Creek Regional Waste District Sewer System for the above listed property - Permit Type: Residential \_\_\_\_\_, Commercial \_\_\_\_\_, Industrial \_\_\_\_\_, or Governmental/Institutional \_\_\_\_\_. User Information \_\_\_\_\_.

All workmanship and materials shall conform to the standards of the District Ordinance as described in Ordinance 84-2 and 84-3 as amended. Acceptance and approval must be made by the District inspector or his duly authorized representative before backfilling and final connection is made to the main sewer lines. Any violation of applicable regulations will cause all lines and appurtenances in violation to be removed and replaced at the owners expense.

The Fall Creek Regional Waste District is responsible for the inspection, approval of materials, and installation techniques only. All costs for materials and installation and any liabilities resulting from same is the sole responsibility of the property owner.

I have read and fully understand the above provisions and agree to comply by said provisions.

APPLICANT(S) SIGNATURE

\*\*\*\*\*

INSPECTOR Tim

Date inspected 10-1-99 Approved ☒ Rejected \_\_\_\_\_

Reason for rejection \_\_\_\_\_

Date reinspected \_\_\_\_\_ Approved \_\_\_\_\_ Rejected \_\_\_\_\_

Notes:

Size Pipe 6"

Type Pipe SDR35

Basement Yes \_\_\_\_\_ No ☒

Sump Pump Yes \_\_\_\_\_ No ☒

Downspout to Ground Yes ☒ No \_\_\_\_\_

Septic Tank Pumped & filled Yes \_\_\_\_\_ No \_\_\_\_\_

Contractor Ponderexter

Special Conditions \_\_\_\_\_

Existing Home \_\_\_\_\_

New Construction ☒

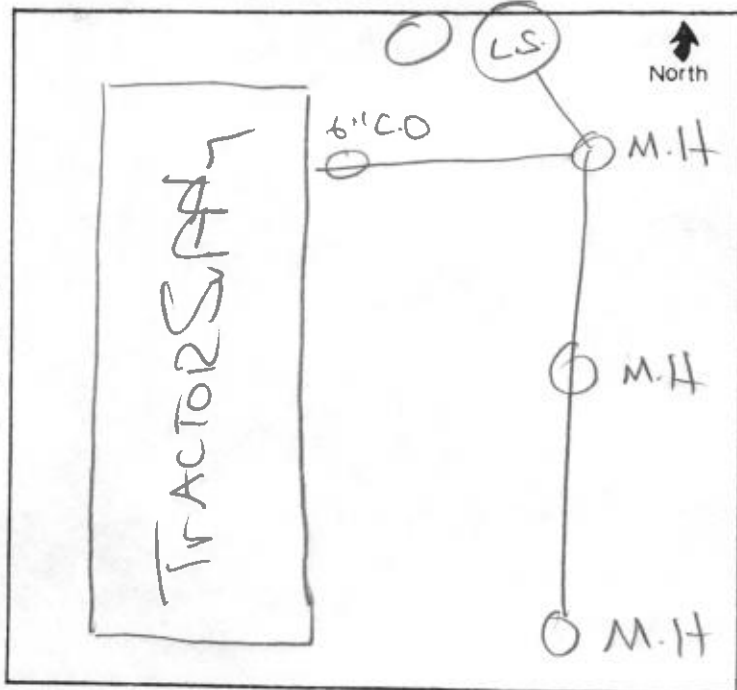



2008

CHECK DATE:

8-23-99

CHECK NO.

55886

INVOICE	INV DATE	DESCRIPTION	GROSS AMOUNT	ADJUSTMENTS	NET AMOUNT
82399-01	8-23-99	Sewer tap fee			\$46,910.00
VENDOR NO.	VENDOR NAME	TOTAL GROSS	TOTAL ADJ.	TOTAL NET	
	Fall Creek Regional Waste District				\$46,910.00

## GREENFIELD BUILDERS, INC.

215 W. NEW RD., SUITE 200  
GREENFIELD, IN 46140  
317-462-3263

NBD Bank, N.A.

20-5  
740

055886

THE SUM 46910 DOLLARS CTS

8-23-99

55886  
CHECK NO.

\$46,910.00  
AMOUNT

PAY  
TO THE  
ORDER  
OF

Fall Creek Regional Waste District

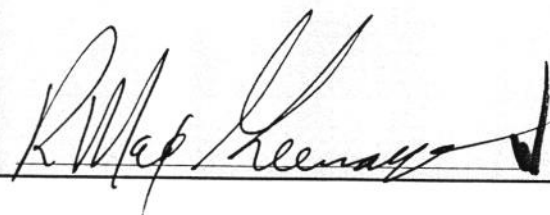

⑈055886⑈ ⑆074000052⑆ 700032008791⑈



Steve -

6/29

Preliminary estimates - new  
TSC Facility:

Office - 7.6 edu's  
WHSE - 16.9 "

TOTAL 24.5 edu's

x \$ 350

---

\$ 8,575 Reimbursement  
to Mr.  
PAUL

THANKS -

*De*