



FALL CREEK REGIONAL WASTE DISTRICT

Box 44, Pendleton, Indiana 46064

3-0203887-00

Nº 001615

APPLICATION FOR SEWER PERMIT

Permit No. \_\_\_\_\_ Date 7-7-87

Permit Void 90 days from Date of Issuance

Owner Name MAXINE SNODGRASSE (234 Jefferson Pend.)

Property Address 320 Adams St

Lot # \_\_\_\_\_ P.O. Box \_\_\_\_\_

Town Pendleton, IN Zip Code 46064

Phone 778-2231 Water Meter Pend.

\$ 1500.00 Tap on Fee Paid

\$ 25.00 Inspection fee paid

Application is hereby made for connection to the Fall Creek Regional Waste District Sewer System for the above listed property - Permit Type: Residential ☒, Commercial \_\_\_\_\_, Industrial \_\_\_\_\_, or Governmental/Institutional \_\_\_\_\_. User Information \_\_\_\_\_.

All workmanship and materials shall conform to the standards of the District Ordinance as described in Ordinance 84-2 and 84-3 as amended. Acceptance and approval must be made by the District inspector or his duly authorized representative before backfilling and final connection is made to the main sewer lines. Any violation of applicable regulations will cause all lines and appurtenances in violation to be removed and replaced at the owners expense.

The Fall Creek Regional Waste District is responsible for the inspection, approval of materials, and installation techniques only. All costs for materials and installation and any liabilities resulting from same is the sole responsibility of the property owner.

I have read and fully understand the above provisions and agree to comply by said provisions.

Maxine Snodgrass  
APPLICANT(S) SIGNATURE

\*\*\*\*\*

INSPECTOR Bur

Date inspected 7-17-87 Approved ☒ Rejected \_\_\_\_\_

Reason for rejection \_\_\_\_\_

Date reinspected \_\_\_\_\_ Approved \_\_\_\_\_ Rejected \_\_\_\_\_

Notes:  
Size Pipe 6 "  
Type Pipe PVC  
Basement Yes \_\_\_\_\_ No ☒  
Sump Pump Yes \_\_\_\_\_ No ☒  
Downspout to Ground Yes ☒ No \_\_\_\_\_  
Septic Tank Pumped & filled Yes \_\_\_\_\_ No ☒  
Contractor Holt / Jim Fisher  
Special Conditions \_\_\_\_\_

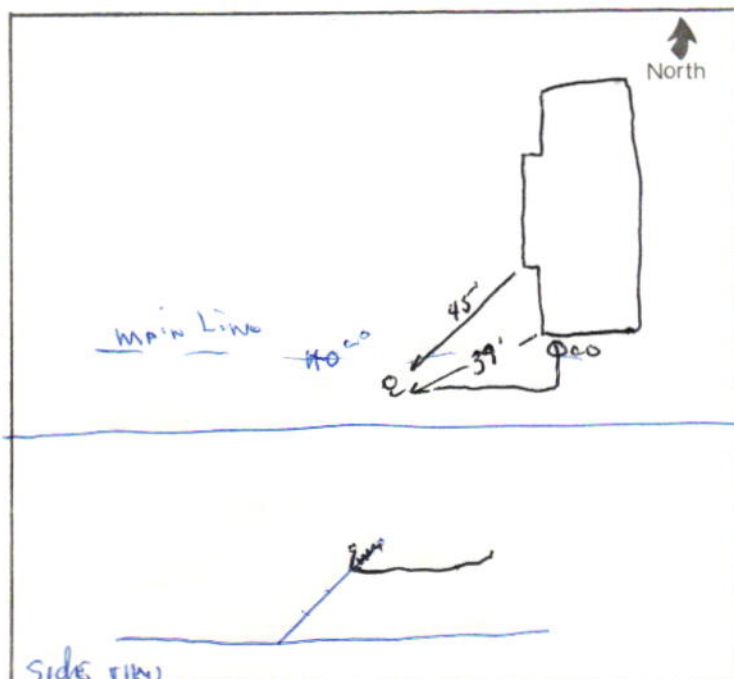

Gidw.

PROJECT Phase II

SHEET \_\_\_\_\_ OF \_\_\_\_\_

SUBJECT \_\_\_\_\_

DATE 4-10-18

JOB NO. 4447

BY ALIAS

320 S. Adams

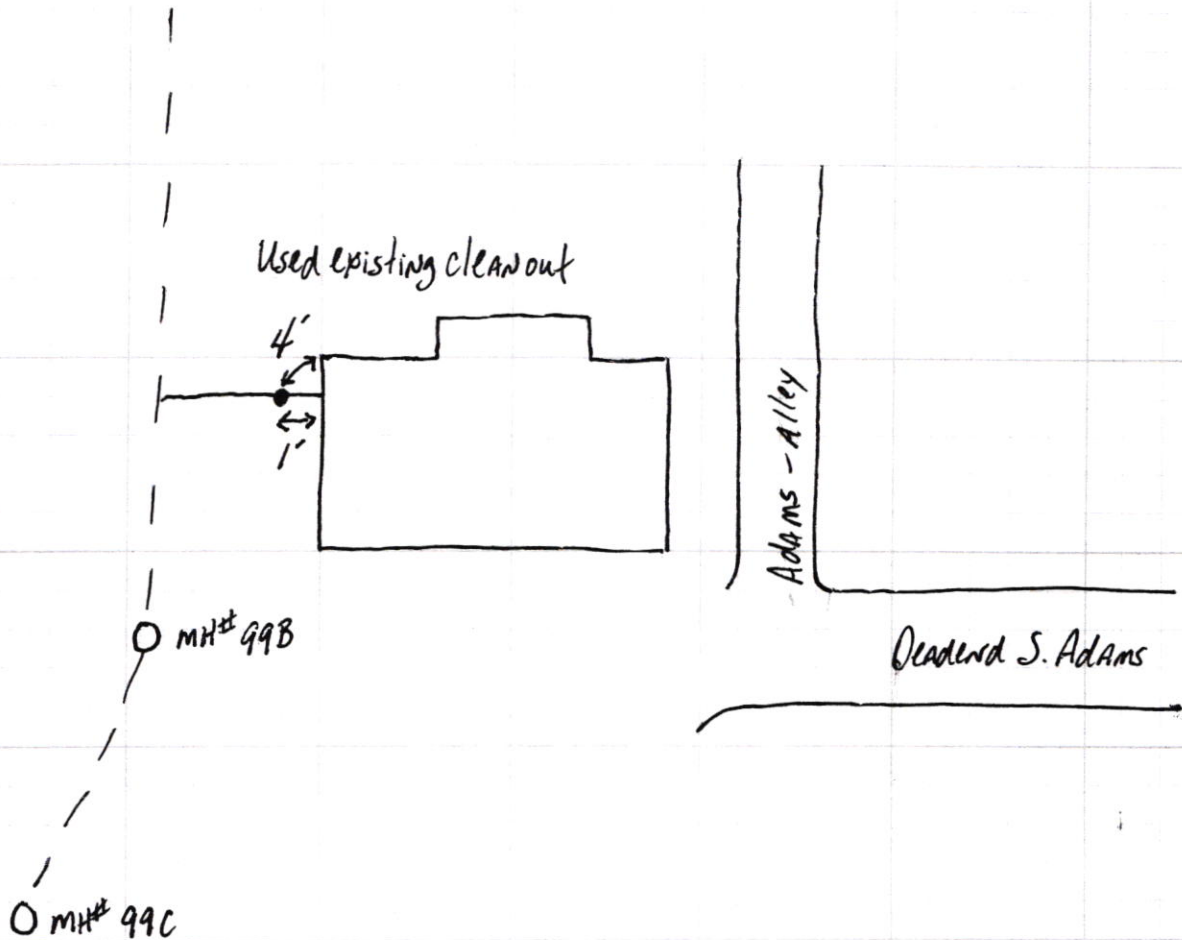



320 S Adams

SRF  
Phase II

4.11.18

