

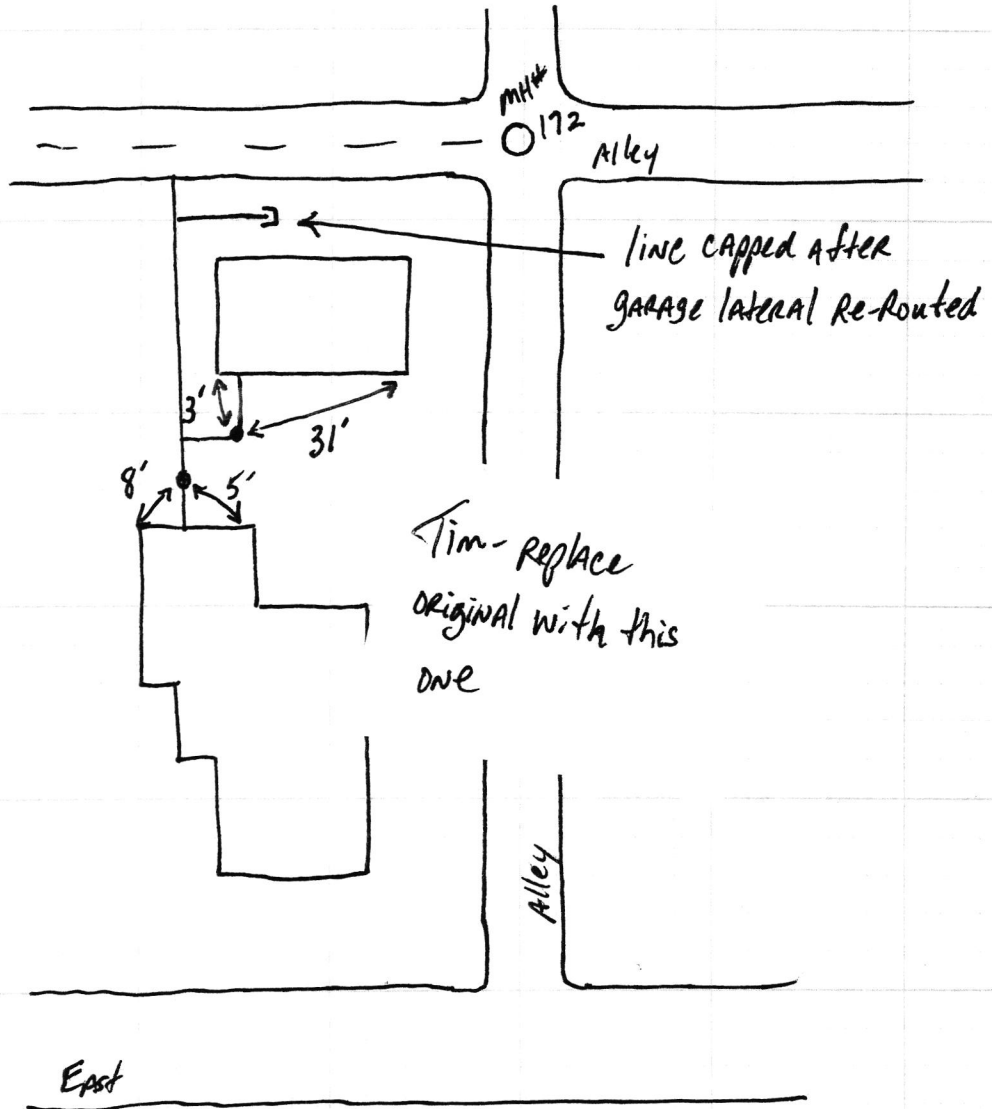

PROJECT Phase II SHEET \_\_\_\_\_ OF \_\_\_\_\_  
SUBJECT \_\_\_\_\_ DATE 6-2-18  
JOB NO. 4447  
BY Atlas

318 S. East - revised

N →



## Becca Hunter

---

**From:** Hutchens, Jack <JHutchens@grwinc.com>  
**Sent:** Monday, June 11, 2018 1:27 PM  
**To:** Becca Hunter  
**Subject:** Pic  
**Attachments:** 318 S East 2.JPG

Becca, replace your picture at 318 S East no. 2 for this one. This clean out location was moved. Thanks, more to follow.

**Jack Hutchens**

**GRW** | [engineering](#) | [architecture](#) | [geospatial](#)

9001 N. Wesleyan Road, Suite 200 | Indianapolis, IN 46268

P 317.347.3650

Email: [JHutchens@grwinc.com](mailto:JHutchens@grwinc.com) | Website: [www.grwinc.com](http://www.grwinc.com)



318 S East St (Replacement - Clean out moved)

SAT Phase II

6.11.18

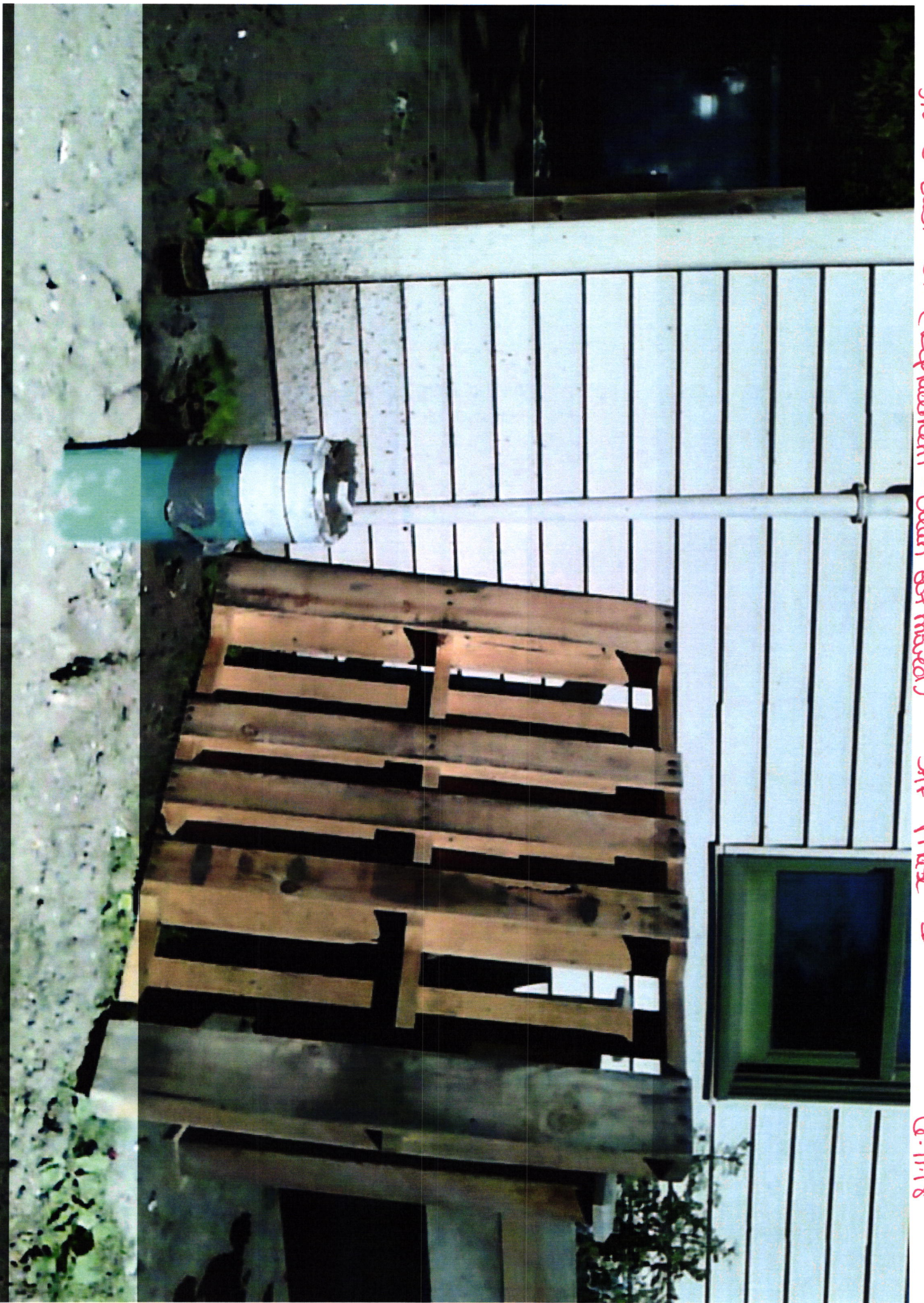



Gidw.

PROJECT Phase II SHEET \_\_\_\_\_ OF \_\_\_\_\_  
SUBJECT \_\_\_\_\_ DATE 3-6-18  
JOB NO. 4447  
BY Atlas

318 S. East

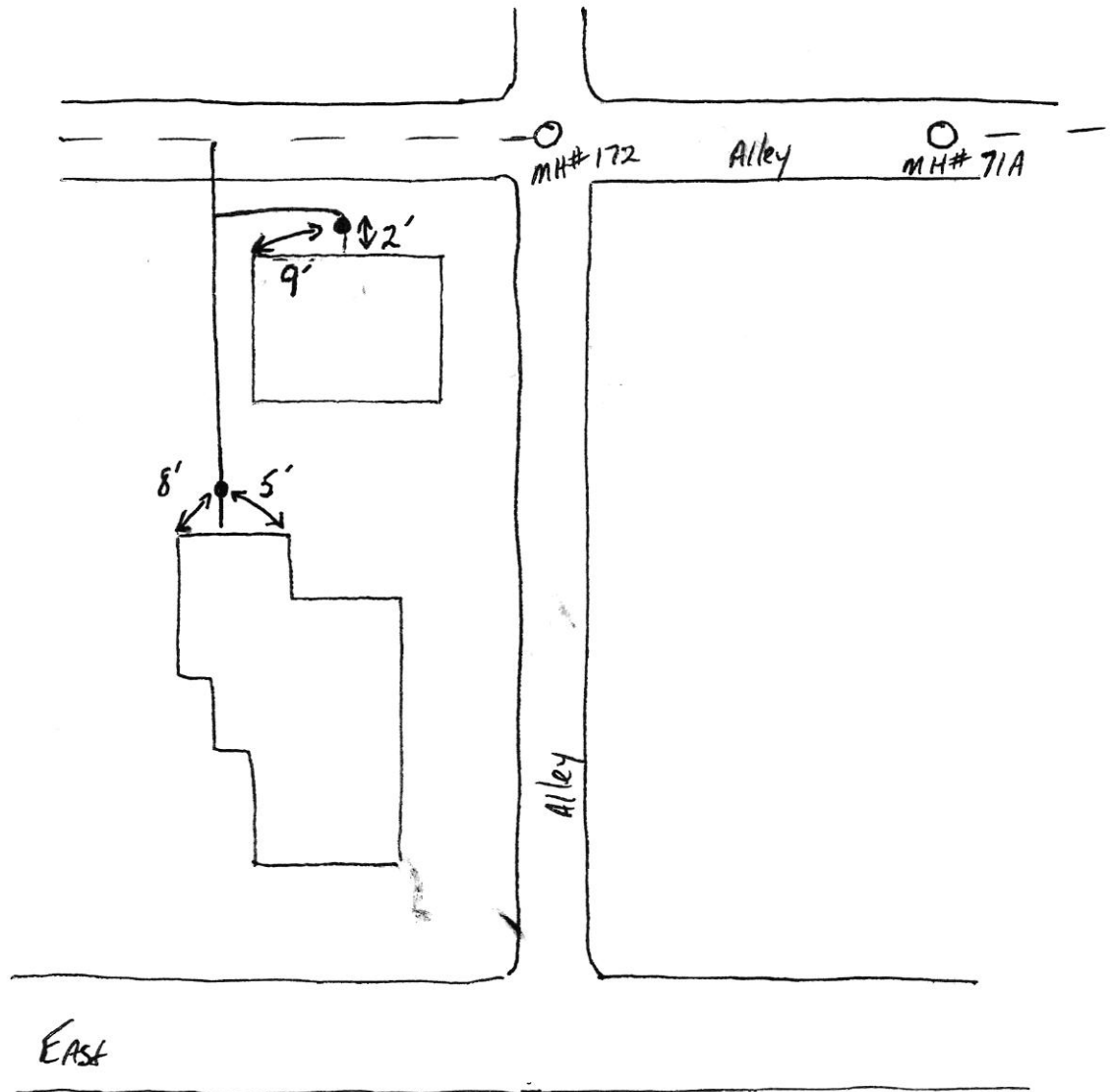

318 E East

SRP Phase II





318 2 East

SRP Phase II

