



FALL CREEK REGIONAL WASTE DISTRICT

9378 S. 650 West PO Box 59  
Pendleton, IN 46064-0059 778-7544

23-01300.00

APPLICATION FOR SEWER PERMIT

Nº 2586

Date 8-17-98

Permit Void 90 days from Date of Issuance

Owner Name Stephen T Goodrich

Property Address 3008 W Market St.

Lot # \_\_\_\_\_ P.O. Box \_\_\_\_\_

Town Pendleton, IN Zip Code 46064

Phone (765) 778-3413 City Water \_\_\_\_\_ Well X

\$ N/A Tap on Fee Paid

\$ N/A Inspection fee paid

Application is hereby made for connection to the Fall Creek Regional Waste District Sewer System for the above listed property - Permit Type: Residential ✓, Commercial \_\_\_\_\_, Industrial \_\_\_\_\_, or Governmental/Institutional \_\_\_\_\_. User Information \_\_\_\_\_.

All workmanship and materials shall conform to the standards of the District Ordinance as described in Ordinance 84-2 and 84-3 as amended. Acceptance and approval must be made by the District inspector or his duly authorized representative before backfilling and final connection is made to the main sewer lines. Any violation of applicable regulations will cause all lines and appurtenances in violation to be removed and replaced at the owners expense.

The Fall Creek Regional Waste District is responsible for the inspection, approval of materials, and installation techniques only. All costs for materials and installation and any liabilities resulting from same is the sole responsibility of the property owner.

I have read and fully understand the above provisions and agree to comply by said provisions.

Stephen T Goodrich  
APPLICANT(S) SIGNATURE

\*\*\*\*\*

INSPECTOR [Signature]

Date inspected 8-10-98 Approved \_\_\_\_\_ Rejected \_\_\_\_\_

Reason for rejection \_\_\_\_\_

Date reinspected \_\_\_\_\_ Approved \_\_\_\_\_ Rejected \_\_\_\_\_

Notes:

Size Pipe 6 "

Type Pipe PVC 160

Basement Yes \_\_\_\_\_ No X

Sump Pump Yes \_\_\_\_\_ No X

Downspout to Ground Yes X No \_\_\_\_\_

Septic Tank Pumped & filled Yes X No \_\_\_\_\_

Contractor M+M

Special Conditions \_\_\_\_\_

Existing Home X

New Construction \_\_\_\_\_

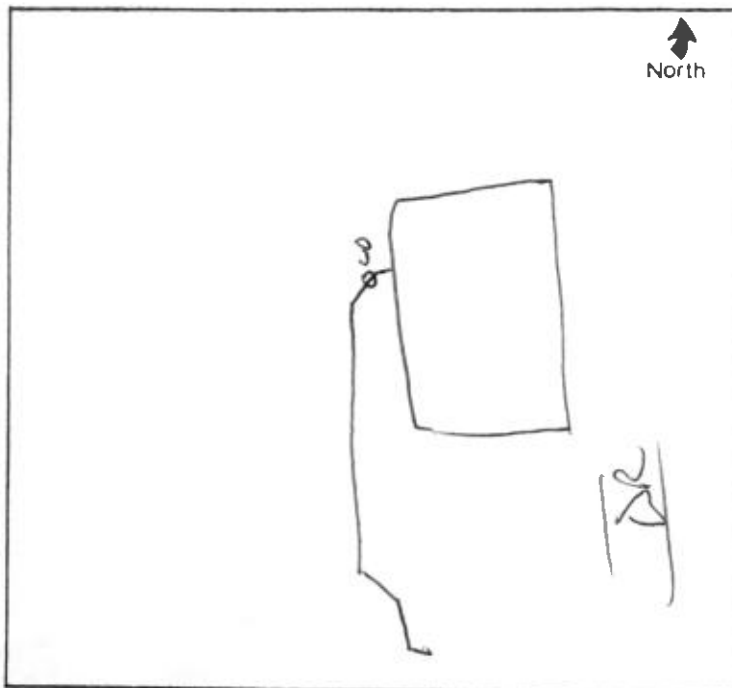



LOCAL COUNCIL

H. J. LONDON

1925

1926

1927

1928

1929

1930

1931

1932

1933

1934

1935

1936

1937

1938

1939

1940

1941

1942

1943

1944



1945

1946

1947