

8-11241.00

Fall Creek Regional Waste District

#7289

9378 S 650 W, P.O. Box 59, Pendleton, IN 46064

765-778-7544

Agreement for Sanitary Sewer Service

This Agreement made and entered into this 5 day of May, 2021, between Fall Creek Regional Waste District ("District") and D.R. Horton ("Applicant") regarding the provision of sanitary sewer service, and the assignment of capacity in and connection to, the District's facilities for the premises located at Carrick Glen Lot 71.

Street Address: 292 30th Limerick Lane

Now therefore, the parties, in consideration of the mutual promises set out in this Agreement, the receipt and sufficiency of which is hereby acknowledged, agree as follows:

1. The Applicant agrees that all workmanship and materials shall conform to all District ordinances and the District's construction standards. District must accept and approve all work and materials before backfilling and final connection is made to the sewer mains. Any violation of this provision will cause all lines and appurtenances in violation to be removed and replaced at the Applicant's expense.
2. The District shall have the right to enter upon the Applicant's premises at all reasonable times to inspect, repair, or replace any equipment used in connection with the District's service or which has an impact on said service.
3. The Applicant shall be responsible for all monthly user rates, capacity charges, and tap fees. The failure to pay any rate charge or fee may result in a lien against the property and/or the termination of service to the property, the cost of which will be borne by Applicant, including, but not limited to, all attorney's fees and collection costs.
4. The District shall not be responsible for any damages as a result of any failure to supply service unless said damages are due to default, neglect or culpability on the part of the District.
5. If there is an available sanitary sewer within three hundred (300) feet of the property line, the property owner shall be required to connect to the District's sanitary sewer system.
6. The Applicant and District agree that the provision of sanitary sewer service touches and concerns the property and the terms of this Agreement bind the District and Applicant and their heirs, executors, administrators, personal representatives, successors, agents, attorneys, assigns, designees, and transferees.

The parties hereto have read and fully understand the above provisions and agree to comply with said provisions.

FALL CREEK REGIONAL WASTE DISTRICT

Signature

APPLICANT

Signature

STATE OF INDIANA)
) SS:
COUNTY OF MADISON)

SUBSCRIBED and sworn to before me this 5 day of May, 2021

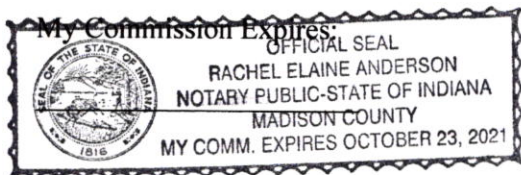

Signature Rachel E. Anderson

Printed Rachel E. Anderson

Notary Public
Resident of Madison County

Inspector Don Date Inspected 9-1-21 Approved ☒ Rejected ☐
Reason for Rejection _____

Date Reinspected _____ Approved _____ Rejected _____

Notes:
Size Pipe 6" Type Pipe PVC 35
Basement Yes No
Sump Pump Yes No
Downspout to Ground Yes No
Septic Tank Pumped & Filled Yes No
Contractor _____
Special Conditions _____
Existing Home ☒
New Construction ☒

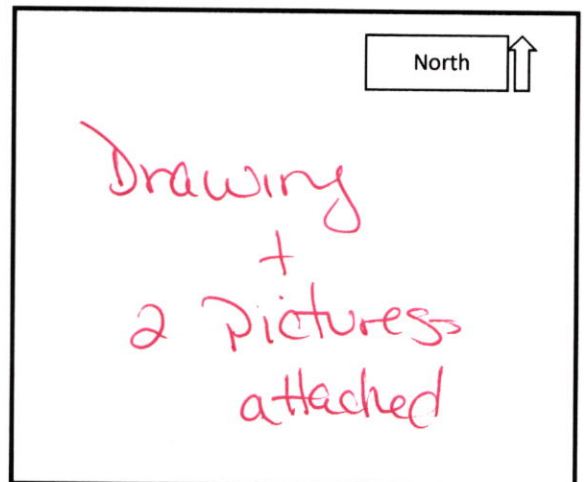



STOEPPELWERTH

ALWAYS ON

7965 East 106th Street, Fishers, IN 46038-2505
phone: 317.849.5935 fax: 317.849.5942

JOB ID CARG2.71

CONTROL# 97829 DRH

306 LIMERICK LANE
PENDLETON, IN 46064

1" = 30'

LOT AREA: 7,360 Sq. Ft.

LOT COVERAGE=35.2%

M.L.A.G.=872.4

M.F.F.=872.9

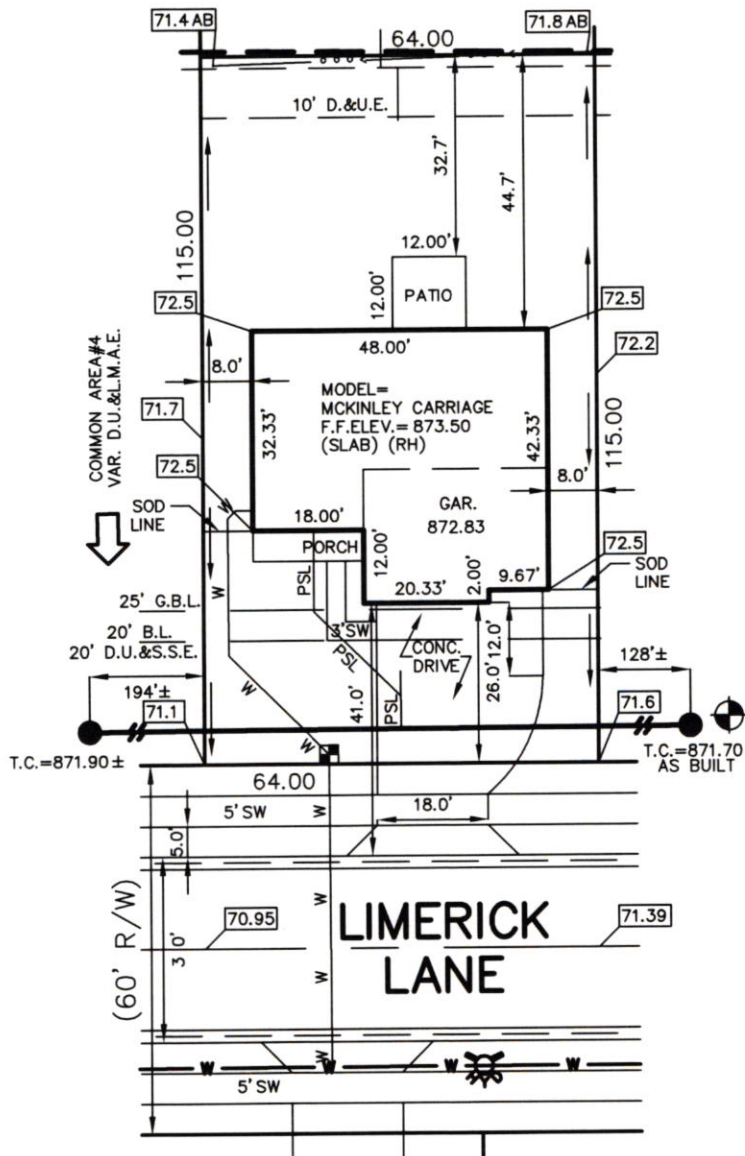

LEGEND:

- | | |
|-------------|---|
| XX.X | PROPOSED GRADE PER PLAN |
| XX.XAB | AS BUILT GRADE |
| S.S.D. | SUB-SURFACE DRAIN |
| AS | SANITARY SEWER |
| PSL | 6" AS BUILT SANITARY LATERAL |
| PSL | 6" PROPOSED SANITARY LATERAL |
| W | STORM SEWER |
| W | 3/4" WATER CONNECTION |
| W | WATER MAIN |
| ... | SWALE |
| ● | SANITARY MANHOLE |
| ○ | STORM MANHOLE |
| ■ | CURB INLET |
| ⊗ | FIRE HYDRANT |
| □ | WATER METER |
| ← | EMERGENCY FLOOD ROUTE |
| D.U.&S.S.E. | DRAINAGE, UTILITY & SANITARY SEWER EASEMENT |
| L.M.A.E. | LANDSCAPE, MAINTENANCE ACCESS EASEMENT |
| D.U.E. | DRAINAGE & UTILITY EASEMENT |
| B.L. | BUILDING LINE |
| G.B.L. | GARGE BUILDING LINE |
| VAR. | VARIABLE |
| M.L.A.G. | MINIMUM LOWEST ADJACENT GRADE |
| M.F.F. | MINIMUM FINISHED FLOOR |

CONTRACTOR SHALL CUT 4' OFF OF LATERAL AND BEGIN FROM THAT POINT AND CONNECT TO HOUSE FOLLOWING PLOT PLAN.

**LOT 71
CARRICK GLEN
SECTION 2**

INST. #2021R000943

ZONING: SINGLE FAMILY

5' MINIMUM SIDE YARD

15' MINIMUM REAR YARD

50% MAXIMUM LOT COVERAGE

BENCHMARK
TOP OF CASTING = 871.70

ALL UNDERGROUND SEWERS AND UTILITIES SHOWN ARE PLOTTED BY SCALE FROM DESIGN PLANS FURNISHED BY ENGINEER. THE ACTUAL FIELD LOCATION MAY VARY.

SOD:	1,592 ± Sq. Ft.
SEEDING:	3,312 ± Sq. Ft.
CONC. DRIVEWAY:	1,005 ± Sq. Ft.
PRIVATE WALK:	54 ± Sq. Ft.
PUBLIC WALK:	230 ± Sq. Ft.



David J. Stoepfelwerth

NOTE: THIS DRAWING IS NOT INTENDED TO BE REPRESENTED AS A RETRACEMENT OR ORIGINAL BOUNDARY SURVEY, A ROUTE SURVEY OR A SURVEYOR LOCATION REPORT.

04/23/21 NSH



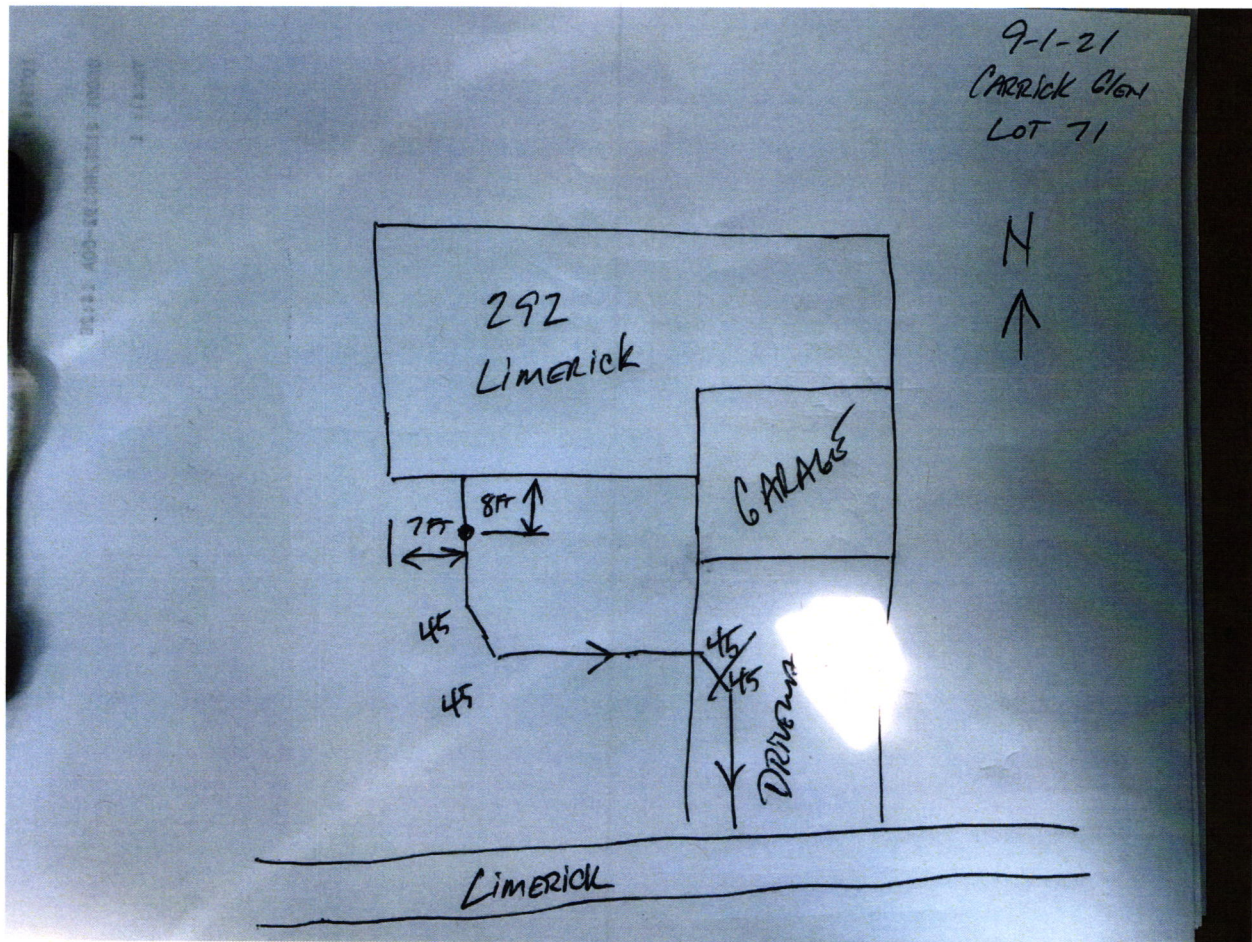



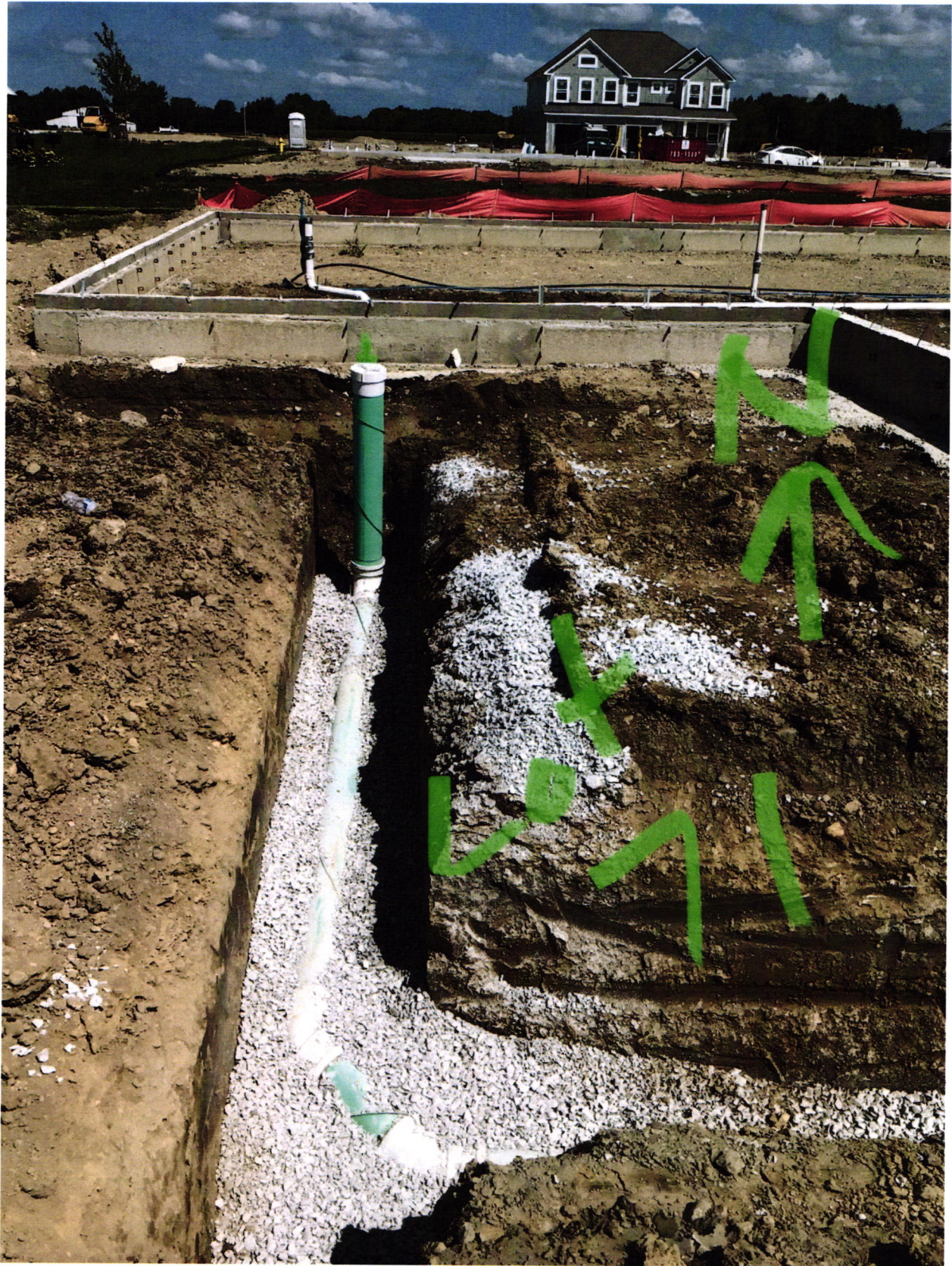

FALL CREEK REGIONAL WASTE DISTRICT
9378 SOUTH 650 WEST

DRH Inc. Controlled Disb

Stub 1 of 1

Check Number

1277706

Date

04/07/21

2720128

PO Numb	Invoice Number	Subdv	Lot#	Lot Address	Cost Cde	Legal Desc	Gross	Deductions	Amount Paid
	CG71SEWER	55516	0071	0071 TBD			760.00		760.00
							760.00		760.00

THIS CHECK IS PRINTED IN RED AND BLUE INK ON THE FACE ON CHEMICAL AND BLEACH REACTIVE PAPER WITH INVISIBLE FLUORESCENT FIBERS AND BASKETWEAVE ON BACK

DR-HORTON
America's Builder

DRH Inc. Controlled Disb
1341 Horton Circle
Arlington, TX 76011

JP Morgan Chase Bank, N.A.
Syracuse, NY

Check Number 1277706

50-937

213

2720128

Date	Amount
04/07/21	\$*****760.00

Void after 6 months from date of issue

SEVEN HUNDRED SIXTY AND 00/100 *****

Pay To The Order Of:
FALL CREEK REGIONAL WASTE DISTRICT
9378 SOUTH 650 WEST
PENDLETON IN 46064

D. L. Horton

Rec# 011687