



FALL CREEK REGIONAL WASTE DISTRICT

9378 S. 650 West PO Box 59  
Pendleton, IN 46064-0059 778-7544

23-00440.00

APPLICATION FOR SEWER PERMIT

Nº 2645

Date \_\_\_\_\_

Permit Void 90 days from Date of Issuance

Owner Name Doug Downing

Property Address 2851 Huntsville Road

Lot # \_\_\_\_\_ P.O. Box \_\_\_\_\_

Town Pendleton, IN Zip Code 46064

Phone \_\_\_\_\_ City Water \_\_\_\_\_ Well ☒

\$ N/A Tap on Fee Paid

\$ N/A Inspection fee paid

Application is hereby made for connection to the Fall Creek Regional Waste District Sewer System for the above listed property - Permit Type: Residential ☒, Commercial \_\_\_\_\_, Industrial \_\_\_\_\_, or Governmental/Institutional \_\_\_\_\_. User Information \_\_\_\_\_.

All workmanship and materials shall conform to the standards of the District Ordinance as described in Ordinance 84-2 and 84-3 as amended. Acceptance and approval must be made by the District inspector or his duly authorized representative before backfilling and final connection is made to the main sewer lines. Any violation of applicable regulations will cause all lines and appurtenances in violation to be removed and replaced at the owners expense.

The Fall Creek Regional Waste District is responsible for the inspection, approval of materials, and installation techniques only. All costs for materials and installation and any liabilities resulting from same is the sole responsibility of the property owner.

I have read and fully understand the above provisions and agree to comply by said provisions.

APPLICANT(S) SIGNATURE \_\_\_\_\_

\*\*\*\*\*

INSPECTOR [Signature]

Date inspected 10/24/98 Approved \_\_\_\_\_ Rejected \_\_\_\_\_

Reason for rejection \_\_\_\_\_

Date reinspected \_\_\_\_\_ Approved \_\_\_\_\_ Rejected \_\_\_\_\_

Notes:

Size Pipe 6"

Type Pipe SDR 26 120

Basement ☒ Yes ☐ No

Sump Pump Yes ☒ No ☐

Downspout to Ground ☒ Yes ☐ No

Septic Tank Pumped & filled ☒ Yes ☐ No

Contractor M+M

Special Conditions \_\_\_\_\_

Existing Home ☒

New Construction \_\_\_\_\_

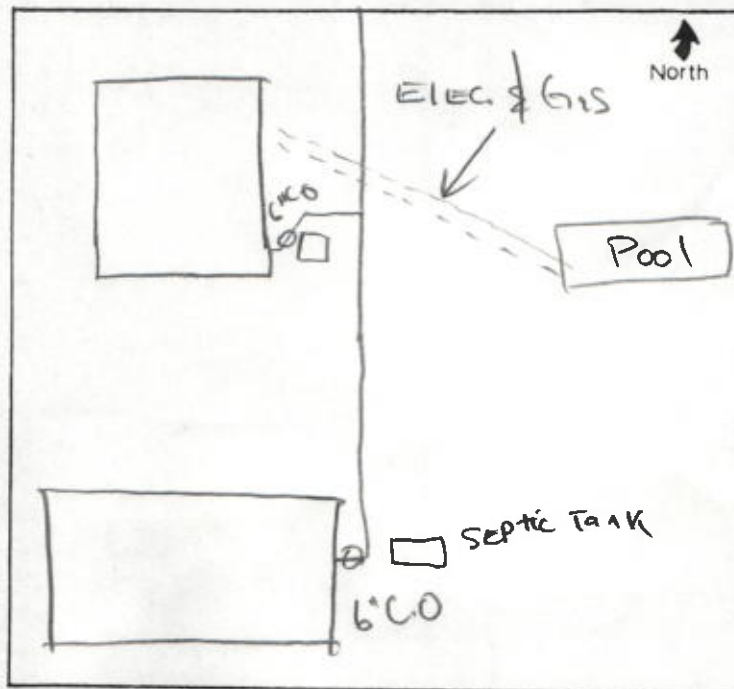



# FALL CREEK REGIONAL WASTE DISTRICT

3330 E. 350 West, P.O. Box 10  
Bend, Oregon 97709-0010 503-734-1244

No 2842

WASTE TREATMENT & DISPOSAL REPORT

DATE: \_\_\_\_\_  
FACILITY NAME: Pratt Community  
ADDRESS: 2221 Monticello Road  
CITY: Pratt STATE: MO ZIP: 64074  
WASTE TYPE: Household  
WASTE QUANTITY: 1000 Yards  
WASTE DESCRIPTION: Household  
WASTE TREATMENT: N/A  
WASTE DISPOSAL: N/A

Waste District has been notified by the generator of the waste and has been advised of the waste quantity and description. The waste has been accepted for treatment and disposal.

The waste has been accepted for treatment and disposal. The waste has been accepted for treatment and disposal. The waste has been accepted for treatment and disposal. The waste has been accepted for treatment and disposal.

The waste has been accepted for treatment and disposal. The waste has been accepted for treatment and disposal. The waste has been accepted for treatment and disposal. The waste has been accepted for treatment and disposal.

The waste has been accepted for treatment and disposal. The waste has been accepted for treatment and disposal. The waste has been accepted for treatment and disposal. The waste has been accepted for treatment and disposal.

WASTE TREATMENT & DISPOSAL REPORT  
WASTE QUANTITY: 1000 Yards  
WASTE DESCRIPTION: Household  
WASTE TREATMENT: N/A  
WASTE DISPOSAL: N/A



WASTE TREATMENT & DISPOSAL REPORT  
WASTE QUANTITY: 1000 Yards  
WASTE DESCRIPTION: Household  
WASTE TREATMENT: N/A  
WASTE DISPOSAL: N/A