

## FALL CREEK REGIONAL WASTE DISTRICT

№ 5038

9378 S 650 WEST, P.O. BOX 59, PENDLETON, IN 46064

765-778-7544

## AGREEMENT FOR SANITARY SEWER SERVICE

This Agreement made and entered into this 31<sup>st</sup> day of October, 2003, between FALL CREEK REGIONAL WASTE DISTRICT ("District") and Charles Robertson ("Applicant") regarding the provision of sanitary sewer service, and the assignment of capacity in, and connection to, the District's facilities for the premises located at 220 S Broadway, Pendleton

NOW THEREFORE, the parties, in consideration of the mutual promises set out in this Agreement, the receipt and sufficiency of which is hereby acknowledged, agree as follows:

1. The Applicant agrees that all workmanship and materials shall conform to all District ordinances and the District's construction standards. District must accept and approve all work and materials before backfilling and final connection is made to the sewer mains. Any violation of this provision will cause all lines and appurtenances in violation to be removed and replaced at the Applicant's expense.
2. The District shall have the right to enter upon the Applicant's premises at all reasonable times to inspect, repair, or replace any equipment used in connection with the District's service or which has an impact on said service.
3. The Applicant shall be responsible for all monthly user rates, capacity charges, and tap fees. The failure to pay any rate charge or fee may result in a lien against the property and/or the termination of service to the property, the cost of which will be borne by Applicant, including, but not limited to, all attorney's fees and collection costs.
4. The District shall not be responsible for any damages as a result of any failure to supply service unless said damages are due to default, neglect or culpability on the part of the District.
5. If there is an available sanitary sewer within three hundred (300) feet of the property line, the property owner shall be required to connect to the District's sanitary sewer system.
6. The Applicant and District agree that the provision of sanitary sewer service touches and concerns the property and the terms of this Agreement bind the District and Applicant and their heirs, executors, administrators, personal representatives, successors, agents, attorneys, assigns, designees, and transferees.

The parties hereto have read and fully understand the above provisions and agree to comply with said provisions.

FALL CREEK REGIONAL WASTE DISTRICT  
Alfred Wilson  
 Signature

APPLICANT

Signature

STATE OF INDIANA )  
 ) SS:  
 COUNTY OF MADISON )

SUBSCRIBED and sworn to before me this \_\_\_\_ day of \_\_\_\_\_, 200 \_\_\_\_.

My Commission Expires:

Signature

Printed

Notary Public  
 Resident of Madison County

\*\*\*\*\*

INSPECTOR B DATE INSPECTED 10-31-03 APPROVED ☒ REJECTED ☐

REASON FOR REJECTION

DATE REINSPECTED \_\_\_\_\_ APPROVED \_\_\_\_\_ REJECTED \_\_\_\_\_

NOTES:  
 SIZE PIPE 6 TYPE PIPE PVC

BASEMENT YES ☒ NO ☐SUMP PUMP YES ☒ NO ☐DOWNSPOUT TO GROUND YES ☒ NO ☐SEPTIC TANK PUMPED & FILLED YES ☐ NO ☒CONTRACTOR Mike Hall

SPECIAL CONDITIONS

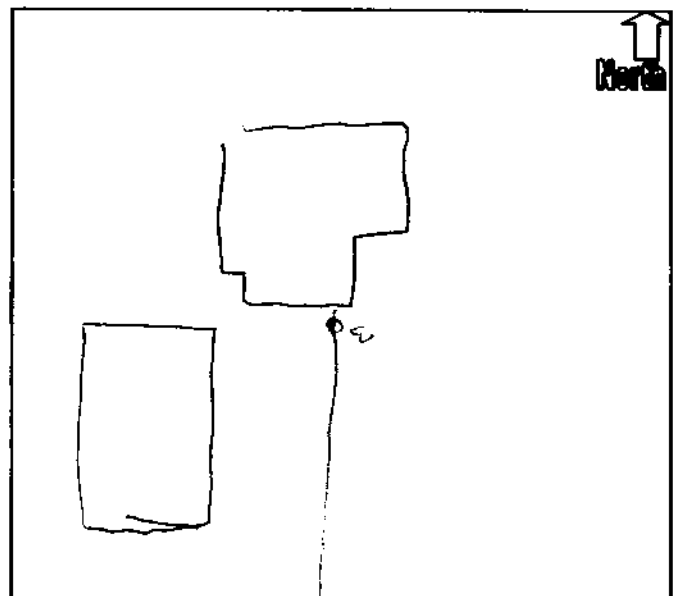
EXISTING HOME ☒NEW CONSTRUCTION ☐

Gidw.

PROJECT Phase II SHEET \_\_\_\_\_ OF \_\_\_\_\_

SUBJECT \_\_\_\_\_ DATE 2-26-18

JOB NO. 4447

BY ATLAS

220 S. BROADWAY

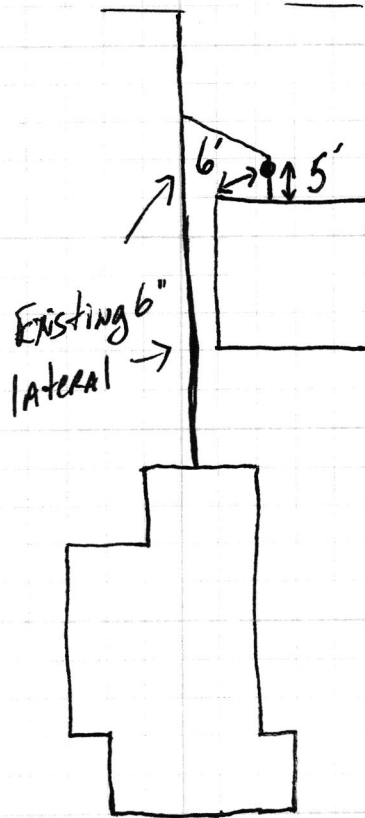

Installed new lateral  
from the garage & tied  
into the house lateral  
Lateral at the garage  
was slow draining -

BROADWAY

220 S Broadway

SRP Phase II

garage into  
house lateral

