



FALL CREEK REGIONAL WASTE DISTRICT

Box ⁵⁹44, Pendleton, Indiana 46064

22-27000.00

add order
on file

APPLICATION FOR SEWER PERMIT

Nº 001991

Permit No. _____ Date 1/13/94

Permit Void 90 days from Date of Issuance

Owner Name Evelyn DavisProperty Address 1906 W. Deer CrossingLot # 20 P.O. Box _____Town Pendleton, IN Zip Code 46064

Phone _____ Water Meter _____

\$ 350.00 Tap on Fee Paid availability fee 2000.00 3/30/94\$ 25.00 Inspection fee paid interior line fee 1243.50 3/30/94

Application is hereby made for connection to the Fall Creek Regional Waste District Sewer System for the above listed property - Permit Type: Residential ☒, Commercial _____, Industrial _____, or Governmental/Institutional _____. User Information _____.

All workmanship and materials shall conform to the standards of the District Ordinance as described in Ordinance 84-2 and 84-3 as amended. Acceptance and approval must be made by the District inspector or his duly authorized representative before backfilling and final connection is made to the main sewer lines. Any violation of applicable regulations will cause all lines and appurtenances in violation to be removed and replaced at the owners expense.

The Fall Creek Regional Waste District is responsible for the inspection, approval of materials, and installation techniques only. All costs for materials and installation and any liabilities resulting from same is the sole responsibility of the property owner.

I have read and fully understand the above provisions and agree to comply by said provisions.

Harold E. Puffy pus
APPLICANT(S) SIGNATURE

INSPECTOR BDate inspected 1-13-94 Approved ☒ Rejected _____

Reason for rejection _____

Date reinspected _____ Approved _____ Rejected _____

Notes:

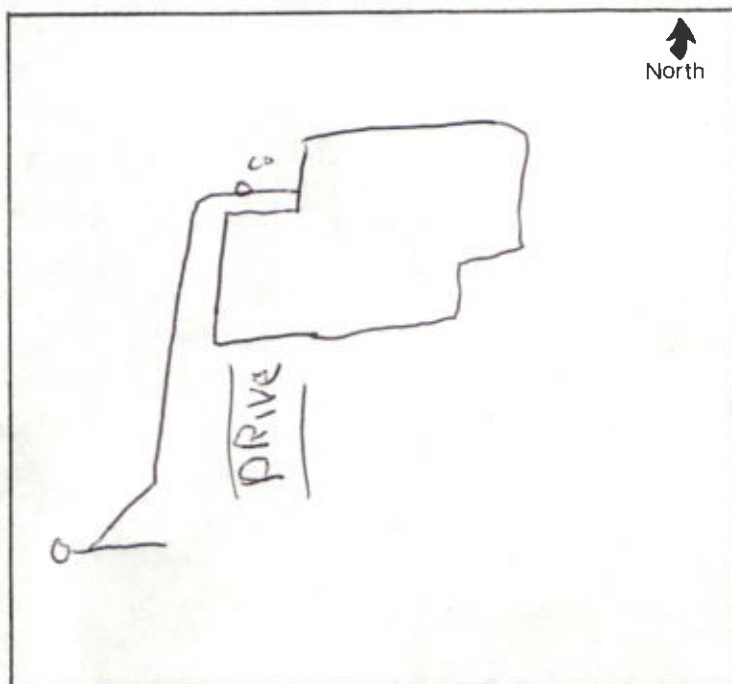
Size Pipe 6 "Type Pipe PVCBasement Yes ☒ No _____Sump Pump Yes _____ No ☒Downspout to Ground Yes ☒ No _____Septic Tank Pumped & filled Yes ☒ No _____Contractor Bolton ConstSpecial Conditions new Const

199100 92



FALL CREEK REGIONAL WASTE DISTRICT

P.O. Box 59 • 9378 S. 650 West • Pendleton, Indiana 46064-0059 • (317) 778-7544

December 7, 1993

Ms. Evelyn Davis
306 E. 39th Street

Anderson, IN 46013

RE: Lot 20 Hickory Hills-East

Dear Ms. Davis:

The sanitary main has been installed in Sections 1 & 2 of Hickory Hills-East Subdivision and is now available to connect your home lateral within ninety (90) days upon receipt of this written notice in accordance with Indiana Code 13-3-2-10 (8).

Connection to the sanitary main is your responsibility and must comply with our Construction Standards as indicated on the enclosed sheet. This service is for wastewater only. Connections of roof downspouts, exterior footing drains, surface run-off, groundwater connections or sump pumps are prohibited.

Disposition of your existing septic tank is also your responsibility. The tank shall be emptied of its contents, filled with granular material and disconnected from further use.

There is a \$350 residential tap-on fee and a \$25 Inspection Fee payable with your application and due prior to connection to the sanitary main. Application forms for service may be obtained at our Administrative Office, 9378 S. County Road 650 W., Pendleton, IN 46064.

Please notify our office when your service lateral is ready for inspection and connection to the sanitary main.

In accordance with Ordinance 92-4, an Acreaged-Based Availability Fee Assessment of \$2,000.00 for each connection is due Fall Creek Regional Waste District within ninety (90) days upon receipt of this Assessment Notice.

Also, a pro-rated Interior Construction Cost of \$1,243.50 per lot for the installation of the sanitary system within Sections 1 and 2 of Hickory Hills-East is due Fall Creek Regional Waste District within ninety (90) days upon receipt of this notice.

A Time Payment Plan is available for the Acreaged-Based Availability Fee and the pro-rated Interior Construction Cost. If interested in the details of the Time Payment Plan, please call our Office Manager at 778-7544 for details.

Sincerely,

JFR
J. F. Rowlett
General Manager

ENCL.

JFR/tas

\$ 350.00
25.00
2000.00
1243.50

\$ 3618.50
375.00

\$ 3243.50

pd by Riffey

check # 1254

