

#6544

765-778-7544

This Agreement made and entered into this 16 day of November, 2015, between Fall Creek Regional Waste District ("District") and Mustin Builders ("Applicant") regarding the provision of sanitary sewer service, and the assignment of capacity in and connection to, the District's facilities for the premises located at Pondle Pointe Apt 35.

Now therefore, the parties, in consideration of the mutual promises set out in this Agreement, the receipt and sufficiency of which is hereby acknowledged, agree as follows:

1. The Applicant agrees that all workmanship and materials shall conform to all District ordinances and the District's construction standards. District must accept and approve all work and materials before backfilling and final connection is made to the sewer mains. Any violation of this provision will cause all lines and appurtenances in violation to be removed and replaced at the Applicant's expense.
2. The District shall have the right to enter upon the Applicant's premises at all reasonable times to inspect, repair, or replace any equipment used in connection with the District's service or which has an impact on said service.
3. The Applicant shall be responsible for all monthly user rates, capacity charges, and tap fees. The failure to pay any rate charge or fee may result in a lien against the property and/or the termination of service to the property, the cost of which will be borne by Applicant, including, but not limited to, all attorney's fees and collection costs.
4. The District shall not be responsible for any damages as a result of any failure to supply service unless said damages are due to default, neglect or culpability on the part of the District.
5. If there is an available sanitary sewer within three hundred (300) feet of the property line, the property owner shall be required to connect to the District's sanitary sewer system.
6. The Applicant and District agree that the provision of sanitary sewer service touches and concerns the property and the terms of this Agreement bind the District and Applicant and their heirs, executors, administrators, personal representatives, successors, agents, attorneys, assigns, designees, and transferees.

The parties hereto have read and fully understand the above provisions and agree to comply with said provisions.

Signature

APPLICANT

Signature _____

STATE OF INDIANA)

) SS:

COUNTY OF MADISON)

SUBSCRIBED and sworn to before me this 16 day of November, 2015

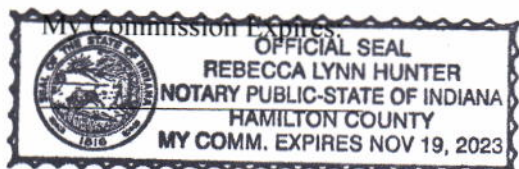

Signature_____

Printed Rebecca Lynn Hunter

Notary Public

Resident of Hamilton County

Inspector SN Date Inspected 12/4/15 Approved ☒ Rejected ☐

Reason for Rejection

Date Reinspected _____ Approved _____ Rejected _____

Notes:

Size Pipe 6" Type Pipe 35

Basement Yes No

Sump Pump Yes No

Downspout to Ground Yes No

Septic Tank Pumped & Filled Yes No

Contractor Boltorn

Special Conditions

Existing Home

New Construction

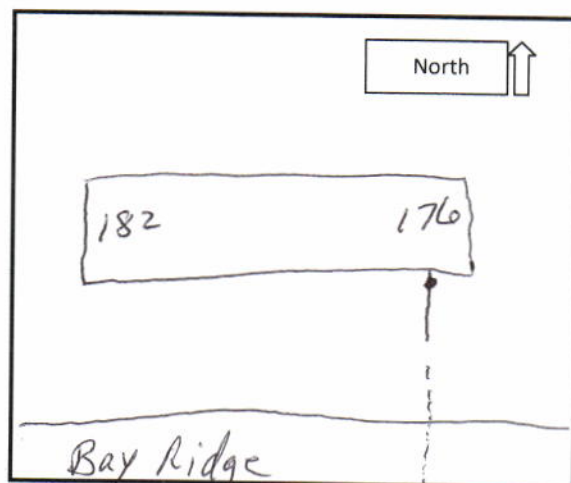

1 picture attached

1746 Bay Bridge Lot 35
LUMBER LUMBER

DUPONT

Tyvek
HomeWrap

DUPONT

Tyvek
HomeWrap

DUPONT

Tyve
HomeWr



Original check is printed on chemical reactive paper with fluorescent fiber content and a watermark - hold up to a light to view



MUSTIN BUILDERS, INC.
810 CENTRAL AVENUE
ANDERSON, IN 46012
PH. 765-644-8502



PO Box 11409 • Fort Wayne, IN 46858-1409

303938

71-167749

Fourteen Thousand Four Hundred Eighty ~~and 00/100~~

DATE

11-16-15

CHECK NO.

303938

AMOUNT

\$13,480.00

FCRWD

COPY

⑈ 303938 ⑈

Lawrence E. Epler
AUTHORIZED SIGNATURE MP