



FALL CREEK REGIONAL WASTE DISTRICT

Box 44, Pendleton, Indiana 46064

add order
on file

22-28320.00

APPLICATION FOR SEWER PERMIT

Nº 002000

Permit No. _____ Date 2/22/94
Permit Void 90 days from Date of Issuance
Owner Name David Clute
Property Address 1555 W. Huntsville Road
Lot # _____ P.O. Box _____
Town Pendleton, IN Zip Code 46064
Phone _____ Water Meter _____"
\$ 700.00 Tap on Fee Paid availability fee 2,000.00
\$ 25.00 Inspection fee paid

Application is hereby made for connection to the Fall Creek Regional Waste District Sewer System for the above listed property - Permit Type: Residential ☒, Commercial _____, Industrial _____, or Governmental/Institutional _____. User Information _____.

All workmanship and materials shall conform to the standards of the District Ordinance as described in Ordinance 84-2 and 84-3 as amended. Acceptance and approval must be made by the District inspector or his duly authorized representative before backfilling and final connection is made to the main sewer lines. Any violation of applicable regulations will cause all lines and appurtenances in violation to be removed and replaced at the owners expense.

The Fall Creek Regional Waste District is responsible for the inspection, approval of materials, and installation techniques only. All costs for materials and installation and any liabilities resulting from same is the sole responsibility of the property owner.

I have read and fully understand the above provisions and agree to comply by said provisions.

David Clute

APPLICANT(S) SIGNATURE

INSPECTOR DM

Date inspected 4/11/94 Approved ☒ Rejected _____
Reason for rejection _____

Date reinspected _____ Approved _____ Rejected _____

Notes:
Size Pipe 4" IAWQ
Type Pipe PVC
Basement Yes _____ No _____
Sump Pump Yes _____ No _____
Downspout to Ground Yes ☒ No _____
Septic Tank Pumped & filled Yes _____ No ☒
Contractor Baker
Special Conditions _____

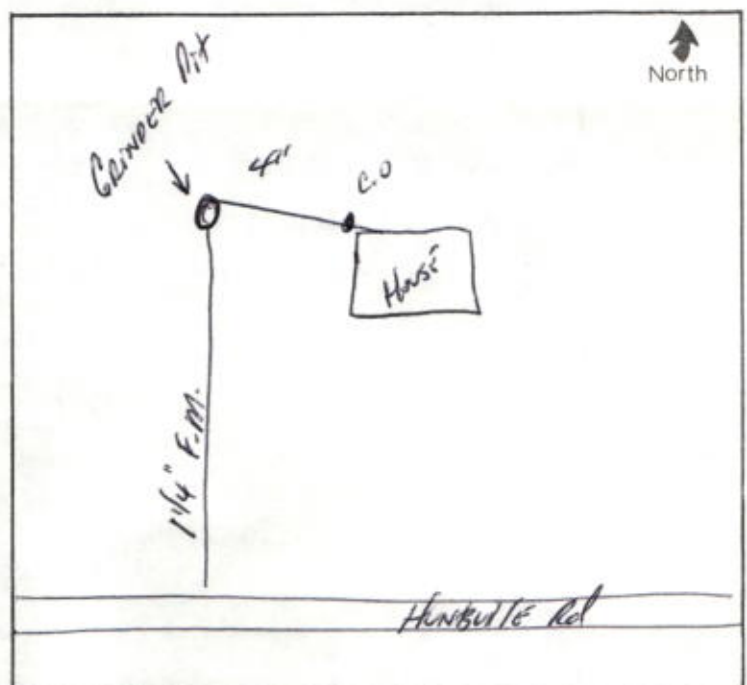



PALM BEACH REGIONAL WASTE DISTRICT

Box 22, Wellington, Indiana 46084

00000000

00000000

1222 N. Huntington

1222 N. Huntington

1222 N. Huntington

1222 N. Huntington

1222 N. Huntington

1222 N. Huntington

1222 N. Huntington

1222 N. Huntington

1222 N. Huntington

1222 N. Huntington

1222 N. Huntington

1222 N. Huntington

1222 N. Huntington

1222 N. Huntington

1222 N. Huntington

1222 N. Huntington