



## FALL CREEK REGIONAL WASTE DISTRICT

Box 44, Pendleton, Indiana 46064

133077700

add order on file

## APPLICATION FOR SEWER PERMIT

Nº 001840

Permit No. \_\_\_\_\_ Date 4-23-92  
Permit Void 90 days from Date of Issuance  
Owner Name Tolley Homes / CRAIG, DAVID K.  
Property Address 150 Hawthorne Dr.  
Lot # 15 P.O. Box \_\_\_\_\_  
Town Pendleton, IN Zip Code 46064  
Phone \_\_\_\_\_ Water Meter Pend.  
\$ 700.00 Tap on Fee Paid  
\$ 25.00 Inspection fee paid

Application is hereby made for connection to the Fall Creek Regional Waste District Sewer System for the above listed property - Permit Type: Residential ☒, Commercial \_\_\_\_\_, Industrial \_\_\_\_\_, or Governmental/Institutional \_\_\_\_\_. User Information \_\_\_\_\_.

All workmanship and materials shall conform to the standards of the District Ordinance as described in Ordinance 84-2 and 84-3 as amended. Acceptance and approval must be made by the District inspector or his duly authorized representative before backfilling and final connection is made to the main sewer lines. Any violation of applicable regulations will cause all lines and appurtenances in violation to be removed and replaced at the owners expense.

The Fall Creek Regional Waste District is responsible for the inspection, approval of materials, and installation techniques only. All costs for materials and installation and any liabilities resulting from same is the sole responsibility of the property owner.

I have read and fully understand the above provisions and agree to comply by said provisions.

David Remy

APPLICANT(S) SIGNATURE

\*\*\*\*\*

INSPECTOR Don-Ber

Date inspected 5/6/92 Approved \_\_\_\_\_ Rejected ☒  
Reason for rejection NO BEDDING MATERIAL. No outside clean out  
3' From House

Date reinspected 7/13/92 Approved ☒ Rejected \_\_\_\_\_

## Notes:

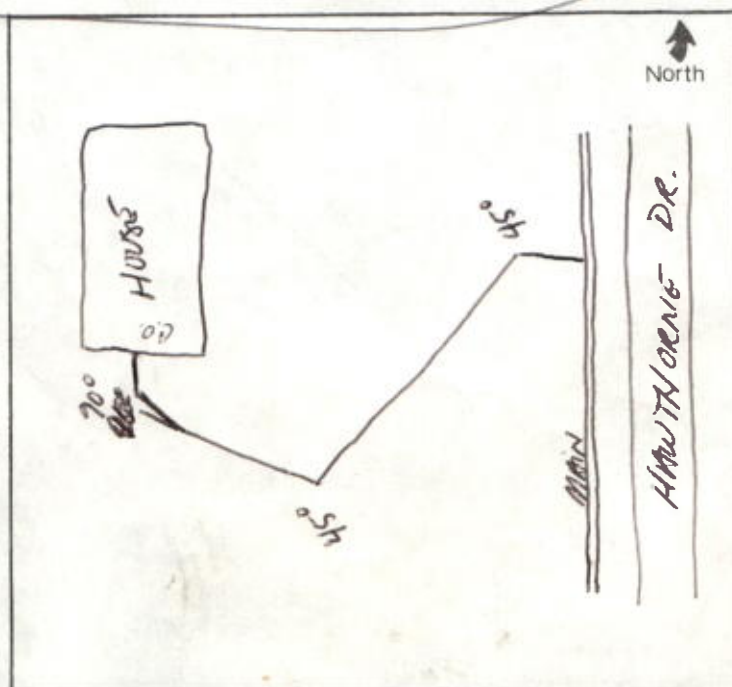
Size Pipe 6"Type Pipe PVCBasement Yes \_\_\_\_\_ No ☒Sump Pump Yes \_\_\_\_\_ No ☒Downspout to Ground Yes ☒ No \_\_\_\_\_Septic Tank Pumped & filled Yes \_\_\_\_\_ No ☒Contractor Frederick IncSpecial Conditions See Const

SP-ES-10