

P-Town

Fall Creek Regional Waste District
9378 S 650 W, P.O. Box 59, Pendleton, IN 46064
765-778-7544

#6418

Agreement for Sanitary Sewer Service

This Agreement made and entered into this 17 day of MARCH, 2011, between Fall Creek Regional Waste District ("District") and _____ ("Applicant") regarding the provision of sanitary sewer service, and the assignment of capacity and connection to, the District's facilities for the premises located at 124 Franklin St.

Now therefore, the parties, in consideration of the mutual promises set out in this Agreement, the receipt and sufficiency of which is hereby acknowledged, agree as follows:

1. The Applicant agrees that all workmanship and materials shall conform to all District ordinances and the District's construction standards. District must accept and approve all work and materials before backfilling and final connection is made to the sewer mains. Any violation of this provision will cause all lines and appurtenances in violation to be removed and replaced at the Applicant's expense.
2. The District shall have the right to enter upon the Applicant's premises at all reasonable times to inspect, repair, or replace any equipment used in connection with the District's service or which has an impact on said service.
3. The Applicant shall be responsible for all monthly user rates, capacity charges, and tap fees. The failure to pay any rate charge or fee may result in a lien against the property and/or the termination of service to the property, the cost of which will be borne by Applicant, including, but not limited to, all attorney's fees and collection costs.
4. The District shall not be responsible for any damages as a result of any failure to supply service unless said damages are due to default, neglect or culpability on the part of the District.
5. If there is an available sanitary sewer within three hundred (300) feet of the property line, the property owner shall be required to connect to the District's sanitary sewer system.
6. The Applicant and District agree that the provision of sanitary sewer service touches and concerns the property and the terms of this Agreement bind the District and Applicant and their heirs, executors, administrators, personal representatives, successors, agents, attorneys, assigns, designees, and transferees.

The parties hereto have read and fully understand the above provisions and agree to comply with said provisions.

FALL CREEK REGIONAL WASTE DISTRICT

APPLICANT

Signature _____

Signature _____

STATE OF INDIANA)
) SS:
COUNTY OF MADISON)

SUBSCRIBED and sworn to before me this _____ day of _____, 20____

My Commission Expires:

Signature _____

Printed _____

Notary Public
Resident of _____ County

* Lateral Replacement *

Inspector Don Date Inspected 3-17-11 Approved ☒ Rejected _____
Reason for Rejection _____

Date Reinspected _____ Approved _____ Rejected _____

Notes:

Size Pipe 4" Type Pipe PVC 35
Basement Yes No
Sump Pump Yes No
Downspout to Ground Yes No
Septic Tank Pumped & Filled Yes No
Contractor Bob Water Works
Special Conditions _____
Existing Home Yes
New Construction _____

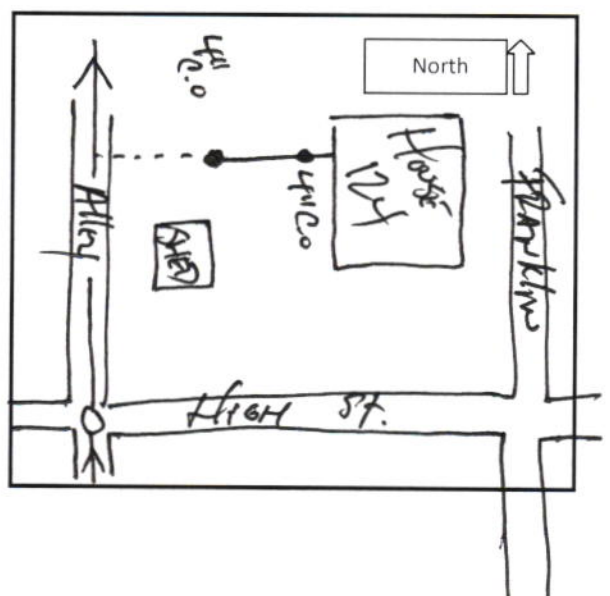

Gidw.

PROJECT Phase II SHEET _____ OF _____

SUBJECT _____ DATE 3-16-18

JOB NO. 4447

BY A+has

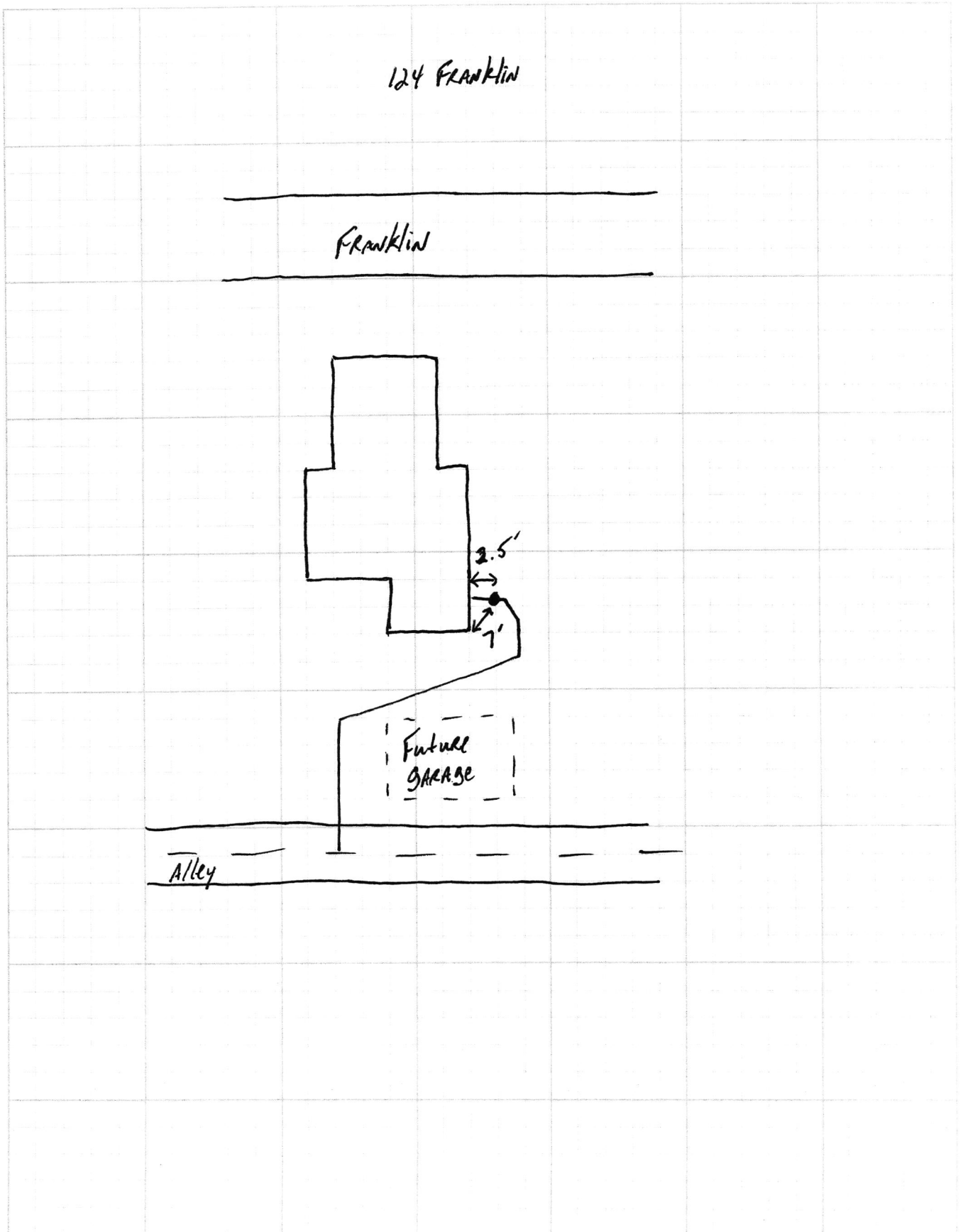

124 Franklin

SRP Phase II

