

Fall Creek Regional Waste District

9378 S 650 W, P.O. Box 59, Pendleton, IN 46064

765-778-7544

Agreement for Sanitary Sewer Service

#6523

This Agreement made and entered into this 8 day of June, 2015, between Fall Creek Regional Waste District ("District") and _____ ("Applicant") regarding the provision of sanitary sewer service, and the assignment of capacity in and connection to, the District's facilities for the premises located at 11 Orleans Ave.

Now therefore, the parties, in consideration of the mutual promises set out in this Agreement, the receipt and sufficiency of which is hereby acknowledged, agree as follows:

1. The Applicant agrees that all workmanship and materials shall conform to all District ordinances and the District's construction standards. District must accept and approve all work and materials before backfilling and final connection is made to the sewer mains. Any violation of this provision will cause all lines and appurtenances in violation to be removed and replaced at the Applicant's expense.
2. The District shall have the right to enter upon the Applicant's premises at all reasonable times to inspect, repair, or replace any equipment used in connection with the District's service or which has an impact on said service.
3. The Applicant shall be responsible for all monthly user rates, capacity charges, and tap fees. The failure to pay any rate charge or fee may result in a lien against the property and/or the termination of service to the property, the cost of which will be borne by Applicant, including, but not limited to, all attorney's fees and collection costs.
4. The District shall not be responsible for any damages as a result of any failure to supply service unless said damages are due to default, neglect or culpability on the part of the District.
5. If there is an available sanitary sewer within three hundred (300) feet of the property line, the property owner shall be required to connect to the District's sanitary sewer system.
6. The Applicant and District agree that the provision of sanitary sewer service touches and concerns the property and the terms of this Agreement bind the District and Applicant and their heirs, executors, administrators, personal representatives, successors, agents, attorneys, assigns, designees, and transferees.

The parties hereto have read and fully understand the above provisions and agree to comply with said provisions.

FALL CREEK REGIONAL WASTE DISTRICT

APPLICANT

Signature _____

Signature _____

STATE OF INDIANA)
) SS:
COUNTY OF MADISON)

SUBSCRIBED and sworn to before me this _____ day of _____, 20____

My Commission Expires: _____

Signature _____

Printed _____

Notary Public

Resident of _____ County

Inspector DW Date Inspected 6-2-15 Approved ✓ Rejected _____

Reason for Rejection _____
Date Reinspected _____ Approved _____ Rejected _____

Notes:

Size Pipe 6" Type Pipe PVC 35
Basement Yes _____ No _____
Sump Pump Yes _____ No _____
Downspout to Ground Yes _____ No _____
Septic Tank Pumped & Filled Yes _____ No _____
Contractor _____
Special Conditions _____
Existing Home _____
New Construction _____

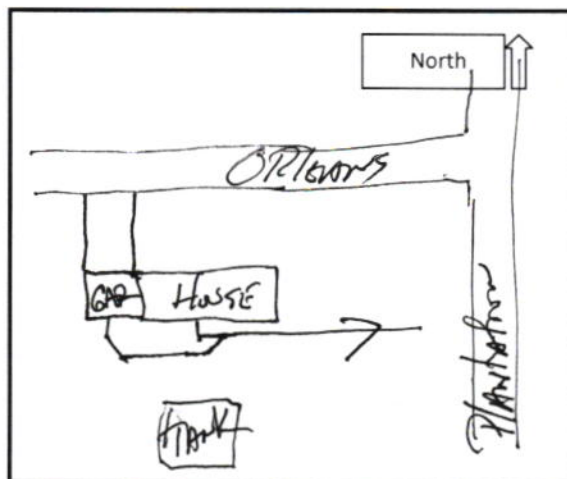

11 orleans





FALL CREEK REGIONAL WASTE DISTRICT

Box 44, Pendleton, Indiana 46064

11:30-
12:00

2-0015340.00

Nº 001304

APPLICATION FOR SEWER PERMIT

Permit No. _____ Date 2-4-86
Permit Void 90 days from Date of Issuance
Owner Name LEANNA M. COLLINS
Property Address 778-4474 (R4 Box 109) - 11 ORLEANS Ave
Lot # _____ P.O. Box _____
Town ANDERSON, IN Zip Code 46013
Phone _____ Water Meter _____
\$ 150.00 Tap on Fee Paid
\$ 25.00 Inspection fee paid

Application is hereby made for connection to the Fall Creek Regional Waste District Sewer System for the above listed property - Permit Type: Residential ✓, Commercial _____, Industrial _____, or Governmental/Institutional _____. User Information _____.

All workmanship and materials shall conform to the standards of the District Ordinance as described in Ordinance 84-2 and 84-3 as amended. Acceptance and approval must be made by the District inspector or his duly authorized representative before backfilling and final connection is made to the main sewer lines. Any violation of applicable regulations will cause all lines and appurtenances in violation to be removed and replaced at the owners expense.

The Fall Creek Regional Waste District is responsible for the inspection, approval of materials, and installation techniques only. All costs for materials and installation and any liabilities resulting from same is the sole responsibility of the property owner.

I have read and fully understand the above provisions and agree to comply by said provisions.

Leanna M. Collins
APPLICANT(S) SIGNATURE

INSPECTOR [Signature]
Date inspected 4-3 Approved ✓ Rejected _____
Reason for rejection _____

Date reinspected _____ Approved _____ Rejected _____

Notes:
Size Pipe 6 "
Type Pipe PVC
Basement Yes _____ No ✓
Sump Pump Yes _____ No ✓
Downspout to Ground Yes ✓ No _____
Septic Tank Pumped & filled Yes ✓ No _____
Contractor Don Stanley
Special Conditions _____

