



FALL CREEK REGIONAL WASTE DISTRICT

Box 44, Pendleton, Indiana 46064

1-0001051.00

Nº 000003

APPLICATION FOR SEWER PERMIT

Permit No. _____ Date _____

Permit Void 90 days from Date of Issuance

Owner Name Edith Harlow

Property Address _____

Lot # _____ P.O. Box P.O. Box 396 - 110 Swain St.

Town Ingalls, IN Zip Code 46048

Phone 485-6169 Water Meter no

\$ 150.00 2-4-85 Tap on Fee Paid

\$ 25.00 8-28-85 Inspection fee paid

Application is hereby made for connection to the Fall Creek Regional Waste District Sewer System for the above listed property - Permit Type: Residential ☒, Commercial _____, Industrial _____, or Governmental/Institutional _____. User Information _____.

All workmanship and materials shall conform to the standards of the District Ordinance as described in Ordinance 84-2 and 84-3 as amended. Acceptance and approval must be made by the District inspector or his duly authorized representative before backfilling and final connection is made to the main sewer lines. Any violation of applicable regulations will cause all lines and appurtenances in violation to be removed and replaced at the owners expense.

The Fall Creek Regional Waste District is responsible for the inspection, approval of materials, and installation techniques only. All costs for materials and installation and any liabilities resulting from same is the sole responsibility of the property owner.

I have read and fully understand the above provisions and agree to comply by said provisions.

APPLICANT(S) SIGNATURE

INSPECTOR Tim

Date inspected 12-25-85 Approved ☒ Rejected _____

Reason for rejection _____

Date reinspected _____ Approved _____ Rejected _____

Notes:
Size Pipe 6"

Type Pipe PVC

Basement Yes _____ No ☒

Sump Pump Yes _____ No ☒

Downspout to Ground Yes _____ No ☒

Septic Tank Pumped & filled Yes ☒ No _____

Contractor Flatford

Special Conditions _____

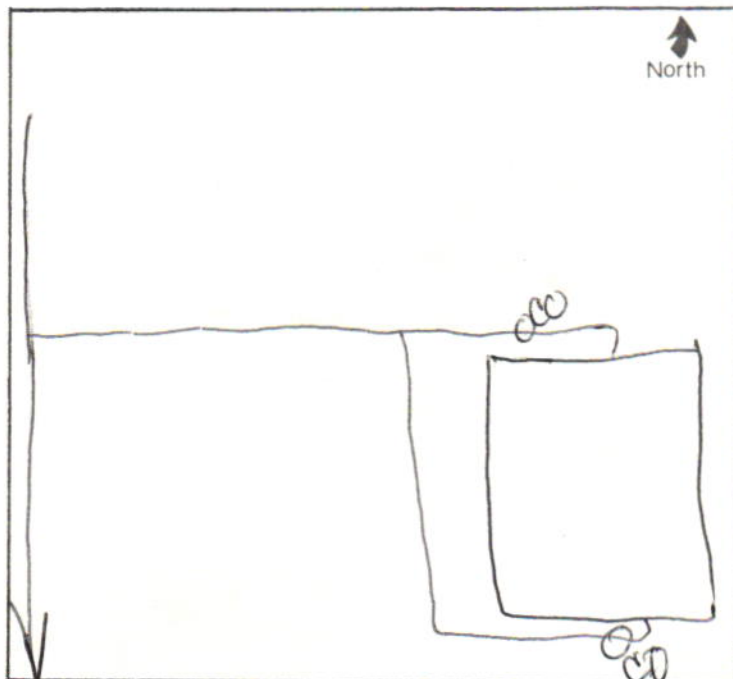

(1)
Sen & Tim -

9/27/95

Mr. Patrick Fox, 110
Swain Street, INBalls
phoned today and advised
us of his plans to remodel
his GARAGE and make it
into an apartment for
his children.

He was advised to
call us when the lateral
is ready for inspection.

He was informed that he
can ~~Y~~ ~~go~~ into his existing
lateral and that the
TAP FEE will be \$700 with
a \$25 inspection fee.

PLEASE KEEP AN EYE ON
THE PROPERTY FROM TIME TO TIME.
HE STATED THAT HE WOULD
PROBABLY RUN THE LATERAL
EXTENSION SOMETIME SOON BUT
WOULD NOT ACTUALLY CONNECT
THE BUILDING UNTIL REMODELING
IS COMPLETED ————— JES