



FALL CREEK REGIONAL WASTE DISTRICT

9378 S. 650 West PO Box 59
Pendleton, IN 46064-0059 778-7544

add order
on file

22-30205.00

APPLICATION FOR SEWER PERMIT

Nº 2231

Date 8-7-95

Permit Void 90 days from Date of Issuance

Owner Name Jeff & Karla Caplinger

Property Address 10411 Maple Springs Dr

Lot # 14 P.O. Box _____

Town Pendleton, IN Zip Code 46064

Phone 778-3489 City Water _____ Well ☒

\$ 2700.00 Tap on Fee Paid

\$ 25.00 Inspection fee paid

Application is hereby made for connection to the Fall Creek Regional Waste District Sewer System for the above listed property - Permit Type: Residential ☒, Commercial _____, Industrial _____, or Governmental/Institutional _____. User Information _____.

All workmanship and materials shall conform to the standards of the District Ordinance as described in Ordinance 84-2 and 84-3 as amended. Acceptance and approval must be made by the District inspector or his duly authorized representative before backfilling and final connection is made to the main sewer lines. Any violation of applicable regulations will cause all lines and appurtenances in violation to be removed and replaced at the owners expense.

The Fall Creek Regional Waste District is responsible for the inspection, approval of materials, and installation techniques only. All costs for materials and installation and any liabilities resulting from same is the sole responsibility of the property owner.

I have read and fully understand the above provisions and agree to comply by said provisions.

Karla Caplinger
APPLICANT(S) SIGNATURE

INSPECTOR B

Date inspected 8-18-95 Approved ☒ Rejected _____

Reason for rejection _____

Date reinspected _____ Approved _____ Rejected _____

Notes:
Size Pipe 6"

Type Pipe PVC

Basement Yes _____ No ☒

Sump Pump Yes _____ No ☒

Downspout to Ground Yes ☒ No _____

Septic Tank Pumped & filled Yes ☒ No _____

Contractor BAKER

Special Conditions _____

Existing Home ☒

New Construction ☒

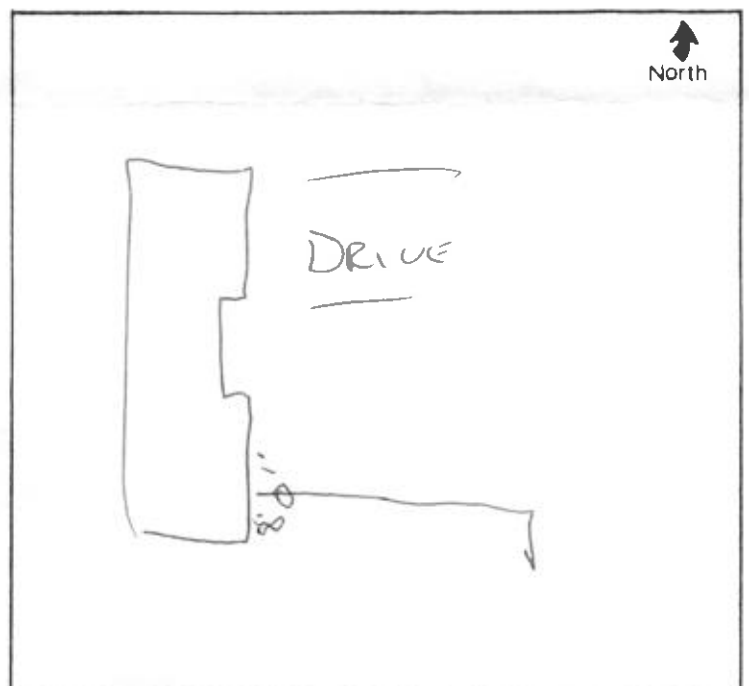

FALL CREEK REGIONAL WASTE DISTRICT



1000 N. 1000 W. RD BOX 50
FALL CREEK, MO 64601-0050

IN 5231

RELATION OF THE

8-5-92

FOR THE FALL CREEK REGIONAL WASTE DISTRICT
The following information was received from the
Fall Creek Regional Waste District regarding the
location of the landfill site. The landfill site is
located on the east side of the road, south of the
intersection of the road and the railroad tracks.
The landfill site is approximately 100 feet wide
and 100 feet long. The landfill site is currently
being used for the disposal of solid waste.
The landfill site is owned by the Fall Creek
Regional Waste District. The landfill site is
located on the east side of the road, south of the
intersection of the road and the railroad tracks.
The landfill site is approximately 100 feet wide
and 100 feet long. The landfill site is currently
being used for the disposal of solid waste.
The landfill site is owned by the Fall Creek
Regional Waste District.

The landfill site is located on the east side of the road, south of the intersection of the road and the railroad tracks. The landfill site is approximately 100 feet wide and 100 feet long. The landfill site is currently being used for the disposal of solid waste. The landfill site is owned by the Fall Creek Regional Waste District.

John Springer

Regional Director

8-18-92

Date of Report

Page 1 of 1

The following information was received from the Fall Creek Regional Waste District regarding the location of the landfill site.

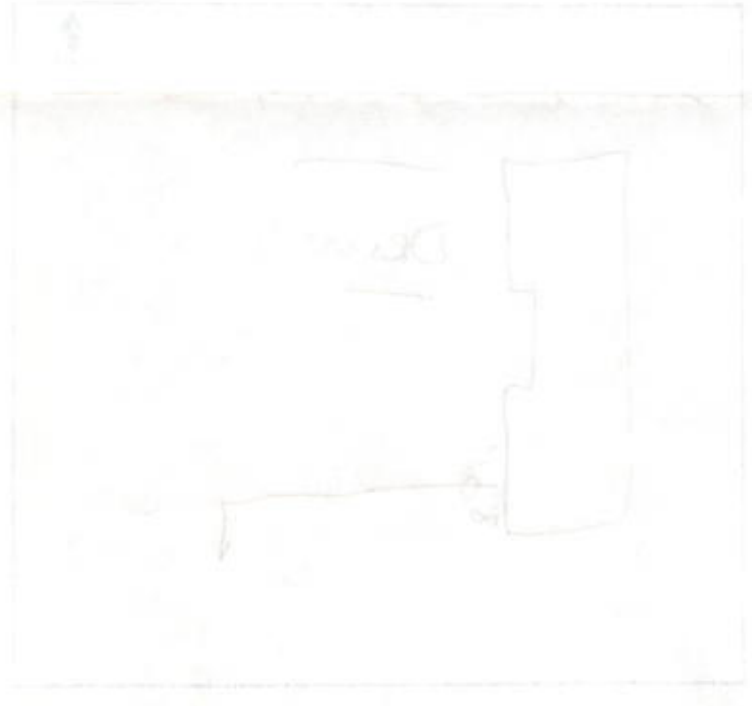

The landfill site is located on the east side of the road, south of the intersection of the road and the railroad tracks. The landfill site is approximately 100 feet wide and 100 feet long. The landfill site is currently being used for the disposal of solid waste. The landfill site is owned by the Fall Creek Regional Waste District.