



FALL CREEK REGIONAL WASTE DISTRICT

Box 44, Pendleton, Indiana 46064

3-0001161

Nº 000099

APPLICATION FOR SEWER PERMIT

Permit No. _____ Date August 14, 1985
 Permit Void 90 days from Date of Issuance
 Owner Name Mingle Veterinary Hospital Inc.
 Property Address R.R. 2 1011 S. Pendleton Ave.
 Lot # _____ P.O. Box 21
 Town Pendleton, IN Zip Code 46064-8979
 Phone 778-2909 Water Meter _____
 \$ 150.00 Tap on Fee Paid
 \$ 25.00 Inspection fee paid

Application is hereby made for connection to the Fall Creek Regional Waste District Sewer System for the above listed property - Permit Type: Residential ☒, Commercial ☒, Industrial _____, or Governmental/Institutional _____. User Information _____.

All workmanship and materials shall conform to the standards of the District Ordinance as described in Ordinance 84-2 and 84-3 as amended. Acceptance and approval must be made by the District inspector or his duly authorized representative before backfilling and final connection is made to the main sewer lines. Any violation of applicable regulations will cause all lines and appurtenances in violation to be removed and replaced at the owners expense.

The Fall Creek Regional Waste District is responsible for the inspection, approval of materials, and installation techniques only. All costs for materials and installation and any liabilities resulting from same is the sole responsibility of the property owner.

I have read and fully understand the above provisions and agree to comply by said provisions.

Hugh F. Mingle
 APPLICANT(S) SIGNATURE

INSPECTOR DOUG-TIM

Date inspected 8-14-85 Approved ☒ Rejected _____

Reason for rejection _____

Date reinspected _____ Approved _____ Rejected _____

Notes:

Size Pipe 6"

Type Pipe P.V.C

* Basement Yes ☒ No ☒

Sump Pump Yes _____ No ☒

Downspout to Ground Yes ☒ No ☒

* Septic Tank Pumped & filled Yes ☒ No _____

Contractor FRATFORD & SONS

Special Conditions * SEPTIC TRS. WILL BE

PUMPED WHEN WEATHER IS DRIER

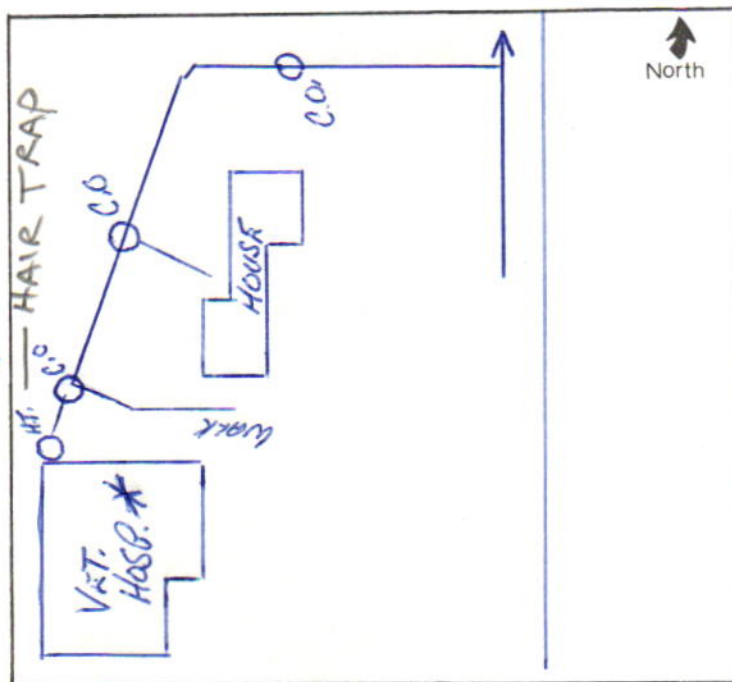

9-19363.03

MPAD® evidence.

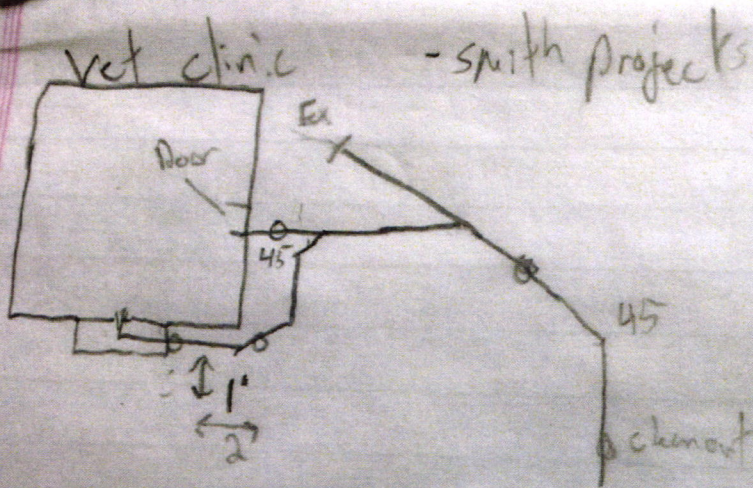

See 6" SDR 35















