



FALL CREEK REGIONAL WASTE DISTRICT

9378 S. 650 West PO Box 59
Pendleton, IN 46064-0059 778-7544

add order
on file

26-01984.00

APPLICATION FOR SEWER PERMIT

Nº 2837

Date 7-10-2000

Permit Void 90 days from Date of Issuance

Owner Name Dwight Morgan

Property Address 1010 York Drive

Lot # _____

P.O. Box _____

Town Pendleton

IN Zip Code 46064

Phone _____

City Water _____

Well ☒

\$ 2556.00 Tap on Fee Paid

\$ _____ ~~Inspection fee paid~~

gunder unit paid for
with check # 432

Application is hereby made for connection to the Fall Creek Regional Waste District Sewer System for the above listed property - Permit Type: Residential ☒, Commercial _____, Industrial _____, or Governmental/Institutional _____. User Information _____.

All workmanship and materials shall conform to the standards of the District Ordinance as described in Ordinance 84-2 and 84-3 as amended. Acceptance and approval must be made by the District inspector or his duly authorized representative before connection is made to the main sewer lines. Any violations will cause all lines and appurtenances to be removed and replaced at the owners expense.

The Fall Creek Regional Waste District is responsible for the inspection, approval of materials, and installation. All costs for materials and installation and any other costs resulting from same is the sole responsibility of the property owner.

I have read and fully understand the above provisions and agree to comply by said provisions.

APPLICANT(S) SIGNATURE _____

INSPECTOR [Signature]

Date inspected 8-2-00

Approved ☒

Rejected _____

Reason for rejection _____

Date reinspected _____

Approved _____

Rejected _____

Notes:

Size Pipe 4" / 1 1/2" P.V.C.

Type Pipe 35 / 160 PSI

Basement Yes _____ No ☒

Sump Pump Yes _____ No ☒

Downspout to Ground Yes ☒ No _____

Septic Tank Pumped & filled Yes ☒ No _____

Contractor ONE SOURCE UNDERGROUND

Special Conditions _____

Existing Home ☒

New Construction _____

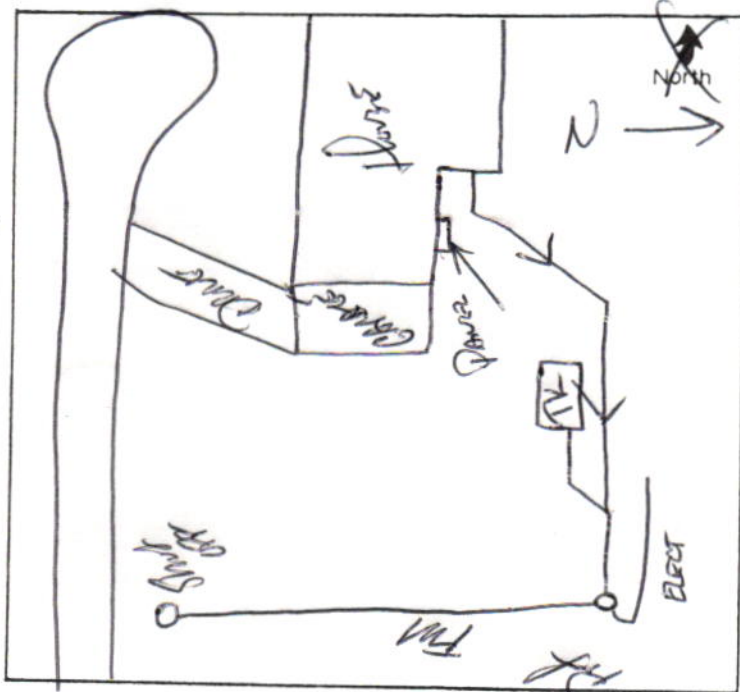

Fax: 765-778-7545

Amount Due	\$2,173.10
------------	------------