

3 PM



FALL CREEK REGIONAL WASTE DISTRICT

Box 44, Pendleton, Indiana 46064

Nº 000664

APPLICATION FOR SEWER PERMIT

Permit No. _____ Date 11-18-85
Permit Void 90 days from Date of Issuance
Owner Name Linda Reed
Property Address 100 W Falcon Run
Lot # _____ P.O. Box _____
Town PEND, IN Zip Code 46064
Phone 778-7128 Water Meter _____
\$ 150.00 Tap on Fee Paid
\$ 25.00 Inspection fee paid

Application is hereby made for connection to the Fall Creek Regional Waste District Sewer System for the above listed property - Permit Type: Residential ☒, Commercial _____, Industrial _____, or Governmental/Institutional _____. User Information _____.

All workmanship and materials shall conform to the standards of the District Ordinance as described in Ordinance 84-2 and 84-3 as amended. Acceptance and approval must be made by the District inspector or his duly authorized representative before backfilling and final connection is made to the main sewer lines. Any violation of applicable regulations will cause all lines and appurtenances in violation to be removed and replaced at the owners expense.

The Fall Creek Regional Waste District is responsible for the inspection, approval of materials, and installation techniques only. All costs for materials and installation and any liabilities resulting from same is the sole responsibility of the property owner.

I have read and fully understand the above provisions and agree to comply by said provisions.

✓ Linda Reed
APPLICANT(S) SIGNATURE

INSPECTOR [Signature]
Date inspected 11-18 Approved _____ Rejected _____
Reason for rejection _____

Date reinspected _____ Approved _____ Rejected _____

Notes:
Size Pipe 6"
Type Pipe PVC
Basement Yes _____ No ☒
Sump Pump Yes _____ No ☒
Downspout to Ground Yes ☒ No _____
Septic Tank Pumped & filled Yes ☒ No _____
Contractor GYTCHISON
Special Conditions GYTCHISON

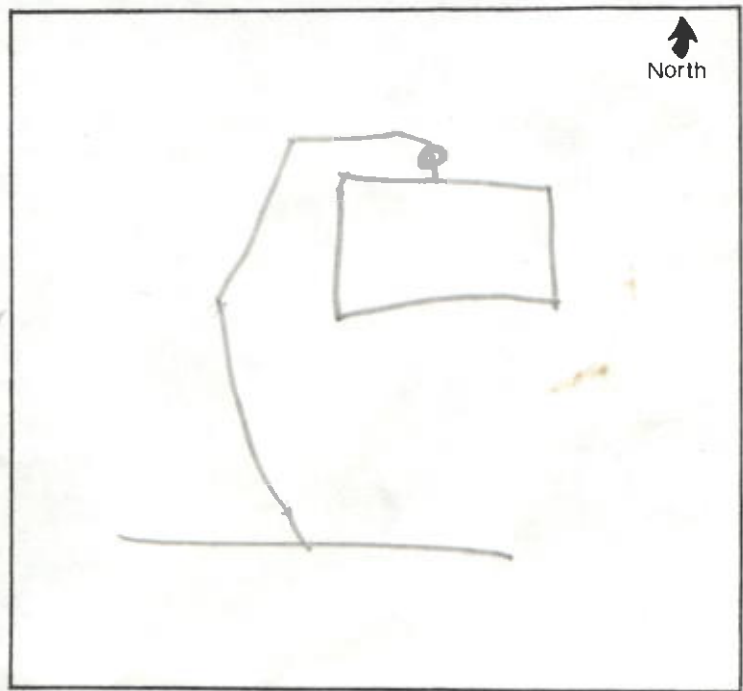

5 PM

FALL GREEN REGIONAL WASTE DISTRICT

Box 44, Readington, Indiana 45864



NA 000884

11-18-82

100 W. Talley Ave.
Kirk's Beer

4000

528-7108

120.00

32.00

Enclosed is money order for \$120.00 for the purchase of 4000 bottles of Kirk's Beer. The money order is payable to the order of the Fall Green Regional Waste District.

All enclosed bottles are to be returned to the Fall Green Regional Waste District. The bottles are to be returned in the original containers and are to be returned to the district by the date indicated on the label. The bottles are to be returned to the district in the original containers and are to be returned to the district by the date indicated on the label.

The enclosed bottles are to be returned to the Fall Green Regional Waste District. The bottles are to be returned in the original containers and are to be returned to the district by the date indicated on the label. The bottles are to be returned to the district in the original containers and are to be returned to the district by the date indicated on the label.

The enclosed bottles are to be returned to the Fall Green Regional Waste District. The bottles are to be returned in the original containers and are to be returned to the district by the date indicated on the label. The bottles are to be returned to the district in the original containers and are to be returned to the district by the date indicated on the label.

The enclosed bottles are to be returned to the Fall Green Regional Waste District. The bottles are to be returned in the original containers and are to be returned to the district by the date indicated on the label. The bottles are to be returned to the district in the original containers and are to be returned to the district by the date indicated on the label.

The enclosed bottles are to be returned to the Fall Green Regional Waste District. The bottles are to be returned in the original containers and are to be returned to the district by the date indicated on the label. The bottles are to be returned to the district in the original containers and are to be returned to the district by the date indicated on the label.

The enclosed bottles are to be returned to the Fall Green Regional Waste District. The bottles are to be returned in the original containers and are to be returned to the district by the date indicated on the label. The bottles are to be returned to the district in the original containers and are to be returned to the district by the date indicated on the label.

The enclosed bottles are to be returned to the Fall Green Regional Waste District. The bottles are to be returned in the original containers and are to be returned to the district by the date indicated on the label. The bottles are to be returned to the district in the original containers and are to be returned to the district by the date indicated on the label.

The enclosed bottles are to be returned to the Fall Green Regional Waste District. The bottles are to be returned in the original containers and are to be returned to the district by the date indicated on the label. The bottles are to be returned to the district in the original containers and are to be returned to the district by the date indicated on the label.

The enclosed bottles are to be returned to the Fall Green Regional Waste District. The bottles are to be returned in the original containers and are to be returned to the district by the date indicated on the label. The bottles are to be returned to the district in the original containers and are to be returned to the district by the date indicated on the label.

The enclosed bottles are to be returned to the Fall Green Regional Waste District. The bottles are to be returned in the original containers and are to be returned to the district by the date indicated on the label. The bottles are to be returned to the district in the original containers and are to be returned to the district by the date indicated on the label.

