

NOTE:  
ADDITIONAL RIGHT-OF-WAY OR EASEMENTS MAY  
NEED TO BE ACQUIRED FOR INSTALLATION OF SEWER.



DON'T DIG BLIND  
CALL BEFORE YOU DIG  
1-800-382-5544  
1-800-428-5200

PER INDIANA STATE LAW IS-69-1991, IT IS  
AGAINST THE LAW TO EXCAVATE WITHOUT  
NOTIFYING THE UNDERGROUND LOCATION SERVICE  
TWO (2) WORKING DAYS BEFORE COMMENCING WORK.  
NOTE: CONTRACTOR TO VERIFY ALL UTILITY LOCATIONS  
PRIOR TO THE START OF CONSTRUCTION

GRAVITY SEWER IS PART OF  
THE WHITE OAKS ADDITION  
CONTRACT "A-1"

STRUCTURE No. WR-OS7  
STANDARD MANHOLE  
T.C. = 679.34 879.83  
INV.(N) = 674.73 871.67  
INV.(S) = 674.74 871.66

FOR CONTINUATION  
SEE SHEET No. 12

STRUCTURE No. WR-OS6  
STANDARD MANHOLE  
T.C. = 678.24 878.71  
INV.(N) = 670.34 870.32  
INV.(S) = 870.29

STRUCTURE No. WR-OS5  
STANDARD MANHOLE  
T.C. = 674.24 873.67  
INV.(N) = 669.47 869.19  
INV.(S) = 669.15 869.17

STRUCTURE No. WR-OS4  
(SEE SHEET No. 3)

# RECORD DRAWING

February 15, 2001

## GENERAL NOTES:

- ALL UTILITY LOCATIONS ARE APPROXIMATE. THE CONTRACTOR SHALL HAVE ALL UTILITIES FIELD VERIFIED AND MARKED PRIOR TO CONSTRUCTION.
- CONTRACTOR SHALL MAINTAIN A MINIMUM 10'-0" HORIZONTAL AND 18" VERTICAL SEPARATION BETWEEN SEWER AND WATER MAINS.
- ALL PROPOSED TOP OF CASTING ELEVATIONS ARE APPROXIMATE. THE CONTRACTOR SHALL ADJUST FINAL ELEVATIONS AS REQUIRED TO BE FLUSH WITH PAVEMENT.
- ALL SEWER TRENCHES SHALL BE BACKFILLED WITH FULL DEPTH COMPACTED GRANULAR BACKFILL ("B" BORROW) UNDER OR WITHIN 5' OF EDGE OF PAVEMENT.
- THE CONTRACTOR SHALL VISIT THE SITE PRIOR TO BID TO BECOME FAMILIAR WITH ALL SITE CONDITIONS.
- THE CONTRACTOR SHALL PROVIDE THE REQUIRED MEANS FOR MAINTAINING SAFE TRAFFIC AT ALL TIMES.
- CONTRACTOR SHALL RESTORE ALL DISTURBED LAWN AREAS, STREETS, WALKS, DRIVES, ETC. AS SHOWN ON DRAWINGS, IN THE SPECIFICATIONS, OR TO AT LEAST PRE-EXISTING CONDITIONS.
- ALL UTILITY CROSSINGS SHALL BE PROTECTED AND SUPPORTED WITH GRANULAR FILL OR CONCRETE AS REQUIRED PER THE DETAIL SHEET.

## LEGEND:

- TREE
- POWER POLE
- GUY WIRE
- FIRE HYDRANT
- MAILBOX
- FLAGPOLE
- SPOT SHOT
- CONTOUR
- FENCE
- EXIST. SANITARY SEWER w/ MANHOLE
- EXISTING WATER WELL
- EXISTING SEPTIC TANK
- NEW SANITARY SEWER w/ MANHOLE
- NEW SANITARY SERVICE CONNECTION
- 4" W WATER LINE
- 2" G GAS LINE
- UNDERGROUND ELECTRIC LINE
- UNDERGROUND TELEPHONE LINE
- APPROX. RIGHT-OF-WAY
- APPROX. CORPORATE LIMITS
- APPROX. PROPERTY LINE



SCALE:  
HORIZONTAL 1" = 50'  
VERTICAL 1" = 5'

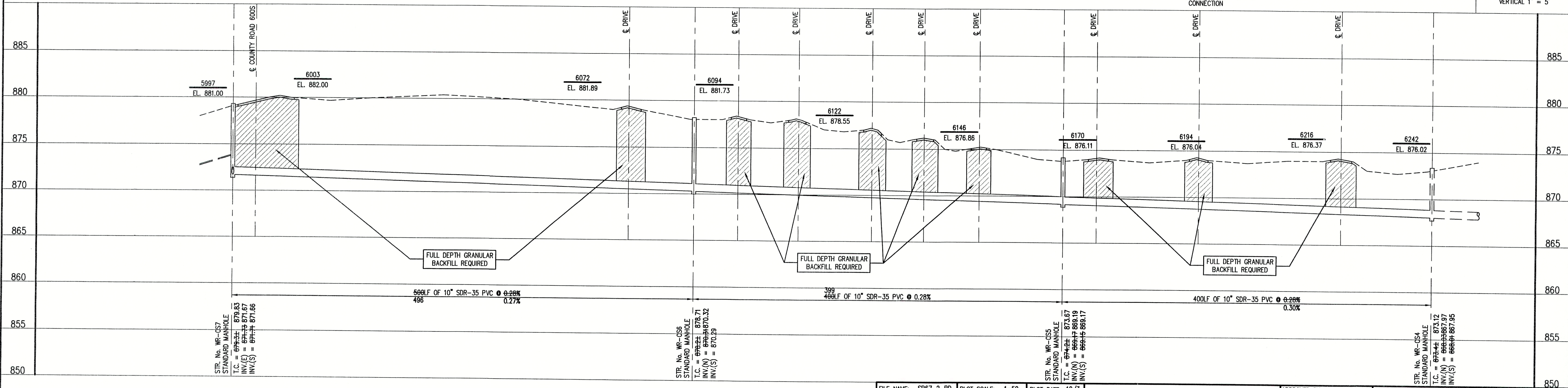

## NOTE:

THE CONTRACTOR SHALL INCLUDE IN THE COSTS FOR SANITARY PIPE, ALL WATER SERVICE RECONNECTIONS, STORM SEWER RECONNECTION, WATER MAIN RELOCATIONS, CONCRETE RECONSTRUCTION, AND SIDEWALK RECONSTRUCTION AS REQUIRED TO INSTALL NEW WORK AS SHOWN ON THE DRAWINGS.

NO.	DATE	DESCRIPTION	BY

**TRIAD ASSOCIATES INC.**  
INDIANAPOLIS, INDIANA

APPROVED BY:  
  
Thomas M. Schubert, P.E.

WOODED RIDGE SUBDIVISION  
FALL CREEK REGIONAL WASTE DISTRICT  
PLAN AND PROFILE  
DRAWN BY: DAP  
DATE: 04/12/98  
SCALE: AS NOTED  
PROJECT No.: 98008A  
SHEET No.: 4  
DESIGNED BY: D.A. Paullig  
CHECKED BY: James W. Frazell, P.E.