

PLOTTED BY: Johnson

PRINTED: 12/19/2019 @ 4:45PM

FILE NAME: G:\4635-FCRWD-US 36\Working Drawings\AutoCAD\4635-C-02.dwg

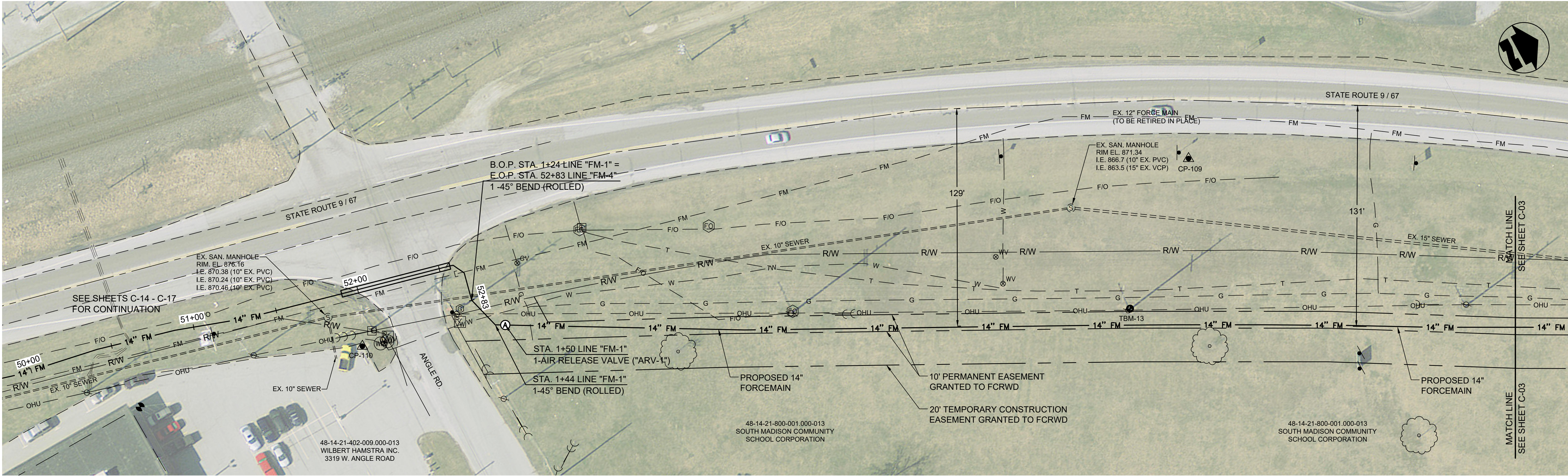

PLAN VIEW - B.O.P. STA. 0+00 TO STA. 7+50 LINE "FM-1"

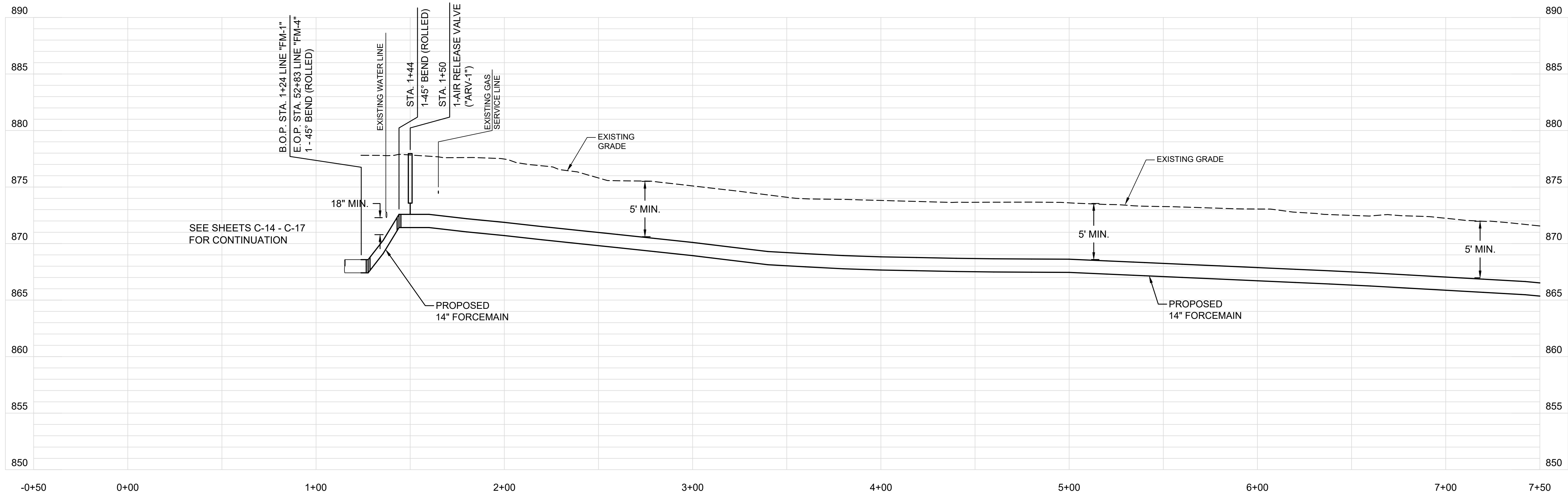

PROFILE - B.O.P. STA. 0+00 TO STA. 7+50 LINE "FM-1"

THIS RECORD DOCUMENT HAS BEEN PREPARED BASED ON INFORMATION PROVIDED BY THE CONSTRUCTION CONTRACTOR. GRW ENGINEERS, INC. HAS ATTEMPTED TO VERIFY THE ACCURACY AND/OR COMPLETENESS OF THIS INFORMATION BUT SHALL NOT BE RESPONSIBLE FOR ANY ERRORS OR OMISSIONS WHICH MAY BE INCORPORATED HEREIN AS A RESULT.

engineering | architecture | geospatial

ENGINEER/ARCHITECT: GEORGE LEWIS

CONSTRUCTION COMPANY: S.C. CASE EXCAVATING

DATE: 12/2019

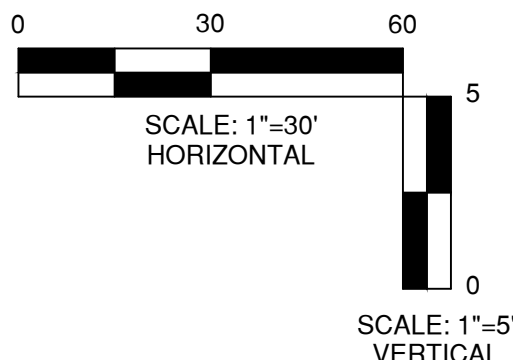

This document, originally issued, sealed, and signed by George W. Lewis, Indiana Professional Engineer, No. 10403303, on 7.2.2018, shall not be used in lieu of a certified document.

GRW PROJECT NO.	4635
CLIENT PROJECT NO.	-
ALL RIGHTS RESERVED. THIS DOCUMENT IS THE PROPERTY OF GRW ENGINEERS, INC. IT IS TO BE REPRODUCED IN WHOLE OR IN PART WITHOUT WRITTEN PERMISSION.	

engineering | architecture | geospatial

www.grwinc.com

PLAN AND PROFILE

LINE "FM-1"

US 36 FORCEMAIN REPLACEMENT

TOWN OF PENDLETON, INDIANA

NO.	DATE	BY	DESIGNED: GWL	DRAWN: JRD	REVIEWED: GWL	APPROVED: GWL
REVISIONS DESCRIPTION						
SCALE CHECK: THIS MARK SHOULD MEASURE EXACTLY 1" WHEN PLOTTED						
DATE: JULY 2018						
SCALE: 1"=30'						
SHEET NO.						

C-02