

- PROPOSED PROJECT GENERAL NOTES**
1. ALL SERVICE CONNECTIONS SHALL RUN FROM FORCEMAIN TO A SERVICE CONNECTION VALVE VAULT (SEE DETAIL, SHEET NO. 20) LOCATED ADJACENT TO AND WITHIN EXISTING PUBLIC RIGHT-OF-WAY.
 2. ALL SERVICE LINES SHALL BE BORED INTO PLACE BENEATH EXISTING ROADWAY.
 3. CONTRACTOR SHALL LOCATE ALL EXISTING SERVICE CONNECTIONS AND INSTALL A SERVICE CONNECTION VALVE VAULT ADJACENT TO AND WITHIN EXISTING PUBLIC RIGHT-OF-WAY.
 4. ALL PROPOSED INFORMATION ON THESE PLANS SHALL BE DENOTED WITH A HIGHLIGHT BOX. ALL OTHER NOTES ARE FOR INFORMATIONAL PURPOSES ONLY.

SCALE
HORIZONTAL SCALE: 1" = 50'
VERTICAL SCALE: 1" = 5'

PROFILE VIEW IS FOR INFORMATIONAL PURPOSES ONLY

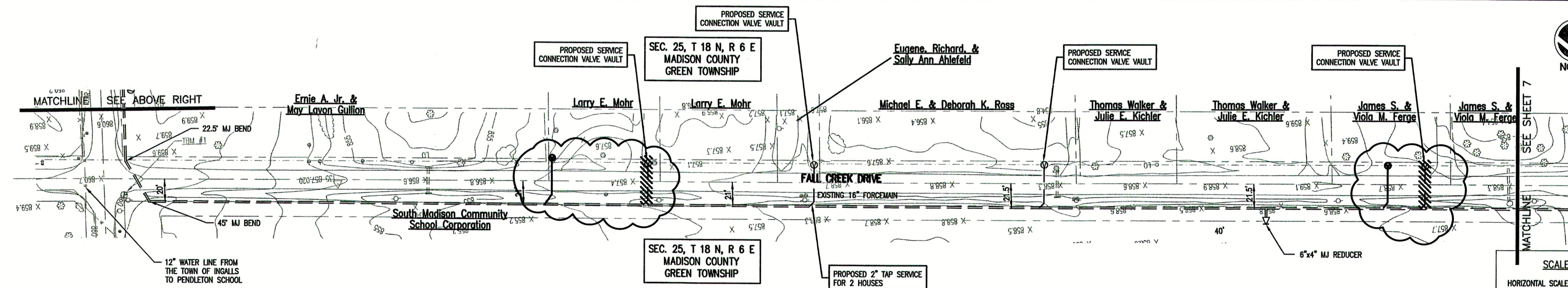
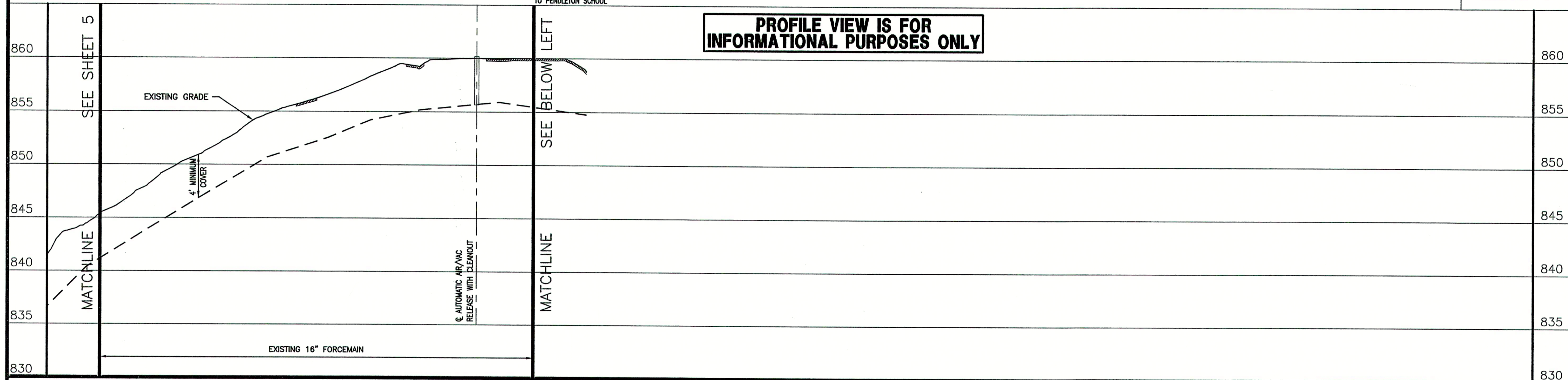

SCALE
HORIZONTAL SCALE: 1" = 50'
VERTICAL SCALE: 1" = 5'

PROFILE VIEW IS FOR INFORMATIONAL PURPOSES ONLY

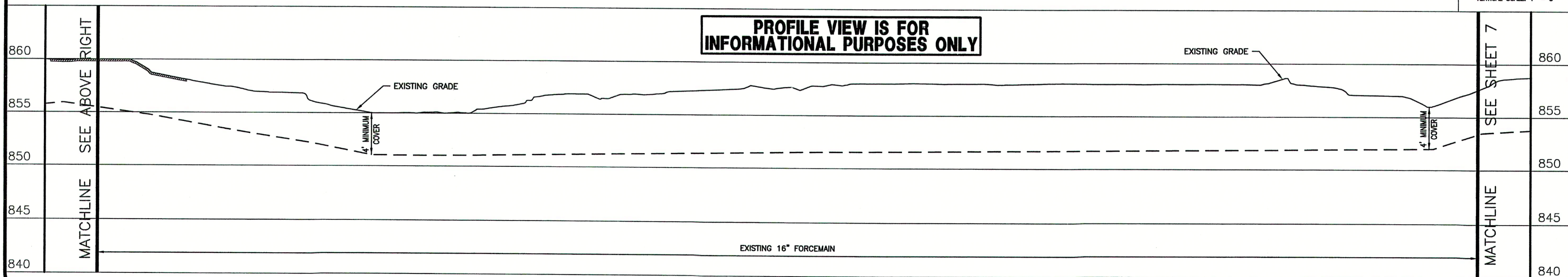

CONSULTANT:

REVISIONS:

DATE	DESCRIPTION	BY
12-8-04	REVISED PER F.C.R.W.D.	BKY
12-20-04	MISC. REVISIONS	BKY
5-18-06	RECORD DRAWINGS	CJF

APPROVED BY:



RECORD DRAWING

This drawing has been revised from the original contract drawings to show minor / major changes made during construction. This drawing is not warranted to be complete and accurate in all respects.

GRW Engineers, Inc.

Date: 5-18-06 By: CJF

THIS DRAWING AND THE IDEAS, DESIGNS AND CONCEPTS CONTAINED HEREIN ARE THE EXCLUSIVE INTELLECTUAL PROPERTY OF TRIAD ASSOCIATES, INC., AND ARE NOT TO BE USED OR REPRODUCED, IN WHOLE OR IN PART, WITHOUT THE WRITTEN CONSENT OF TRIAD ASSOCIATES, INC.

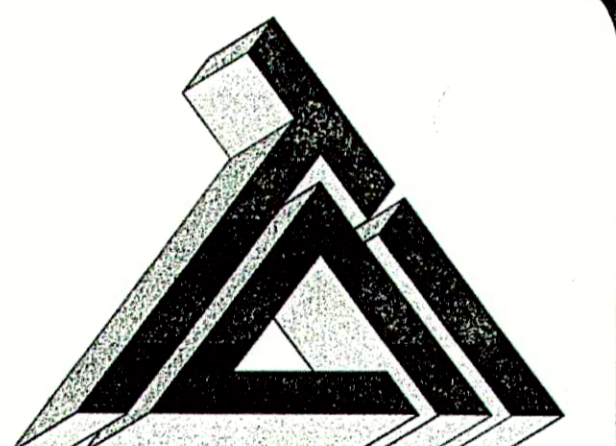

TRIAD ASSOCIATES INC.
5835 LAWTON LOOP EAST DRIVE
INDIANAPOLIS, INDIANA 46216
PHONE: 317-377-5230 FAX: 317-377-5241

DESIGNED FOR:

FALL CREEK REGIONAL WASTE DISTRICT
SANITARY SEWER ADDITIONAL
CONNECTIONS AND SERVICE CONNECTIONS

SHEET TITLE:

PROPOSED SERVICE CONNECTION PLAN
WITH EXISTING PLAN AND PROFILE

JOB NUMBER: 200402E	CHECKED BY: J.W.F.
SCALE: AS NOTED	PLOT DATE: 12/20/04
PLOT SCALE: 1" = 50'	DATE: NOVEMBER 2004
DRAWN BY: DAP	
DESIGNED BY: Michael P. Hunter, P.E.	
DRAWING NAME: 200402E-C6	

SHEET No.

6

OF 21