

LEGEND:	
[S]	EXISTING STONE DRIVE
[A]	EXISTING ASPHALT DRIVE
840	EXISTING CONTOUR
X	EXISTING FENCE
⊗	EXISTING TREE/BUSH
— — — — —	EXISTING DRAINAGE PIPE
MH	EXISTING MANHOLE
DI	EXISTING DRAINAGE INLET
○	EXISTING POWER POLE
••	EXISTING GUY WIRES
☆	EXISTING LIGHT POLE
⊙	EXISTING MAILBOX
- - - - -	EXISTING SECTION LINE
- - - - -	EXISTING PROPERTY LINE
- - - - -	EXISTING RIGHT-OF-WAY LINE
- - - - -	EXISTING EASEMENT
- - - - -	PROPOSED EASEMENT
- - - - -	EXISTING SHORE LINE
G	EXISTING GAS LINE
W	EXISTING WATER LINE
E	EXISTING UNDERGROUND ELECTRIC LINE
— — — — —	PROPOSED FORCEMAIN LOCATION
●	PROPOSED AIR/VAC RELEASE
⋈	PROPOSED VALVE w/ BOX & RISER
— — — — —	PROPOSED SERVICE CONNECTION
W●	PROPOSED VALVE VAULT

UTILITIES:	
VECTREN ENERGY DELIVERY 2001 LOUISE STREET ANDERSON, INDIANA 46016-3741 CONTACT: MR. BRIAN HARGER TEL: (765) 648-3205	
CINERGY / PSI 100 MILL CREEK ROAD NOBLESVILLE, INDIANA 46060 CONTACT: MR. TRACY GRADY TEL: (317) 776-5352	
INGALLS WATER 249 NORTH MERIDIAN STREET INGALLS, INDIANA 46048 CONTACT: MR. RANDY McVAY TEL: (317) 485-4321	
SPRINT 50 NORTH JACKSON STREET FRANK, INDIANA 46131-2346 CONTACT: MS. NANCY PICKEREL TEL: (317) 736-5309	
INSIGHT COMMUNICATIONS 335 EAST 10th STREET ANDERSON, INDIANA 46016 CONTACT: MR. MIKE ETHRINGTON TEL: (765) 649-5228	

TEMPORARY BENCHMARK INFORMATION:	
TBM #1a	BOX NOTCH CUT IN THE NORTHWEST CORNER OF THE SECOND LIGHT POLE CONCRETE PAD. THIS TBM IS ON THE TREATMENT PLANT SITE. ELEV. 842.36
TBM #1	SPIKE IN THE SOUTHEAST SIDE OF POWERPOLE #065277 AT THE NORTHWEST QUADRANT OF COUNTY ROAD 650W AND FALL CREEK DRIVE. ELEV. 861.26
TBM #2	SPIKE IN THE SOUTH SIDE OF POWERPOLE #B-2 98 SPPA 454 40 EAST OF 7144 FALL CREEK DRIVE. ELEV. 859.41
TBM #3	SPIKE IN THE SOUTHWEST SIDE OF POWERPOLE AT THE NORTH SIDE OF THE ROAD AT FALL CREEK DRIVE AND COUNTY ROAD 750W. ELEV. 854.43
TBM #4	SPIKE IN A POLE LOCATED 100 FEET WEST OF THE INTERSECTION OF COUNTY ROAD 900S AND COUNTY ROAD 750W. ELEV. 853.20
TBM #5	RAILROAD SPIKE WHICH WAS FOUND AT THE INTERSECTION OF COUNTY ROAD 800W AND COUNTY ROAD 875S. ELEV. 861.90
TBM #6	SPIKE IN THE WEST SIDE OF POWERPOLE #064-393 AT COUNTY ROAD 800S AND COUNTY ROAD 800W. ELEV. 868.44
TBM #7	SPIKE IN THE NORTH SIDE OF POWERPOLE ON COUNTY ROAD 800S. ELEV. 850.14
TBM #8	NOTCHED SQUARE IN WESTERLY BASE OF A LIGHT POLE ON THE NORTH SIDE OF THE I-69 NORTH BOUND ON RAMP. ELEV. 857.56

GENERAL NOTES:	
1.	CONTRACTOR TO FIELD VERIFY ALL EXISTING UTILITIES, STRUCTURES, ELEVATIONS, ETC. PRIOR TO CONSTRUCTION.
2.	ALL DISTURBED AREAS TO BE RESTORED TO ORIGINAL CONDITION IF NOT SPECIFIED OTHERWISE.
3.	ALL 90° PIPING TURNS SHALL BE DONE WITH TWO (2) D.I.M.J. 45° ELBOWS UNLESS OTHERWISE SPECIFIED.
4.	SEE SHEET 12 FOR THRUST BLOCKING/RESTRAINED JOINT DETAILS.
5.	CONTRACTOR TO TAKE ALL NECESSARY PRECAUTIONS TO PROTECT EXISTING STRUCTURES DURING CONSTRUCTION.
6.	SEE DETAIL SHEET 11 FOR PIPE BEDDING REQUIREMENTS.
7.	SEE SHEETS 4 - 9 FOR FURTHER PROPOSED STRUCTURE AND SITE INFORMATION.
8.	SEE DETAIL SHEET 11 FOR STANDARD MANHOLE DETAILS.
9.	CONTRACTOR TO COORDINATE WITH ALL MECHANICAL AND ELECTRICAL WORK TO BE REQUIRED.
10.	CONTRACTOR SHALL CONTACT ALL UTILITIES FOR LOCATION OF EXISTING SERVICES FOR THE FORCEMAIN ROUTE PRIOR TO CONSTRUCTION.

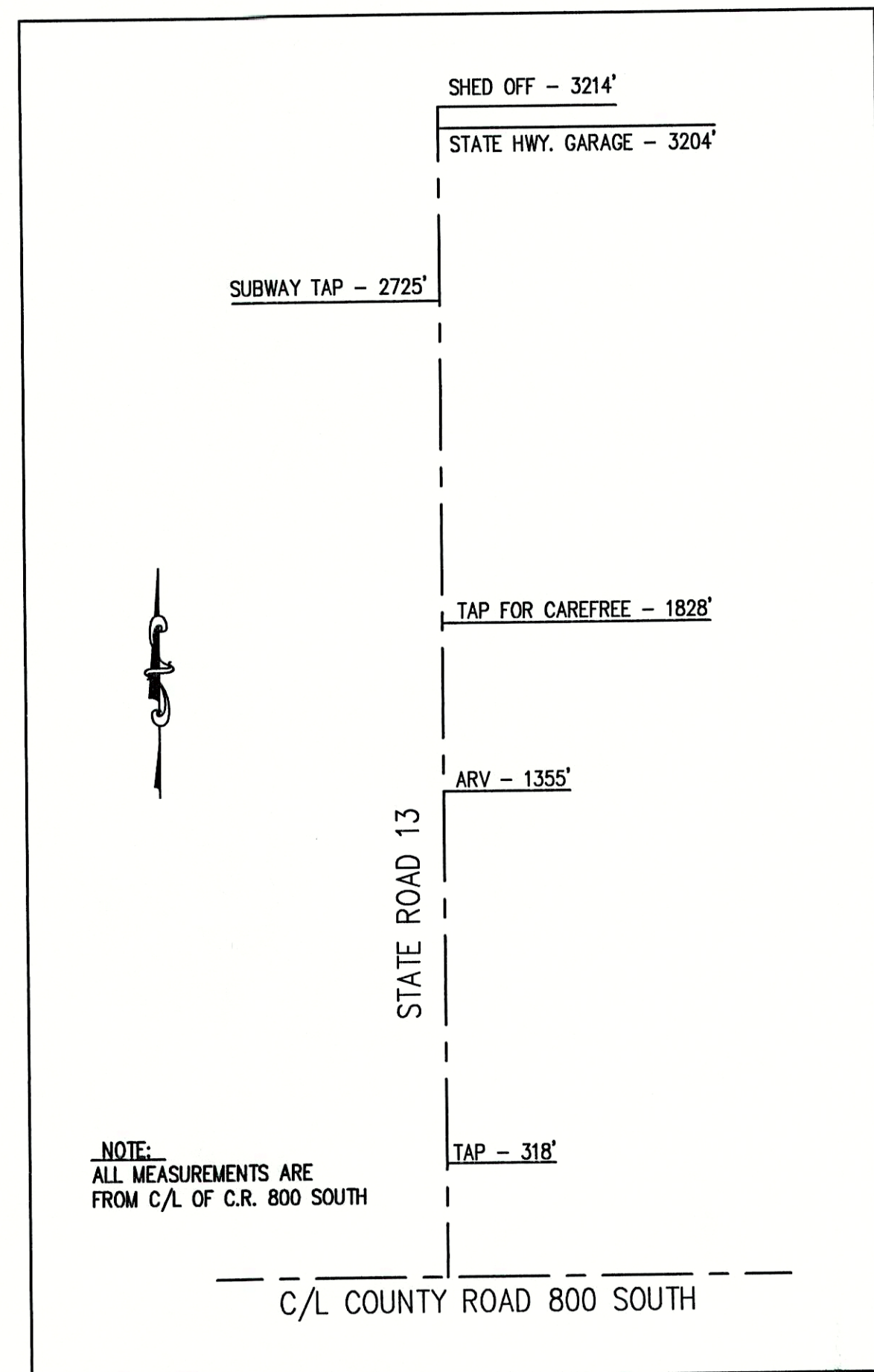

SHEET INDEX:	
SHEET No.	SHEET DESCRIPTION
1	TITLE SHEET
2	INDEX SHEET
3	PROJECT BASE MAP
4-6	PLAN AND PROFILE SHEETS
7	BRIDGE BORING SECTION
8-9	STANDARD DETAIL SHEETS

NOTE:
ADDITIONAL RIGHT-OF-WAY OR EASEMENTS MAY NEED TO BE ACQUIRED FOR INSTALLATION OF SEWER.

**DO NOT DIG BLIND
CALL BEFORE YOU DIG**
TOLL FREE 1-800-382-5544
LOCAL 1-800-428-5200

PER INDIANA STATE LAW IS-69-1991, IT IS AGAINST THE LAW TO EXCAVATE WITHOUT NOTIFYING THE UNDERGROUND LOCATION SERVICE TWO (2) WORKING DAYS BEFORE COMMENCING WORK.

NOTE: CONTRACTOR TO VERIFY ALL UTILITY LOCATIONS PRIOR TO THE START OF CONSTRUCTION

RECORD DRAWING
FEBRUARY 17, 2003

CONSULTANT:

REVISIONS:

DATE	DESCRIPTION	BY

APPROVED BY:

THIS DRAWING AND THE IDEAS, DESIGNS AND CONCEPTS CONTAINED HEREIN ARE THE EXCLUSIVE INTELLECTUAL PROPERTY OF TRIAD ASSOCIATES, INC., AND ARE NOT TO BE USED OR REPRODUCED, IN WHOLE OR IN PART, WITHOUT THE WRITTEN CONSENT OF TRIAD ASSOCIATES, INC.

TRIAD ASSOCIATES INC.
5835 LAWTON LOOP EAST DRIVE
INDIANAPOLIS, INDIANA 46216
PHONE: 317-377-5230 FAX: 317-377-5241

DESIGNED FOR:
FALL CREEK REGIONAL WASTE DISTRICT
STATE ROAD 13 SANITARY
SEWER FORCEMAIN EXTENSION PROJECT

SHEET TITLE:
PLAN AND PROFILE SHEET

JOB NUMBER: 200202F	CHECKED BY: J.W.F.
SCALE: AS NOTED	PLOT DATE: 08/16/02
PLOT SCALE: 1" = 1'	DATE: JULY 2002
DRAWN BY: B.K.Y.	DESIGNED BY: THOMAS M. SCHUBERT, P.E.
DRAWING NAME: 200202FIND-RD.DWG	

SHEET No.
2
OF 9