

RECORD DRAWING  
SANITARY SEWER AS-BUILTS  
SANITARY SEWER STRUCTURES ONLY  
5/5/2020  
JOSEPH TRTAN, LS21500003

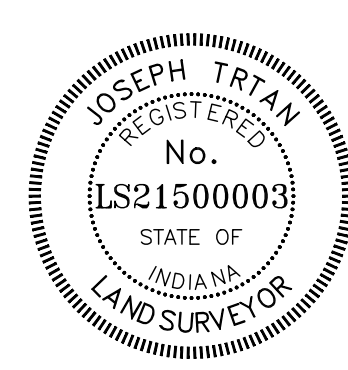

- LEGEND**
- RIGHT-OF-WAY LINE
  - PROPOSED STORM SEWER LINE
  - EXISTING STORM SEWER LINE
  - SWALE
  - SSD
  - PROPOSED SANITARY SEWER LINE
  - EXISTING SANITARY SEWER LINE
  - SANITARY SEWER MANHOLE
  - SANITARY SEWER LATERAL
  - PROPOSED WATER LINE
  - FLOW DIRECTION
  - EXISTING CONTOURS
  - PROPOSED ELEVATION
  - FINISHED PAVEMENT GRADE
  - STORM BEEHIVE INLET
  - STORM INLET
  - TOP OF CASTING
  - INVERT
  - REINFORCED CONCRETE PIPE
  - M.H.
  - STR.
  - STRUCTURE
  - DRAINAGE EASEMENT
  - DRAINAGE AND UTILITY EASEMENT
  - DRAINAGE, UTILITY AND SANITARY SEWER EASEMENT
  - CONCRETE END SECTION
  - MATCH EXISTING
  - TYP.
  - PROP.
  - EX.
  - R.
  - V.W.
  - MAG.
  - ROW
  - B-B
  - B.S.L.
  - HP
  - HP
  - ADA RAMP
  - FIRE HYDRANT
  - BLOWOFF ASSEMBLY
  - PROPOSED ASPHALT PATH

- ASBUILT INFORMATION
  - BUILT AS PLANNED
  - ASBUILT SANITARY SEWER STUB
- DATE OF LAST FIELDWORK: 4/29/2020

**SANITARY SEWER NOTES**

- THE CONTRACTOR SHALL CONTACT APPLICABLE UNDERGROUND-PLANT PROTECTION/LOCATION SERVICE AT LEAST 72 HOURS PRIOR TO ANY WORK.
- THE CONTRACTOR SHALL CONTACT THE OWNER AND/OR ENGINEER IF UTILITIES APPEAR TO BE IN CONFLICT WITH THE PROPOSED IMPROVEMENTS. IT SHALL BE THE RESPONSIBILITY OF THE CONTRACTOR TO RELOCATE ALL EXISTING UTILITIES WHICH CONFLICT WITH THE PROPOSED IMPROVEMENTS SHOWN ON THE PLANS.
- THE PLANS SHOW THE LOCATION OF ALL KNOWN UTILITIES LOCATED WITHIN THE LIMITS OF CONSTRUCTION ACCORDING TO INFORMATION PROVIDED BY THE VARIOUS UTILITY COMPANIES. PREVIOUS CONSTRUCTION PLANS AND AS EVIDENCED BY OBSERVATION OF ABOVE GROUND CONDITIONS BY THE SURVEYOR. THE ACCURACY OF THIS INFORMATION IS NOT GUARANTEED.
- THE LOCATION AND PROTECTION OF UTILITY STRUCTURES, THEIR SUPPORT AND MAINTENANCE DURING CONSTRUCTION (IN COOPERATION WITH APPLICABLE UTILITY COMPANY) IS THE EXPRESS RESPONSIBILITY OF THE CONTRACTOR.
- THE CONTRACTOR SHALL CONTACT ALL APPLICABLE UTILITY OWNERS TO VERIFY ANY AND ALL FEES ASSOCIATED WITH THE INSTALLATION OF UTILITIES.
- ALL CONSTRUCTION ON THIS SITE TO BE PERFORMED IN COMPLIANCE WITH O.S.H.A. STANDARDS FOR WORKER SAFETY.
- ANY PART OF SANITARY TRENCHES RUNNING UNDER OR WITHIN 5' OF PAVEMENT TO BE BACKFILLED WITH GRANULAR MATERIAL.
- IT IS THE CONTRACTORS RESPONSIBILITY TO VERIFY LOCATION, SIZE, AND ELEVATION OF EXISTING UTILITIES, STRUCTURES, PIPES, PAVEMENTS, ETC. AS RELATED TO THEIR WORK. NOTIFY ENGINEER OF ANY CONFLICT AND/OR DISCREPANCIES IN THE CONSTRUCTION DOCUMENTS.
- CLEARANCE BETWEEN STORM / SANITARY SEWER SYSTEMS AND DOMESTIC/FIRE LINE SERVICE, SHALL MAINTAIN 10" HORIZONTAL AND 18" VERTICAL.
- CONTRACTOR TO INSTALL CONCRETE CRADLES AT PIPE CROSSING WHEN THE VERTICAL SEPARATION (AS MEASURED FROM THE EXTERIOR OF THE PIPES) BETWEEN SANITARY SEWERS, WATER MAINS AND STORM SEWERS IS 18" OR LESS.
- SANITARY SEWER LINE IN PROXIMITY OF WATER LINE SHALL BE C900 WATER MAIN GRADE PVC.
- IF ANY EXISTING STRUCTURES TO REMAIN ARE DAMAGED DURING CONSTRUCTION, IT SHALL BE THE CONTRACTOR'S RESPONSIBILITY TO REPAIR AND/OR REPLACE THE EXISTING STRUCTURE AS NECESSARY TO RETURN IT TO ITS CONDITION PRIOR TO CONSTRUCTION.
- WHEN PERFORMING EXCAVATIONS DURING PERIODS OF WET WEATHER, PROVIDE ADEQUATE DEWATERING, DRAINAGE AND GROUND WATER MANAGEMENT TO CONTROL MOISTURE OF SOILS.
- COMPACTED "B" BORROW BACK FILL REQUIRED OVER ALL UTILITIES IN PAVED AREAS.
- ALL UTILITY STRUCTURES IN PAVED AREAS SHALL BE FLUSH WITH PAVEMENT AND SHALL HAVE TRAFFIC BEARING RINGS AND COVERS RATED FOR H20 LOADING.
- FOLLOW ALL LOCAL AND STATE CODES IN REFERENCE TO SANITARY SEWER INSTALLATION.
- SANITARY SEWER LATERALS SHALL BE BACKFILLED WITH GRANULAR MATERIAL FOR THE ENTIRE LENGTH OF THE PIPE.

**PROJECT BENCHMARK - G236**  
DESCRIBED BY COAST AND GEODETIC SURVEY 1947:  
"4 MI N FROM FORTVILLE, ABOUT 4.05 MILES NORTH ALONG STATE HIGHWAY 13 FROM ITS JUNCTION WITH STATE HIGHWAY 288 AT FORTVILLE, AT CENTER SCHOOL, SET VERTICALLY IN THE WEST FACE OF THE CONCRETE FOUNDATION OF THE BRICK SCHOOL, 1.5 FEET SOUTH OF THE NORTHWEST CORNER AND 1.3 FEET ABOVE THE GROUND."  
ELEV. 864.15 NAVD 88

**SITE TEMPORARY BENCHMARK**  
RAILROAD SPIKE IN POWERPOLE LOCATED 76 FEET SOUTH AND 33 FEET WEST OF THE NORTHWEST CORNER OF THE SURVEYED REAL ESTATE.  
ELEV. 845.87 NAVD 88

**VERTICAL SCALE:**  
1" = 50'

**HORIZONTAL SCALE:**  
1" = 50'

**811**  
Know what's below.  
Call before you dig.  
Within Indiana Call  
811 or 800-382-5544  
24 Hours a Day, 7 Days a Week.  
PER INDIANA STATE LAW IC 8-1-26.  
IT IS AGAINST THE LAW TO EXCAVATE WITHOUT NOTIFYING THE UNDERGROUND LOCATION SERVICE TWO (2) WORKING DAYS BEFORE COMMENCING WORK.

10505 N. College Avenue  
Indianapolis, Indiana 46280  
weihe.net

317 846 - 6611  
800 452 - 6408  
317 843 - 0546 fax

ALLAN H. WEIHE, P.E., L.S. - FOUNDER

**WEIHE ENGINEERS**  
Land Surveying | Civil Engineering  
Landscape Architecture

PROJECT NO.: W170338-1  
BY: JANE A. SHARPER  
DATE: 04/04/2018

REVISIONS AND ISSUES

JANE A. SHARPER  
No. 890258  
PROFESSIONAL ENGINEER  
DUANE A. SHARPER P.E. 890258

Prepared For:  
**Oakmont Section One - Ingalls, IN**  
GRADISON LAND DEVELOPMENT  
SANITARY PLAN AND PROFILE  
SECTION 28, TOWNSHIP 18 NORTH, RANGE 6 EAST, MADISON COUNTY, INDIANA

SHEET NO.: **C502**  
PROJECT NO.: **W170338**

LOCATION: J:\2017\W170338\Section 1\Engineering\Design\Subarea\AB\_C500 Sanitary Profile.dwg  
DATE/TIME: May 05, 2020 - 3:56pm  
PLOTTER: HP DesignJet 500