

- GENERAL NOTES:**
1. WYES AND LATERALS TO BE 6" PIPE UNLESS OTHERWISE NOTED.
 2. ALL WYE CONNECTIONS SHALL HAVE A MINIMUM OF FIVE (5) FEET OF FIVE FOOT LATERAL EXTENSION CONNECTED TO THE WYE. THE END OF THE LATERAL SHALL BE CAPPED AND MARKED WITH AN ABOVE GROUND MARKER.
 3. IT SHALL BE THE CONTRACTOR'S RESPONSIBILITY TO FIELD VERIFY ALL UTILITY LOCATIONS PRIOR TO BEGINNING CONSTRUCTION.
 4. TEMPORARY TRAFFIC CONTROL DURING CONSTRUCTION TO CONFORM TO APPLICABLE LOCAL AND STATE STANDARDS.
 5. ALL CONSTRUCTION ACTIVITY ON THIS SITE TO BE PERFORMED IN COMPLIANCE WITH APPLICABLE O.S.H.A. STANDARDS FOR WORKER SAFETY.
 6. WYE & LATERAL STATION LOCATIONS ARE FROM THE NEAREST DOWNSTREAM MANHOLE.

INDICATES #3 GRANULAR BACKFILL

CONNECTIONS TO MANHOLES WITH CONNECTIONS GREATER THAN FIFTEEN (15) FEET SHALL BE ENCASED WITH A QUICK SET GROUT ON THE INSIDE OF THE FLEXIBLE BOOT CONNECTION AND A NO. 4 SLUMP CONCRETE MIX ON THE OUTSIDE TO PREVENT THE BOOT FROM INVERTING.

ALL MANHOLES TO BE STANDARD MANHOLES - SEE DETAIL SHEET C803.
ALL CASTINGS TO BE NEENAH R-1772-AWH FRAME w/TYPE "B" LID DESIGN.

ALL SANITARY SEWER CONSTRUCTION TO CONFORM TO LATEST STANDARDS OF THE FALL CREEK REGIONAL WASTE DISTRICT.

SCALE:
HORZ. 1" = 40'
VERT. 1" = 4'

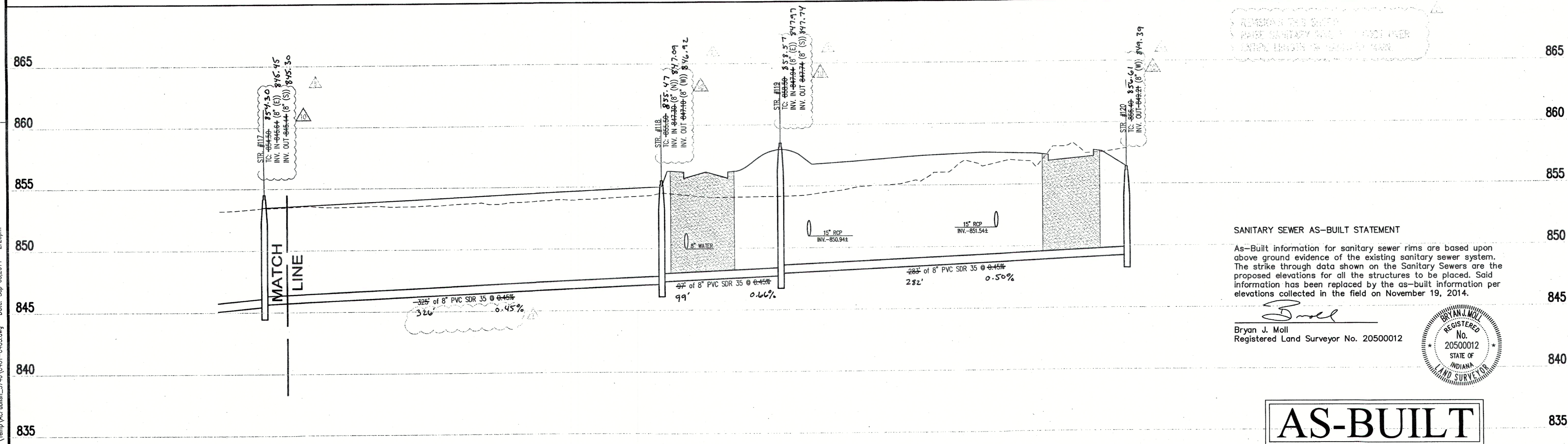

SANITARY SEWER AS-BUILT STATEMENT

As-Built information for sanitary sewer rims are based upon above ground evidence of the existing sanitary sewer system. The strike through data shown on the Sanitary Sewers are the proposed elevations for all the structures to be placed. Said information has been replaced by the as-built information per elevations collected in the field on November 19, 2014.

Bryan J. Moll
Registered Land Surveyor No. 20500012

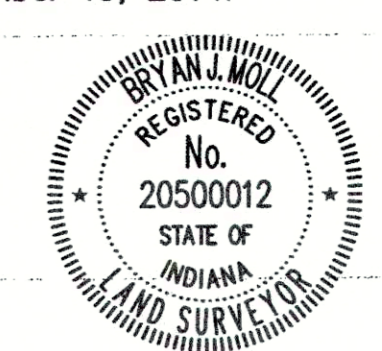

AS-BUILT

Love's Travel Stops & Country Stores, Inc.
10601 PENNSYLVANIA AVE.
OKLAHOMA CITY, OK 73120

Love's Travel Stop & Country Store - Store #600
9000 West Interpark Drive, Tugala, Indiana 46048

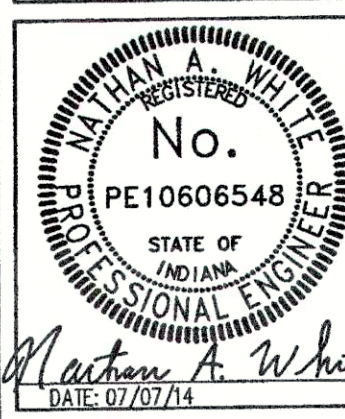

DATE: 05/15/13
ISSUED: 7/7/14
JOB NUMBER: 12110
SHEET # C403