

NOTE:

ADDITIONAL RIGHT-OF-WAY OR EASEMENTS MAY
NEED TO BE ACQUIRED FOR INSTALLATION OF SEWER.



DON'T DIG BLIND
CALL BEFORE YOU DIG
TOLL FREE
1-800-382-5544
OUTLINE SERVICE
1-800-428-5200

PER INDIANA STATE LAW IS-69-1991, IT IS
AGAINST THE LAW TO EXCAVATE WITHOUT
NOTIFYING THE UNDERGROUND LOCATION SERVICE
TWO (2) WORKING DAYS BEFORE COMMENCING WORK.

NOTE: CONTRACTOR TO VERIFY ALL UTILITY LOCATIONS
PRIOR TO THE START OF CONSTRUCTION

GENERAL NOTES:

- ALL UTILITY LOCATIONS ARE APPROXIMATE. THE CONTRACTOR SHALL HAVE ALL UTILITIES FIELD VERIFIED AND MARKED PRIOR TO CONSTRUCTION.
- CONTRACTOR SHALL MAINTAIN A MINIMUM 10'-0" HORIZONTAL AND 18" VERTICAL SEPARATION BETWEEN STORM SEWER AND WATER MAINS.
- ALL PROPOSED TOP OF CASTING ELEVATIONS ARE APPROXIMATE. THE CONTRACTOR SHALL ADJUST FINAL ELEVATIONS AS REQUIRED TO BE FLUSH WITH PAVEMENT.
- ALL STORM SEWER TRENCHES SHALL BE BACKFILLED WITH FULL DEPTH COMPACTED GRANULAR BACKFILL ("B" BORROW) UNDER OR WITHIN 5' OF EDGE OF PAVEMENT.
- THE CONTRACTOR SHALL VISIT THE SITE PRIOR TO BID TO BECOME FAMILIAR WITH ALL SITE CONDITIONS.
- THE CONTRACTOR SHALL PROVIDE THE REQUIRED MEANS FOR MAINTAINING SAFE TRAFFIC AT ALL TIMES.
- CONTRACTOR SHALL RESTORE ALL DISTURBED LAWN AREAS, STREETS, WALKS, DRIVES, ETC. AS SHOWN ON DRAWINGS, IN THE SPECIFICATIONS, OR TO AT LEAST PRE-EXISTING CONDITIONS.
- ALL UTILITY CROSSINGS SHALL BE PROTECTED AND SUPPORTED WITH GRANULAR FILL OR CONCRETE AS REQUIRED PER THE DETAIL SHEET.
- THE CONTRACTOR SHALL INCLUDE IN THE PRICE FOR EACH NEW CURB INLET THE REMOVAL AND REPLACEMENT OF AT LEAST 10' OF CONCRETE CURB AND GUTTER (5' EACH SIDE OF INLET) AS REQUIRED.
- THE CONTRACTOR SHALL SALVAGE ALL INLET AND MANHOLE CASTINGS REMOVED DURING CONSTRUCTION FOR THE OWNERS USE.
- ALL INLETS ARE TO INCLUDE RECONNECTION, ALL EXCAVATION, PIPE MATERIAL, ETC. REQUIRED TO COMPLETE ALL RESTORATION.

•	TREE	1085	CONTOUR	---	E---	UNDERGROUND ELECTRIC LINE
○	POWER POLE	X	FENCE	---	T---	UNDERGROUND TELEPHONE LINE
+	GUY WIRE	MH	EXIST. SANITARY SEWER w/ MANHOLE	---	---	APPROX. RIGHT-OF-WAY
+	FIRE HYDRANT	SC	NEW SANITARY SEWER w/ MANHOLE	---	---	APPROX. CORPORATE LIMITS
+	MAILBOX	SC	NEW SANITARY SERVICE CONNECTION	---	---	APPROX. PROPERTY LINE
+	FLAGPOLE	4" W	WATER LINE	○	W	EXISTING WATER WELL
X 1085.2	SPOT SHOT	2" 0	GAS LINE	■	S	EXISTING SEPTIC TANK
				WVO		PROPOSED GRINDER PUMP VALVE VAULT



SCALE:
HORIZONTAL 1" = 50'
VERTICAL 1" = 5'

RECORD DRAWING

February 15, 2001

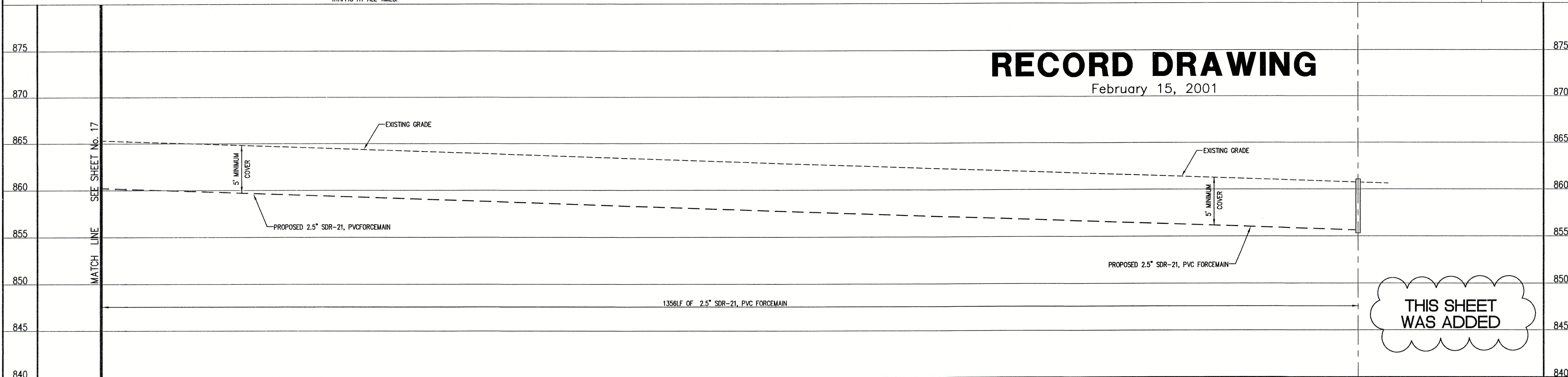

1356LF OF 2.5" SDR-21, PVC FORCEMAIN

THIS SHEET
WAS ADDED

NOTE:

THE CONTRACTOR SHALL INCLUDE IN THE COSTS FOR STORM PIPE,
ALL WATER SERVICE RECONNECTIONS, SANITARY SEWER SERVICE
RECONNECTIONS, WATER MAIN RELOCATIONS, CONCRETE RECONSTRUCTION,
AND SIDEWALK RECONSTRUCTION AS REQUIRED TO INSTALL NEW WORK
AS SHOWN ON THE DRAWINGS.

FILE NAME: RED_OAK-RD PLOT SCALE: 1=50 PLOT DATE: 11/14

NO.	DATE	DESCRIPTION	BY

TRIAD
ASSOCIATES
INC.
INDIANAPOLIS, INDIANA

APPROVED BY:

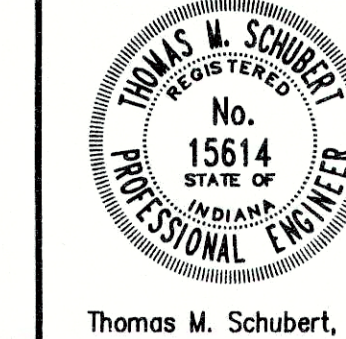

Thomas M. Schubert, P.E.

OLD STATE ROAD No. 132
FALL CREEK REGIONAL WASTE DISTRICT

PLAN AND PROFILE

DRAWN BY:	DATE	04/12/98	PROJECT No.	98008A	SHEET No.	17A
DAP	SCALE	AS NOTED				
DESIGNED BY:	D.A. Pauling					
CHECKED BY:	James W. Frazell, P.E.					

19

OF