

NOTE:
ADDITIONAL RIGHT-OF-WAY OR EASEMENTS MAY NEED TO BE ACQUIRED FOR INSTALLATION OF SEWER.



PER INDIANA STATE LAW 15-69-1991, IT IS AGAINST THE LAW TO EXCAVATE WITHOUT NOTIFYING THE UNDERGROUND LOCATION SERVICE TWO (2) WORKING DAYS BEFORE COMMENCING WORK.
NOTE: CONTRACTOR TO VERIFY ALL UTILITY LOCATIONS PRIOR TO THE START OF CONSTRUCTION

GENERAL NOTES:

- ALL UTILITY LOCATIONS ARE APPROXIMATE. THE CONTRACTOR SHALL HAVE ALL UTILITIES FIELD VERIFIED AND MARKED PRIOR TO CONSTRUCTION.
- CONTRACTOR SHALL MAINTAIN A MINIMUM 10'-0" HORIZONTAL AND 18" VERTICAL SEPARATION BETWEEN STORM SEWER AND WATER MAINS.
- ALL PROPOSED TOP OF CASTING ELEVATIONS ARE APPROXIMATE. THE CONTRACTOR SHALL ADJUST FINAL ELEVATIONS AS REQUIRED TO BE FLUSH WITH PAVEMENT.
- ALL STORM SEWER TRENCHES SHALL BE BACKFILLED WITH FULL DEPTH COMPACTED GRANULAR BACKFILL ("B" BORROW) UNDER OR WITHIN 5' OF EDGE OF PAVEMENT.
- THE CONTRACTOR SHALL VISIT THE SITE PRIOR TO BID TO BECOME FAMILIAR WITH ALL SITE CONDITIONS.
- THE CONTRACTOR SHALL PROVIDE THE REQUIRED MEANS FOR MAINTAINING SAFE TRAFFIC AT ALL TIMES.
- CONTRACTOR SHALL RESTORE ALL DISTURBED LAWN AREAS, STREETS, WALKS, DRIVES, ETC. AS SHOWN ON DRAWINGS, IN THE SPECIFICATIONS, OR TO AT LEAST PRE-EXISTING CONDITIONS.
- ALL UTILITY CROSSINGS SHALL BE PROTECTED AND SUPPORTED WITH GRANULAR FILL OR CONCRETE AS REQUIRED PER THE DETAIL SHEET.
- THE CONTRACTOR SHALL INCLUDE IN THE PRICE FOR EACH NEW CURB INLET THE REMOVAL AND REPLACEMENT OF AT LEAST 10' OF CONCRETE CURB AND GUTTER (5' EACH SIDE OF INLET) AS REQUIRED.
- THE CONTRACTOR SHALL SALVAGE ALL INLET AND MANHOLE CASTINGS REMOVED DURING CONSTRUCTION FOR THE OWNERS USE.
- ALL INLETS ARE TO INCLUDE RECONNECTION, ALL EXCAVATION, PIPE MATERIAL, ETC. REQUIRED TO COMPLETE ALL RESTORATION.

LEGEND:

•	TREE	1005	CONTOUR	---	UNDERGROUND ELECTRIC LINE
○	POWER POLE	X-X	FENCE	---	UNDERGROUND TELEPHONE LINE
○	GUY WIRE	MH	EXIST. SANITARY SEWER w/ MANHOLE	---	APPROX. RIGHT-OF-WAY
▽	FIRE HYDRANT	SC	NEW SANITARY SEWER w/ MANHOLE	---	APPROX. CORPORATE LIMITS
○ ^{MB}	MAILBOX	W	NEW SANITARY SERVICE CONNECTION	○W	APPROX. PROPERTY LINE
FP	FLAGPOLE	W	WATER LINE	■S	EXISTING WATER WELL
X 1085.2	SPOT SHOT	z-g	GAS LINE	W○	EXISTING SEPTIC TANK
					PROPOSED GRINDER PUMP VALVE VAULT



SCALE:
HORIZONTAL 1" = 50'
VERTICAL 1" = 5'

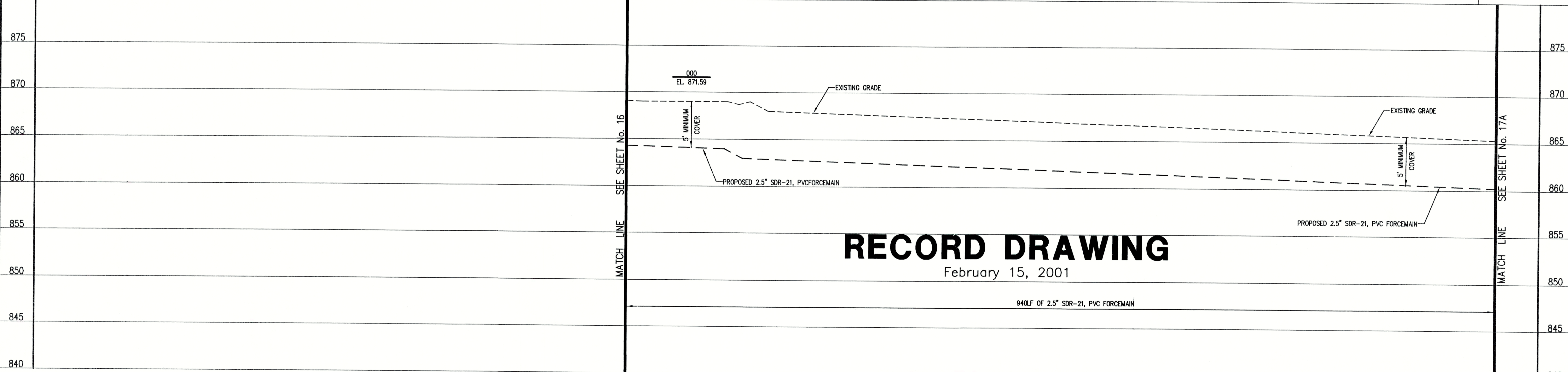

RECORD DRAWING
February 15, 2001

NOTE:
THE CONTRACTOR SHALL INCLUDE IN THE COSTS FOR STORM PIPE, ALL WATER SERVICE RECONNECTIONS, SANITARY SEWER SERVICE RECONNECTIONS, WATER MAIN RELOCATIONS, CONCRETE RECONSTRUCTION, AND SIDEWALK RECONSTRUCTION AS REQUIRED TO INSTALL NEW WORK AS SHOWN ON THE DRAWINGS.

NO.	DATE	DESCRIPTION	BY

TRIAD ASSOCIATES INC.
INDIANAPOLIS, INDIANA

APPROVED BY:
THOMAS M. SCHUBERT
REGISTERED PROFESSIONAL ENGINEER
No. 15614
STATE OF INDIANA

OLD STATE ROAD No. 132
FALL CREEK REGIONAL WASTE DISTRICT
PLAN AND PROFILE

DRAWN BY: DAP	DATE: 04/12/98	PROJECT No. 98008A	SHEET No. 17
DESIGNED BY: D.A. Pauling	CHECKED BY: James W. Frazell, P.E.		

19 OF