

# RECORD DRAWING

February 15, 2001

NOTE:  
ALL SDR-26 PVC WATERWORKS GRADE PIPE SHALL HAVE SDR-26 PVC TEES FOR SERVICE CONNECTIONS AND 6" SDR-26 PVC RUN TO RIGHT-OF-WAY.

NOTE:  
ADDITIONAL RIGHT-OF-WAY OR EASEMENTS MAY NEED TO BE ACQUIRED FOR INSTALLATION OF SEWER.



PER INDIANA STATE LAW IS-69-1991, IT IS AGAINST THE LAW TO EXCAVATE WITHOUT NOTIFYING THE UNDERGROUND LOCATION SERVICE TWO (2) WORKING DAYS BEFORE COMMENCING WORK.  
NOTE: CONTRACTOR TO VERIFY ALL UTILITY LOCATIONS PRIOR TO THE START OF CONSTRUCTION

7440 (1st Fl.)  
880.18  
(HAS BASEMENT)

7402 (1st Fl.)  
886.56  
(HAS BASEMENT)

- GENERAL NOTES:
- CONTRACTOR SHALL FIELD VERIFY ALL UTILITY LOCATIONS PRIOR TO CONSTRUCTION.
  - CONTRACTOR SHALL VISIT THE SITE PRIOR TO PLACING BID TO BECOME FAMILIAR WITH EXISTING CONDITIONS.
  - CONTRACTOR SHALL RESTORE ALL DISTURBED AREAS TO AT LEAST PRE-CONSTRUCTION CONDITIONS.
  - ALL PROPOSED MANHOLE CASTING ELEVATIONS SHOWN ARE APPROXIMATE AND FOR INFORMATION ONLY. THE CONTRACTOR IS RESPONSIBLE FOR CONSTRUCTING CASTINGS FLUSH WITH FINISH GRADE OR STREET GRADE. CASTINGS LOCATED IN DRAINAGE DITCHES SHALL BE SET HIGHER THAN INVERT OF DRAINAGE DITCH.
  - CONTRACTOR SHALL MAINTAIN A SEPARATION BETWEEN EXISTING WATER LINES AND SEWERS OF 18" VERTICALLY AND 10'-0" HORIZONTALLY. PRESSURE RATED SEWER PIPE AS SPECIFIED SHALL BE USED WHEN THIS SEPARATION CAN'T BE MAINTAINED.
  - FULL DEPTH COMPACTED GRANULAR FILL SHALL BE USED UNDER ALL PAVEMENT (I.E. DRIVES, WALKS, STREETS, ETC.) OR WHEN SEWER TRENCH IS WITHIN 3 FEET OF PAVEMENT. ALL PAVEMENT CROSSINGS REQUIRE SAW CUTTING.
  - CONTRACTOR SHALL PROVIDE EACH HOUSE OR BUSINESS IN THE SERVICE AREA WITH A 6-INCH PVC SDR-35 OR SDR-26 WATERWORKS GRADE SERVICE CONNECTION, TO THE RIGHT-OF-WAY LINE. THE CONTRACTOR SHALL COORDINATE THE SERVICE LOCATION WITH THE PROPERTY OWNER.
  - CONTRACTOR SHALL GRADE ALL DISTURBED AREAS TO ALLOW PROPER DRAINAGE AND PROVIDE SEED AND STRAW IN LAWN AREAS.
  - CONTRACTOR SHALL PROTECT OR REINSTALL ALL DISTURBED MAILBOXES.
  - CONTRACTOR SHALL BE RESPONSIBLE FOR PROTECTING AND/OR REPLACE EXISTING DRIVEWAY CULVERTS TO AT LEAST PRE-EXISTING CONDITION.

## LEGEND:

- EXISTING STORM DRAINAGE
- EXISTING TREE OR SHRUB
- PROPOSED SANITARY MANHOLE
- PROPOSED SANITARY SEWER
- EXISTING SIGN
- EXISTING MAILBOX
- APPROXIMATE RIGHT OF WAY LINE
- APPROXIMATE PROPERTY LINE
- PROPOSED PRESSURE LINE
- PROPOSED TERMINAL VALVE VAULT
- WATER LINE
- GAS LINE
- EXISTING UTILITY POLE W/GUY
- EXISTING UTILITY POLE
- WATER WELL
- EXISTING FENCE LINE
- EXISTING ELECTRIC TRANSFORMER
- PROPOSED GRINDER PUMP VALVE VAULT



SCALE  
HORIZONTAL SCALE - 1" = 50'  
VERTICAL SCALE - 1" = 5'

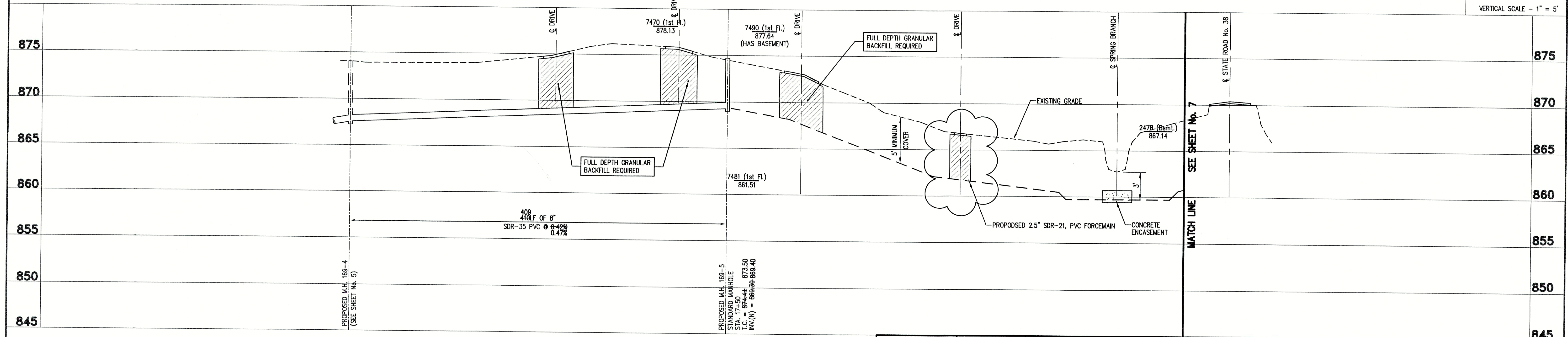

FILE NAME: 94025C3R-RD PLOT SCALE: 1=50 PLOT DATE: 12/6

NO.	DATE	DESCRIPTION	BY

**TRIAD ASSOCIATES INC.**  
INDIANAPOLIS, INDIANA

APPROVED BY:  
THOMAS M. SCHUBERT  
REGISTERED PROFESSIONAL ENGINEER  
No. 15614  
STATE OF INDIANA

HARSHMAN ROAD - ANN AVENUE FALL CREEK REGIONAL WASTE DISTRICT			
PLAN AND PROFILE			
DRAWN BY: DAP	DATE 04/12/98	PROJECT No. 98008A	SHEET No. 6
DESIGNED BY: D.A. Pauling		CHECKED BY: James W. Frazell, P.E.	
Thomas M. Schubert, P.E.		21	