

METHOD OF MARKING DETOUR

METHOD OF MARKING CONSTRUCTION UNDER TRAFFIC  
(FOR SINGLE LANE TWO-WAY TRAFFIC)

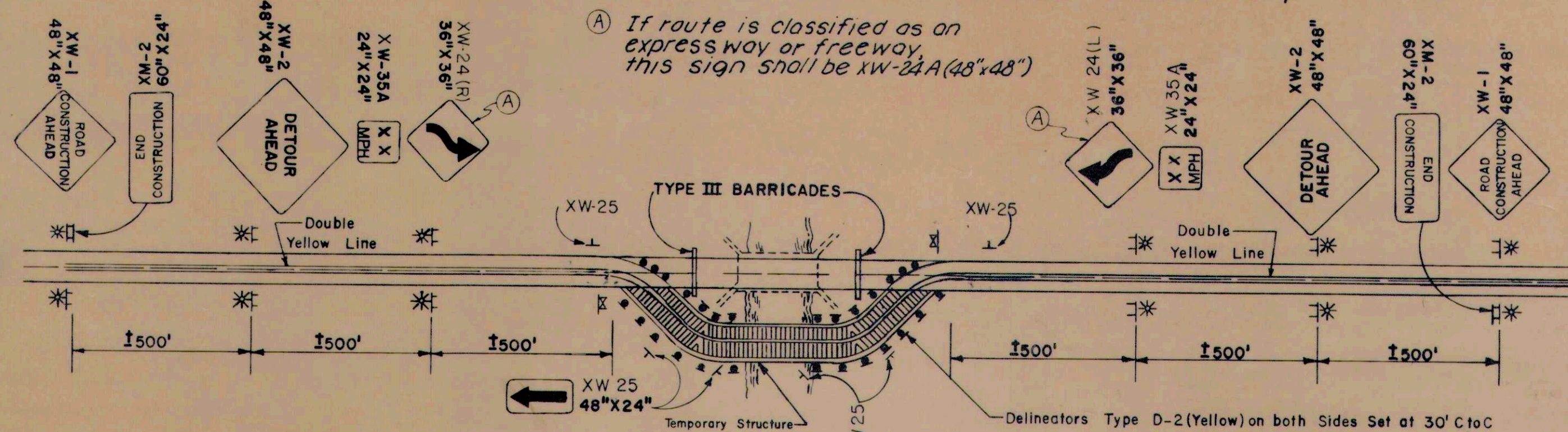

METHOD OF MARKING RUN-AROUND

NOTE:

- APPROVED LIGHTS SHALL MARK BARRICADES, DRUMS AND SIGNS CONTINUOUSLY AT NIGHT; EXCEPT FOR HIGH INTENSITY FLASHING LIGHTS WHICH SHALL OPERATE CONTINUOUSLY OVER A 24-HOUR PERIOD.
- ALL SIGNS SHALL BE MOUNTED IN SUCH A MANNER THAT THE VERTICAL DISTANCE BETWEEN THE BOTTOM OF THE SIGN AND THE EDGE OF THE PAVEMENT SHALL BE NOT LESS THAN 5 FEET AND THE HORIZONTAL DISTANCE FROM THE PAVEMENT EDGE TO THE EDGE OF SIGN SHALL NOT BE LESS THAN 12 FEET (R/W PERMITTING) OR 6 FEET FROM THE EDGE OF A PAVED SHOULDER.
- IN CURBED AREAS ALL SIGNS SHALL BE MOUNTED IN SUCH A MANNER THAT THE VERTICAL DISTANCE BETWEEN THE BOTTOM OF THE SIGN AND THE EDGE OF THE PAVEMENT SHALL BE NOT LESS THAN 7 FEET AND THE HORIZONTAL DISTANCE FROM THE EDGE OF PAVEMENT TO THE EDGE OF SIGN SHALL NOT BE LESS THAN 2 FEET.
- SIGNS AND BARRICADES ARE TO BE PROVIDED AND MAINTAINED BY THE CONTRACTOR AT SUCH POINTS AS MAY BE DESIGNATED ON THE PLANS OR BY THE ENGINEER.
- THE INDIANA STATE HIGHWAY COMMISSION WILL DESIGNATE THE DETOUR ROUTE AND WILL ERECT AND MAINTAIN DIRECTION SIGNS AROUND THE DETOUR. IF TRAFFIC IS DETOURED IN ADVANCE OF THE FIRST TYPE III BARRICADE, THE INDIANA STATE HIGHWAY COMMISSION SHALL PLACE THE SIGNS, AS SHOWN, IN ADVANCE OF THE MARKED DETOUR.
- FOR TEMPORARY LANE CLOSURE DURING DAYLIGHT HOURS CONES MAY BE USED IN LIEU OF BARRELS OR TYPE I OR II BARRICADES. THE CONES SHALL BE A MINIMUM OF 29 INCHES IN HEIGHT WITH BALLAST IN THE BOTTOM OR OTHER APPROVED DEVICE TO PREVENT TIPPING.
- SIGNS ARE TO BE MOUNTED ON TYPICAL SIGN STANDARDS OR ON POSTS AS INDICATED ON DETOUR SHEET No. 5. and 5A
- ALL DRUMS AND BARRICADES ARE TO BE REFLECTORIZED BY USING REFLECTIVE SHEETING, AS SPECIFIED IN THE CURRENT "INDIANA STATE HIGHWAY STANDARD SPECIFICATIONS." THE ORANGE SHALL BE ENCAPSULATED LENS(HIGH INTENSITY) REFLECTIVE SHEETING AND THE WHITE SHALL BE ENCLOSED LENS REFLECTIVE SHEETING (ENGINEER GRADE)
- BARRICADE TYPE V SHALL NOT BE PAID FOR WHEN USED IN CONJUNCTION WITH BARRICADE TYPE III, BUT SHALL BE INCLUDED IN THE COST OF THE BARRICADE.
- TWO TYPE II HIGH INTENSITY YELLOW FLASHING WARNING LIGHTS SHALL BE MOUNTED ABOVE THE "ROAD CLOSED" SIGN

LEGEND

- Type III Barricade
- Drum or Barricades Type I or II with Steady Burning Light (Type "C")
- Delineator Type D-2 (Yellow)
- Low Intensity Flashing Yellow Light (Type "A")
- Drum or Barricades Type I or II with Low Intensity Flashing Yellow Light (Type "A")
- Barricade Type V - With Two High Intensity Flashing Yellow Lights (Type "B") - see "STANDARD DETOUR" Sheet No. 2A
- Flagman

REVISIONS	
DATE	REMARKS
10-28-75	NOTES NO. 6 AND 7
3-1-76	LEGEND
6-1-76	NEW M.U.T.C.D.
7-1-76	NEW M.U.T.C.D.
12-1-76	XR-2 SIGN
4-1-77	NOTE 7
5-1-78	NOTE 6
8-1-79	NOTE 4

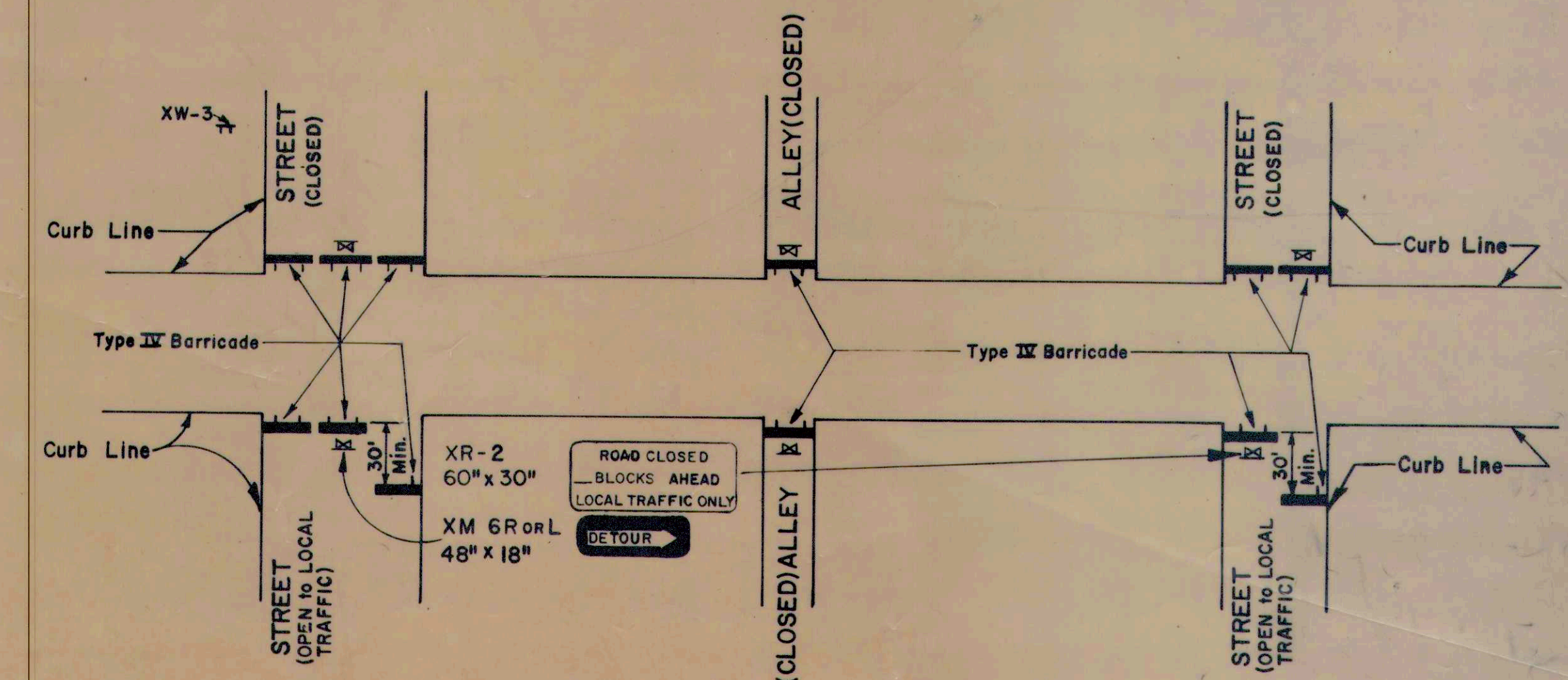

METHOD OF MARKING DETOUR  
- URBAN -

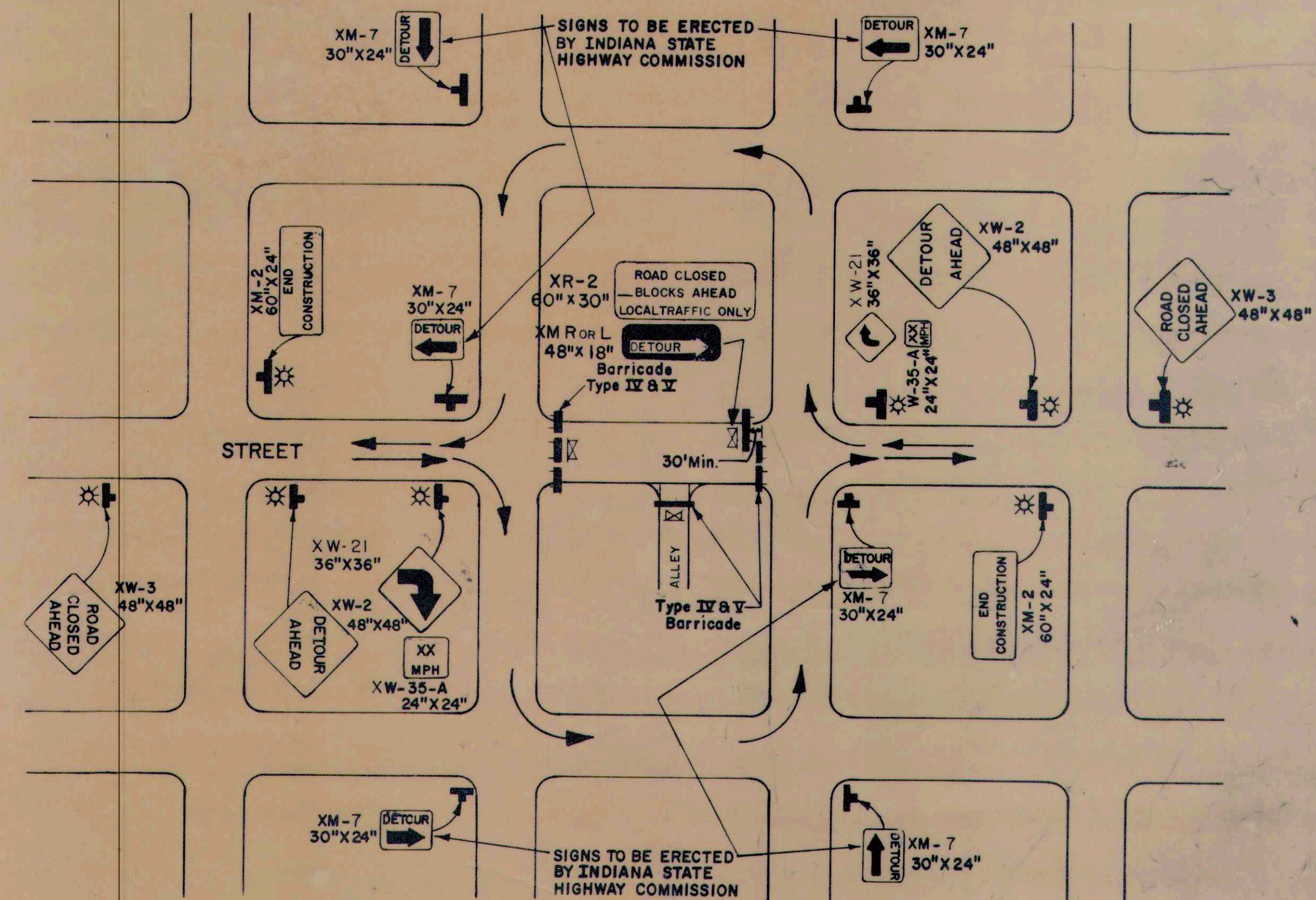

STANDARD  
DETOUR SIGNS  
STATE OF INDIANA  
NOVEMBER 1974

RECOMMENDED FOR APPROVAL  
ENGINEER OF TRAFFIC DESIGN & CONSTRUCTION  
APPROVED  
CHIEF, DIVISION OF TRAFFIC  
APPROVED  
CHIEF, HIGHWAY ENGINEER

RECORD DRAWING

REVISIONS	
DATE	COMMENTS
5-1-80	CONC. SIZE (NOTE 6)

SHEET  
2  
DETOURS